

REPLACEMENT PARTS
FOR
TRIUMPH
MOTOR CYCLES
1947 & 1948
MODELS

SPEED TWIN : TIGER 100
3T. DE-LUXE

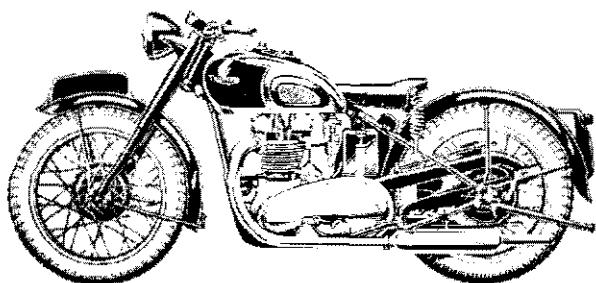

TRIUMPH ENGINEERING COMPANY LTD.
MERIDEN WORKS, ALLESLEY, COVENTRY.

Telegrams (for Spares)
"Trusey, Coventry"

Telephone
Meriden 331

PREFACE

BEFORE ordering parts for your machine, please read very carefully the instructions contained in the next paragraph. In a large number of cases, the information given in orders is not sufficient to enable us to identify customers' requirements with certainty. Delay is frequently occasioned by our having to refer the order back for further particulars before we can supply.

HOW TO ORDER. Every part is indicated by number, and this should be quoted together with the description. In order to assist customers, dimensions have been given in many cases where parts are similar. Parts where possible have been listed in order of assembly and a number of the illustrations show the assembly order also. With these aids, there should be no difficulty in identifying the parts you require. Always head your order with the engine number, stamped on the drive side of the crank case underneath the cylinder flange, together with the prefix letters. Use a separate sheet for your order if you are sending a letter as well.

SPECIMEN ORDER

12/2/48

To Triumph Engineering Co. Ltd.,
Meriden Works,
Allesley,
Coventry.

Engine No. 48-5T-19463

Please supply :—

1 - CP.29.5 - Piston Assy. + .005"
1 - EI480 - Guide, inlet valve

* Send C.O.D.

Wm. Smith,
1a, Ewell Avenue
Ewell, Surrey.

**For terms of business see page 3.*

TELEGRAPHIC ORDERS. Orders by telegram should be addressed to "Trusty 60221 Coventry". They are then telephoned to us, which prevents delay in delivery. It is only necessary to quote part numbers in telegraphic orders, the description can be omitted.

PATTERNS AND PARTS FOR REPAIR. It is not necessary to send patterns if the part number is quoted. The sending of patterns often delays the order as parcel post or rail takes longer than letter post.

Parts sent to Coventry for repair, replacement or as patterns should bear the sender's name and address and clear instructions should accompany the parts. All parts must be forwarded carriage paid and care should be taken to ensure that all remittances are sent separately and not enclosed with the parts. Fragile units such as cylinders, etc., should always be boxed to avoid damage in transit. Complete machines should have all fittings such as horns, driving mirrors, tools, etc., removed by the sender before despatch, as it is impossible for us to accept responsibility in the event of loss in transit. We are always pleased to give estimates for overhauling and repairs, but should an estimate not be accepted, a charge will be made covering cost of dismantling and re-assembling, if carried out.

Accessories not of our manufacture should be sent direct to the actual makers, whose names appear on the goods in question. In the event of any doubt in this direction, we shall be pleased to supply the necessary information by return of post. All communications relating to spare parts, repairs, replacements and general service should be addressed to the Triumph Engineering Co. Ltd., Meriden Works, Allesley, Coventry, and in order to facilitate quick reference, the quoting of any order number, invoice number or reference from previous communications is of essential importance.

WHERE TO OBTAIN. Triumph Spare Parts may be obtained from any Triumph Dealer in Great Britain and Northern Ireland and we recommend our customers to place their orders with the Triumph Dealer in their district. When parts not usually asked for are required, and for which the Dealer may have to wire or obtain specially, the postage or carriage incurred becomes payable.

We are not able to supply Transfers as originally affixed to Triumph Motor Cycles, but we are at all times willing to supply a transfer denoting that the machine is of genuine Triumph manufacture, provided the Frame and Engine prefix letters and numbers are quoted.

Customers are warned against the risk incurred by purchasing parts that are not of genuine Triumph manufacture. This risk is eliminated if parts are ordered as instructed, either from our recognised Dealers, or direct from the Service Department, Meriden Works, Allesley, Coventry.

TERMS OF BUSINESS

THE most convenient method of paying for Spare Parts is by the C.O.D. system. By this method you pay the postman for the goods when he delivers them to you. As the minimum C.O.D. collection fee is 10d., only goods to the value of 2/- and over can be sent by this system. We do not despatch goods by rail C.O.D.

Where goods are not sent C.O.D., cash must accompany the order. All remittances should be made payable to the Triumph Engineering Co. Ltd., and crossed "Barclay's Bank Ltd." if in the form of Postal Order or cheque. Letters containing currency notes must be registered.

Should a remittance be forwarded by telegraphic money order, the name and address of the sender must be inserted in the space provided on the Post Office requisition form for a private message from remitter to payee. Unless this is complied with the Post Office omit such information from the telegram and we are not then in a position to trace the sender.

Postage, carriage and packing is charged at 5% on the value of the goods, minimum charge 6d. Packing boxes, cases, crates, etc., are charged for at cost and are returnable.

INDEX

	Page No.
BATTERY CARRIER GROUP	42
CARBURETTOR GROUP	72
CARTON PACK COMPONENT LIST	7
CHAIN GROUP	60
CHAINGUARD GROUP	60
CLOSE RATIO GEAR GROUP	36
CONTROL CABLE GROUP	67
Clutch cable	67
Front brake cable	67
Throttle cable	67
ENGINE GROUP	12
Connecting rods	23
Crankcase	22
Crankcase bearings	23
Crankcase breather	26
Crankcase studs and bolts	23
Crankshaft and flywheel assembly	22
Cylinder block	12
Cylinder head	12
Engine sprocket and shock absorber	27
Oil pump	23
Overhead rocker	26
Pistons	13
Push rods	26
Push rod cover tube	26
Release valve	24
Tappets	26
Timing cover	25
Timing gear	26
Valves	13
ENGINE PLATE GROUP	42
EXHAUST SYSTEM GROUP	28
FOOTREST GROUP	68
FRAME GROUP	37
FRONT FORK GROUP	44
Steering cups, cones and balls	45
Steering damper	45
FRONT WHEEL GROUP	48
Front wheel brake	50
GASKET SETS	84
GEAR RATIOS	84

	Page No.
GEARBOX GROUP	29
Clutch control	35
Gear control (enclosed mechanism)	31
Gear control (selector mechanism)	31
Gearbox casing	29
Gearbox clutch	35
Gearbox fittings	29
Gearbox shell bearings	31
Gearbox sprocket	35
Kickstarter	35
Shafts and gears	29
Wide ratio gears	36
Close ratio gears	67
HANDLEBAR GROUP	65
Clutch control	65
Front brake control	65
Handlebar	65
Throttle control	65
LUCAS ELECTRICAL EQUIPMENT GROUP	80
MAGNETO B.T.H. GROUP	74
MUDGUARD GROUP	56
Front mudguard	56
Rear mudguard (1st condition)	56
Rear mudguard (2nd condition)... ..	59
NUMBER PLATE GROUP	59
PILLION SEAT GROUP	69
PRIMARY CHAIN GROUP	60
PROP STAND GROUP	69
REAR BRAKE CONTROL GROUP	67
REAR CARRIER GROUP	69
REAR SPRING WHEEL GROUP	52
Rear spring wheel brake	53
REAR WHEEL GROUP	50
Rear wheel brake	52
SADDLE GROUP... ..	68
SIDECAR ATTACHMENTS GROUP	69
SPARKING PLUG GROUP	71
SPEEDOMETER GROUP	71
STAND GROUP	45
TANK GROUP	63
Petrol tank	63
Oil tank	64
TOOLBOX GROUP	70
TOOLKIT GROUP	70
WIDE RATIO GEAR GROUP	36

ILLUSTRATION INDEX

	<i>Page</i>
B.T.H. magneto armature and condenser	77
B.T.H. magneto contact breaker and housing	78
B.T.H. magneto housing and auto advance	76
Carburettor parts	73
Crankcase and frame studs, bolts and washers	43
Engine 3T (1st condition) :	
Crankcase, cylinder block and cylinder head, etc.	18
Engine 3T (2nd condition) :	
Crankcase, cylinder block and cylinder head, etc.	20
Engine 3T	
Crankshaft, connecting rods, pistons, timing gears, etc.	24
Engine 5T and T100 :	
Crankcase, cylinder block and cylinder head, etc.	14
Engine 5T and T100 :	
Crankshaft, connecting rods, pistons, timing gears, etc.	16
Frame and components, 3T	40
Frame and components, 5T and T100	38
Front and rear chaincases	61
Front wheel and mudguard arrangement	49
Gearbox casing and levers	30
Gears and clutch	32
Handlebars and controls	66
Headlamp (2nd condition)	82
Petrol and oil tanks with fittings	62
Rear mudguard, number plate (1st condition)	57
Rear mudguard, number plate (2nd condition)	58
Rigid rear wheel bearing assembly	51
Spring wheel	54
Telescopic front forks	46

To assist the owner and dealer in identifying requirements, this book contains numerous exploded views of major assemblies. Each component part is numbered and by cross reference to the illustration index, the part number of the component will be found. Against each part number a page and reference number is shown and by referring to the appropriate page, the full description of the part will be found against the reference number.

Example.

- To find the part number of a scraper ring for the model 5T.
1. Refer to illustration index page where it will be found that the exploded view of the 5T engine is on page 16.
 2. Note that the number of the scraper ring on the illustration is 2.
 3. Refer to the index for the illustration in question on page 17.
 4. Note that No. 2 is part number GE.29, listed on page 17. Reference line No. 13.

CARTON PACK COMPONENT LIST.

The following sub-assemblies are supplied in carton packs under the CP part number stated. The contents of these carton packs are preserved and will not deteriorate under adverse conditions.

<i>Part Number</i>			<i>Description and Contents</i>
Brake Lining			
CP.38	2	NW.243	Lining, brake
	16	W.129	Rivet
CP.66	2	W.631	Lining, brake
	16	W.129	Rivets
Carburettor Air Filter (5T only)			
CP.64	1	34/001CT.	Filter, air
	1	15/026	Elbow
	1	15/1941	Elbow
Crankcase Bearing			
CP.10	1	E.1591	Bearing
	1	E.1592	Bearing
Fork (Telescopic) Service Pack			
CP.50	2	H.443	Bearing, lower
	2	H.441	Bearing, upper
	2	E.1335	Washer, copper
	2	H.430	Washer, drain plug
	2	H.452	Restrictor, oil
	2	H.453	Cup, oil restrictor
	2	H.454	Pin, restrictor cup
	2	H.391	Washer, dust excluder felt
	2	H.420	Washer, outer cover felt
Gears, Wide Ratio			
CP.48	1	T.465	Gear, mainshaft high
	1	T.466	Gear, mainshaft second
	1	T.467	Gear, layshaft high
	1	T.468	Gear, layshaft second
Gears, Close Ratio			
CP.51	1	T.513C	Gear, mainshaft high
	1	T.509C	Gear, mainshaft second
	1	T.511C	Gear, mainshaft third
	1	T.515C	Gear, mainshaft and low
	1	T.512C	Gear, layshaft high
	1	T.514C	Gear, layshaft second
	1	T.508C	Gear, layshaft third
	1	T.510C	Gear, layshaft low

SEE SPECIMEN ORDER IN PREFACE

<i>Part Number</i>			<i>Description and Contents</i>
Kickstarter Ratchet Gear			
CP.27	1	T.730	Pinion, kickstarter
	1	T.731	Ratchet, kickstart
	1	T.488/28	Spring and sleeve
Piston			
CP.29	1	E.1563	Piston
	2	E.656	Ring, compression
	1	GE.29	Ring, scraper
	1	WE.203E	Pin, gudgeon
	2	WE.479	Circlip
CP.29/5	1	E.1563/5	Piston +.005 in.
	2	E.656/5	Ring, compression
	1	GE.29/5	Ring, scraper
	1	WE.203E	Pin, gudgeon
	2	WE.479	Circlip
CP.29/10	1	E.1563/10	Piston +.010 inch
	2	E.656/10	Ring, compression
	1	GE.29/10	Ring, scraper
	1	WE.203E	Pin, gudgeon
	2	WE.479	Circlip
CP.29/20	1	E.1563/20	Piston +.020 inch
	2	E.656/20	Ring, compression
	1	GE.29/20	Ring, scraper
	1	WE.203E	Pin, gudgeon
	2	WE.479	Circlip
CP.30	1	E.1908	Piston
	2	E.656	Ring, compression
	1	GE.29	Ring, scraper
	1	WE.203E	Pin, gudgeon
	2	WE.479	Circlip
CP.30/5	1	E.1908/5	Piston +.005 inch
	2	E.656/5	Ring, compression
	1	GE.29/5	Ring, scraper
	1	WE.203E	Pin, gudgeon
	2	WE.479	Circlip
CP.30/10	1	E.1908/10	Piston +.010 inch
	2	E.656/10	Ring, compression
	1	GE.29/10	Ring, scraper
	1	WE.203E	Pin, gudgeon
	2	WE.479	Circlip

TREASURY NOTES MUST BE REGISTERED

<i>Part Number</i>			<i>Description and Contents</i>
CP.30/20	1	E.1908/20	Piston +.020 inch
	2	E.656/20	Ring, compression
	1	GE.29/20	Ring, scraper
	1	WE.203E	Pin, gudgeon
	2	WE.479	Circlip
CP.49	1	E.1748	Piston
	2	E.1766	Ring, compression
	1	E.1819	Ring, scraper
	1	E.1750	Pin, gudgeon
	2	E.1767	Circlip
CP.49/5	1	E.1748/5	Piston
	2	E.1766/5	Ring, compression
	1	E.1819/5	Ring, scraper
	1	E.1750	Pin, gudgeon
	2	E.1767	Circlip
CP.49/10	1	E.1748/10	Piston +.010 inch
	2	E.1766/10	Ring, compression
	1	E.1819/10	Ring, scraper
	1	E.1750	Pin, gudgeon
	2	E.1767	Circlip
CP.49/20	1	E.1748/20	Piston +.020 inch
	2	E.1766/20	Ring, compression
	1	E.1819/20	Ring, scraper
	1	E.1750	Pin, gudgeon
	2	E.1767	Circlip
CP.43	1	E.1841	Piston
	2	E.1766	Ring, compression
	1	E.1819	Ring, scraper
	1	E.1750	Pin, gudgeon
	2	E.1767	Circlip
CP.43/5	1	E.1841/5	Piston +.005 inch
	2	E.1766/5	Ring, compression
	1	E.1819/5	Ring, scraper
	1	E.1750	Pin, gudgeon
	2	E.1767	Circlip
CP.43/10	1	E.1841/10	Piston +.010 inch
	2	E.1766/10	Ring, compression
	1	E.1819/10	Ring, scraper
	1	E.1750	Pin, gudgeon
	2	E.1767	Circlip
CP.43/20	1	E.1841/20	Piston +.020 inch
	2	E.1766/20	Ring, compression
	1	E.1819/20	Ring, scraper
	1	E.1750	Pin, gudgeon
	2	E.1767	Circlip

CP.61 †	1	E.2460	Piston
	2	E.656	Ring, compression
	1	GE.29	Ring, scraper
	1	WE.203E	Pin, gudgeon
	2	WE.479	Circlip

Piston Rings

CP.40	4	E.656	Ring, compression
	2	GE.29	Ring, scraper
CP.40/5	4	E.656/5	Ring, compression
	2	GE.29/5	Ring, scraper
CP.40/10	4	E.656/10	Ring, compression
	2	GE.29/5	Ring, scraper
CP.40/20	4	E.656/20	Ring, compression
	2	GE.29/5	Ring, scraper
CP.41	2	E.656	Ring, compression
	1	GE.29	Ring, scraper
CP.41/20	2	E.656/20	Ring, compression
	1	GE.29/20	Ring, scraper
CP.55	4	E.1766	Ring, compression
	2	E.1819	Ring, scraper
CP.55/5	4	E.1766/5	Ring, compression
	2	E.1819/5	Ring, scraper
CP.55/10	4	E.1766/10	Ring, compression
	2	E.1819/10	Ring, scraper
CP.55/20	4	E.1766/20	Ring, compression
	2	E.1819/20	Ring, scraper

Rear Wheel Spring Set

CP.67	1	W837	Spring, inner main
	1	W836	Spring, outer main
	1	W838	Spring, rebound
	1	W664	Locator plate

Sidecar Connections

CP.14	1	F.2587	Connection, front
	1	F.2600	Bolt
	2	F.1746	Nut, sleeved
	1	F.2601	Connection, rear
	2	F.1743	Stud
	2	SI-5	Nut
	2	KF.365	Washer, spring
	1	F.1747	Nut

† (Special for racing—8.25 : 1 compression ratio).

QUOTE ENGINE NUMBER AND PREFIX LETTERS

Steering Races

CP.56	2	XS.10	Cup
	1	H.433	Cone
	1	XS.8	Cone
	44	S70-4	Ball

CP.57	1	H.437	Cup
	1	H.111	Cup
	1	H.438	Cone
	1	H.439	Cone
	22	S70-4	Ball
	20	S70-3	Ball

Valves

CP.6	2	E.1955	Valve Inlet
	2	E.1956	Valve Exhaust

CP.53	2	E.1751	Valve Inlet
	2	E.1752	Valve Exhaust

Valve Guides

CP.28	2	E.1480	Guide Inlet
	2	E.1604	Guide Exhaust

CP.54	4	E.1759	Guide Inlet and Exhaust
-------	---	--------	-------------------------

Valve Springs

CP.5	4	E.1488	Spring, inner
	4	E.1487	Spring, outer

CP.52	4	E.1777	Spring, inner
	4	E.1778	Spring, outer

SEE SPECIMEN ORDER IN PREFACE

REPLACEMENT PARTS

ENGINE GROUP

REF. No.	PART No.	DESCRIPTION	3T	5T	T100
CYLINDER BLOCK					
1	E2257	Block, cylinder	—	1	1
2	*E1740	" "	1	—	—
3	*E2461	" "	1	—	—
4	E2249	Washer, cylinder base	—	1	1
5	E1775	" " " for E1740	1	—	—
6	E2677	" " " " E2641	1	—	—
CYLINDER HEAD					
7	E2258	Head, cylinder with guides	—	1	—
8	E2258A	" " " "	—	—	1
9	*E2645	" " " "	1	—	—
10	E2248	Gasket, cylinder head	—	1	1
11	E1776	" " " (use with E1740 cylinder block)	2	—	—
12	E2614	" " " (use with E2641 cylinder block)	1	—	—
13	E327	Bolt " " short	—	4	4
14	E1484	" " " long (rear)	—	2	2
15	E1596	" " " long (front)	—	2	2
16	E1795	" " " long	4	—	—
17	E1796	" " " short (see below)	4	—	—
18	E2631	" " " (" ")	2	—	—
19	E2632	" " " (" ")	2	—	—
20	GS308	Washer, cylinder head bolt	8	4	4
21	E1675	Manifold, inlet	—	—	1
22	E1456	" " " " " " " "	—	1	—
23	E1552	" joint washer	—	2	—
24	E1676	" " " " " " " "	—	—	2
25	E1715	Stud, inlet manifold fixing	—	—	4
26	E1554	" " " " " " " "	—	4	—
27	W103	Nut, inlet manifold stud	—	4	4
28	S2S-13	Washer, inlet manifold stud	—	4	4

*Cylinder head part number E2645 is used on machines from engine No. 89333. Holding down bolts E1796 are superseded by E2631 and E2632 in conjunction with the above part. All machines with the prefix 48—3T before the engine number have the cylinder block E2461 attached to the crankcase by studs and nuts. Refer to illustrations on pages 18 and 20 as an aid when ordering.

ALL GOODS SENT TO THE WORKS MUST BE CARRIAGE PAID

REF. No.	PART No.	DESCRIPTION	3T	5T	T100
1	E1553	Stud, carburettor fixing	—	2	2
2	E1396	" " "	2	—	—
3	S1-51	Nut, carburettor stud	2	2	2
4	S25-3	Washer, carburettor stud	2	2	2
5	E1987	Stud, rocker cap inspection	2	—	—
6	E1912	Nut, " " stud	2	—	—

VALVES

7	E1955	Valve, inlet	—	2	2
8	E1751	" " "	2	—	—
9	E1956	" exhaust	—	2	2
10	E1752	" " "	2	—	—
11	E1480	Guide, inlet valve	—	2	2
12	E1604	" exhaust valve	—	2	2
13	E1759	" valve, inlet and exhaust	4	—	—
14	E1488	Spring, valve inner	—	4	4
15	E1777	" " "	4	—	—
16	E1487	" " outer	—	4	4
17	E1778	" " "	4	—	—
18	E1543	Collar, valve spring (top)	—	4	4
19	E1757	" " " "	4	—	—
20	E1544	Cup, " " (bottom)	—	4	4
21	E1758	" " " "	4	—	—
22	WE259A	Cotter, valve split	8	8	8

PISTONS

23	E1563	Piston body, standard compression ratio 7 : 1	—	2	—
24	E1563/5	" " +.005"	—	2	—
25	E1563/10	" " +.010"	—	2	—
26	E1563/20	" " +.020"	—	2	—
27	E1908	" " standard " " 7.8 : 1	—	—	2
28	E1908/5	" " +.005"	—	—	2
29	E1908/10	" " +.010"	—	—	2
30	E1908/20	" " +.020"	—	—	2
31	E2460	" " standard " " 8.25 : 1	—	—	2
32	E1748	" " " " 6.3 : 1	2	—	—
33	E1748/5	" " +.005"	2	—	—
34	E1748/10	" " +.010"	2	—	—
35	E1748/20	" " +.020"	2	—	—

SEE PAGES 7-11 FOR CARTON PACKS

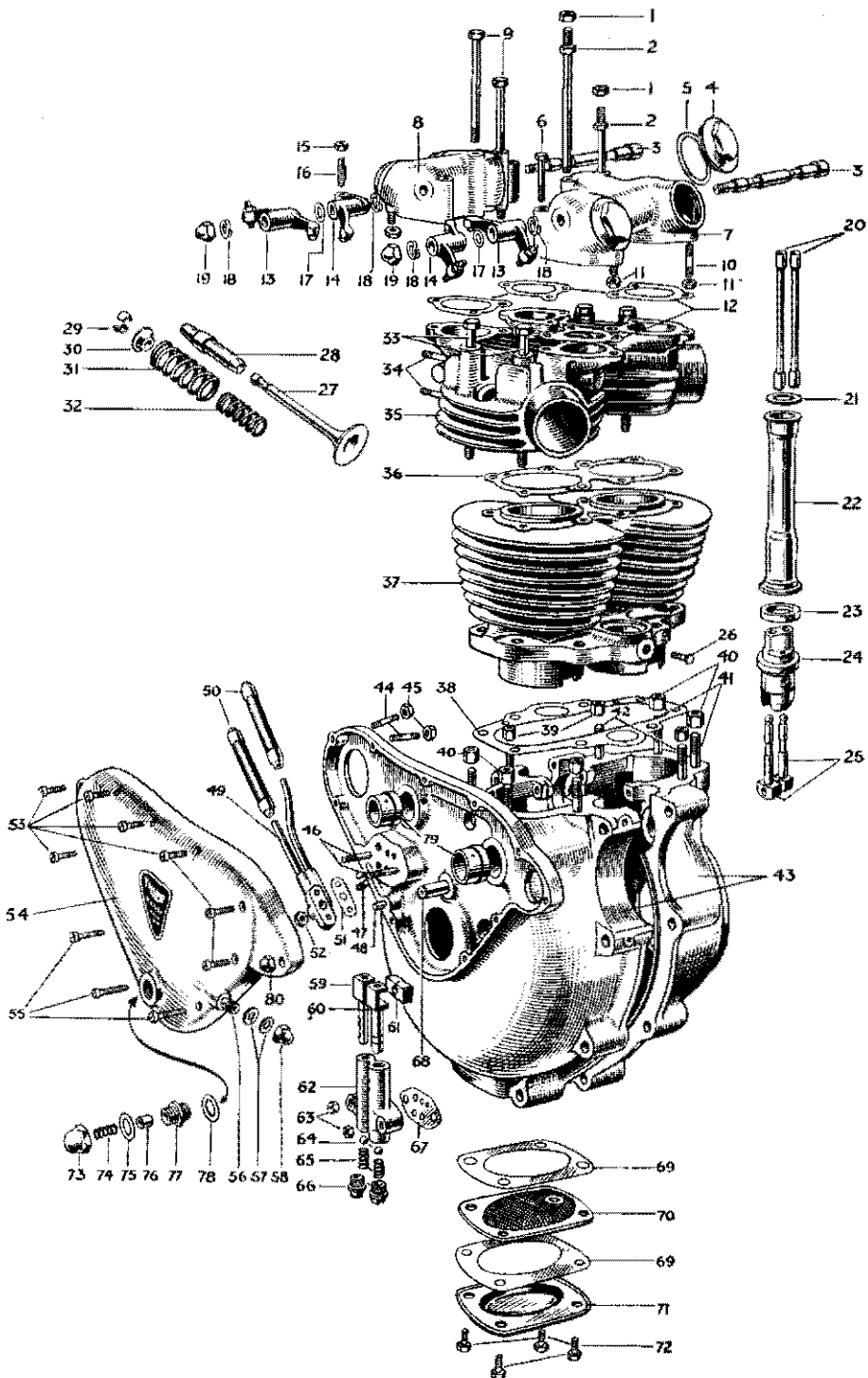

ENGINE 5T AND T100—CRANKCASE, CYLINDER BLOCK AND CYLINDER HEAD, ETC.

INDEX TO ILLUSTRATION ON PAGE 14

Illust. No.	Part No.	Page	Ref.	Illust. No.	Part No.	Page	Ref.
1	S1-52	37	20	40	PO.172.A	22	23
2	E.1596	12	15	41	E.672	22	17
3	E.1512	27	20	42	E.1614	22	18
4	E.1564	26	44	43	E.2219/20.A	22	15
5	E.1577	27	3	44	E.2022	22	26
6	E.1545	27	7	45	F.1008	22	27
7	E.1462	26	39/40	46	E.1536	22	36
8	E.1461	26	37/38	47	E.1539	22	29
9	E.1484	12	14	48	E.1532	22	30
10	E.1540	26	42	49	E.1958	64	35
11	F.879	26	43		E.1526	64	36
12	E.1650	26	41	50	MF.119	64	41
13	E.1458	27	12	51	E.1529	64	38
14	E.1457	27	10	52	S1-51	64	39
15	E.470	27	15	53	E.427	25	13
16	E.1513	27	14	54	E.2218	25	2
17	E.1575	27	17	55	E.1049	25	11
18	E.1574	27	18	56	E.1586	25	4
19	E.1435	27	21	57	E.1335	25	6
20	E.1693	26	30	58	E.1435	25	5
21	E.1497	26	36	59	E.1475	23	28
22	E.2273	26	32/33	60	E.1476	23	29
23	E.1496	26	34	61	E.495	23	30
24	E.1477	26	25	62	E.1470	23	27
25	E.1478	26	24	63	F.879	22	37
26	H.200	26	27	64	S70-7	23	32
27	E.1955 (IN)	13	7	65	E.403	23	31
	E.1956 (EX)	13	9	66	E.386	23	33
28	E.1480 (IN)	13	11	67	E.1537	23	34
	E.1604 (EX)	13	12	68	E.375	26	16
29	WE.259.A	13	22	69	E.487	22	41
30	E.1543	13	18	70	E.529	22	39
31	E.1487	13	16	71	E.486	22	40
32	E.1488	13	14	72	MT.63	22	42
33	E.327	12	13	73	E.2304 -	24	6
34	E.1715	12	25	74	GS.250 -	24	4
	E.1554	12	26	75	GS.254 -	24	7
35	E.2258	12	7	76	GS.251 -	24	3
	E.2258.A	12	8	77	GS.248 -	24	2
36	E.2248	12	10	78	E.1670 -	24	5
37	E.2257	12	1	79	E.1479	23	16
38	E.2249	12	4	80	E.2228	80	23
39	W.76	22	22				

FOR IDENTIFICATION OF PART SEE PAGE 6 FOR INSTRUCTIONS

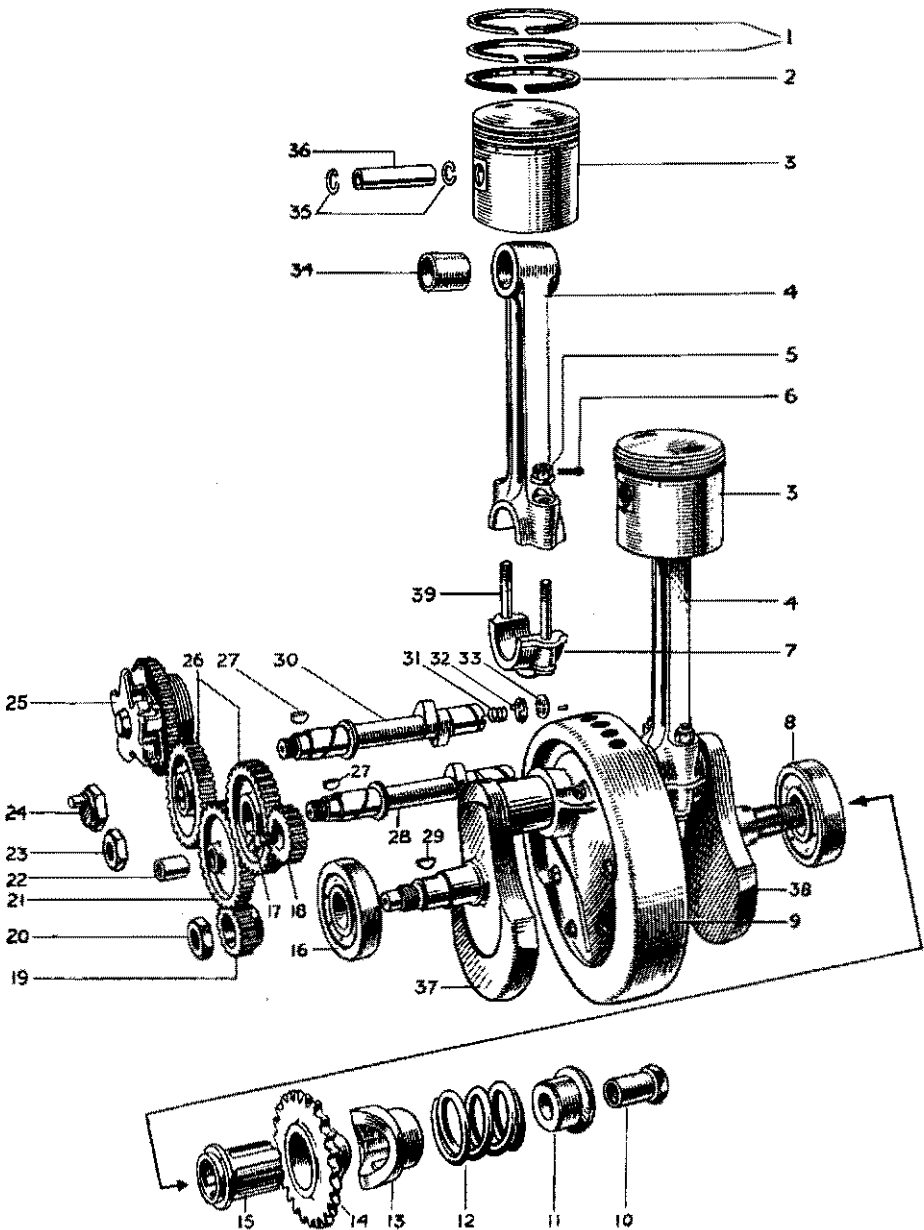

ENGINE 5T AND T100—CRANKSHAFT, CONNECTING RODS, PISTONS, TIMING GEARS, ETC.



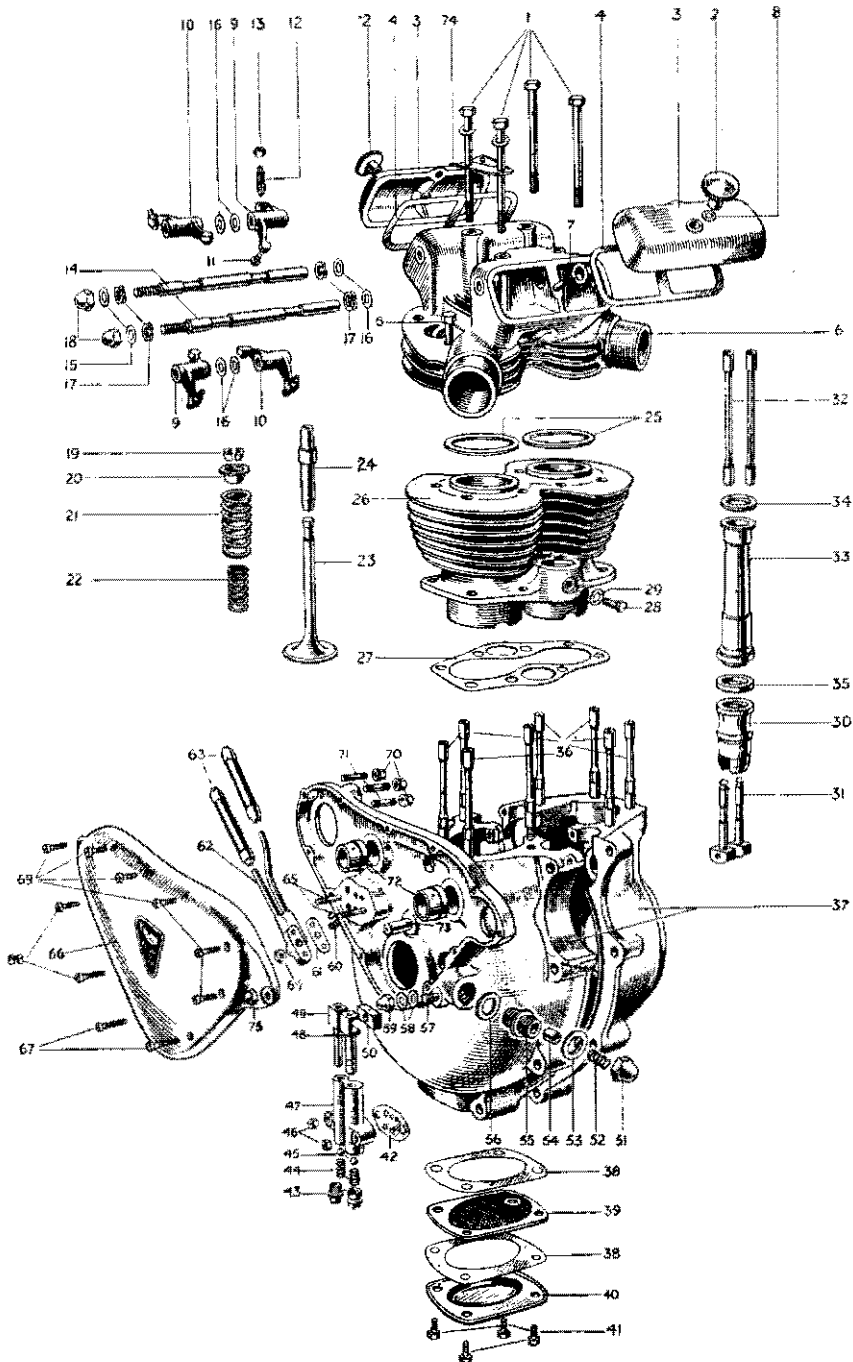

**1st CONDITION
ENGINE 3T—CRANKCASE, CYLINDER BLOCK AND CYLINDER
HEAD, ETC.**

INDEX TO ILLUSTRATION ON PAGE 18

Illust. No.	Part No.	Page	Ref.	Illust. No.	Part No.	Page	Ref.
1	E.1795	12	16	38	E.487	22	41
2	E.1912	27	5	39	E.529	22	39
3	E.1779	27	1	40	E.486	22	40
4	E.1780	27	4	41	MT.63	22	42
5	E.1796	12	17	42	E.1537	23	34
6	E.2645	12	9	43	E.386	23	33
7	E.1987	13	5	44	E.403	23	31
8	PT.104.B	27	6	45	S70-7	23	32
9	E.1755	27	9	46	F.879	22	37
10	E.1756	27	11	47	E.1470	23	27
11	E.1483	27	13	48	E.1476	23	29
12	E.1513	27	14	49	E.1475	23	28
13	E.470	27	15	50	E.495	23	30
14	E.1813	27	19	51	E.2304	24	6
15	E.1330	27	16	52	GS.250	24	4
16	E.1575	27	17	53	GS.254	24	7
17	E.1574	27	18	54	GS.251	24	3
18	E.1435	27	21	55	GS.248	24	2
19	WE.259.A	13	22	56	E.1670	24	5
20	E.1757	13	19	57	E.1586	22	44
21	E.1778	13	17	58	E.1335	22	46
22	E.1777	13	15	59	E.1435	22	45
23	E.1751 (IN)	13	8	60	E.1539	22	29
23	E.1752 (EX)	13	10	61	E.1529	64	38
24	E.1759	13	13	62	E.2457	64	37
25	E.1776	12	11	63	MF119	64	41
26	E.1740	12	2	64	S1-51	64	39
27	E.1775	12	5	65	E.1536	22	36
28	H.200	26	27	66	E.2252	25	1
29	E.2312	26	28	67	E.1049	25	11
30	E.1837	26	26	68	E.427	25	13
31	E.1478	26	24	69	E.452	25	12
32	E.1785	26	29	70	F.1008	22	27
33	E.1838	26	31	71	E.2022	22	26
34	E.1497	26	36	72	E.1479	23	16
35	E.2425	26	35	73	E.375	26	16
36	E.1791	22	19	74	F.2380	37	10
37	E.2250/51	22	16	75	E.2228	80	23

*See page 12 for information regarding ordering

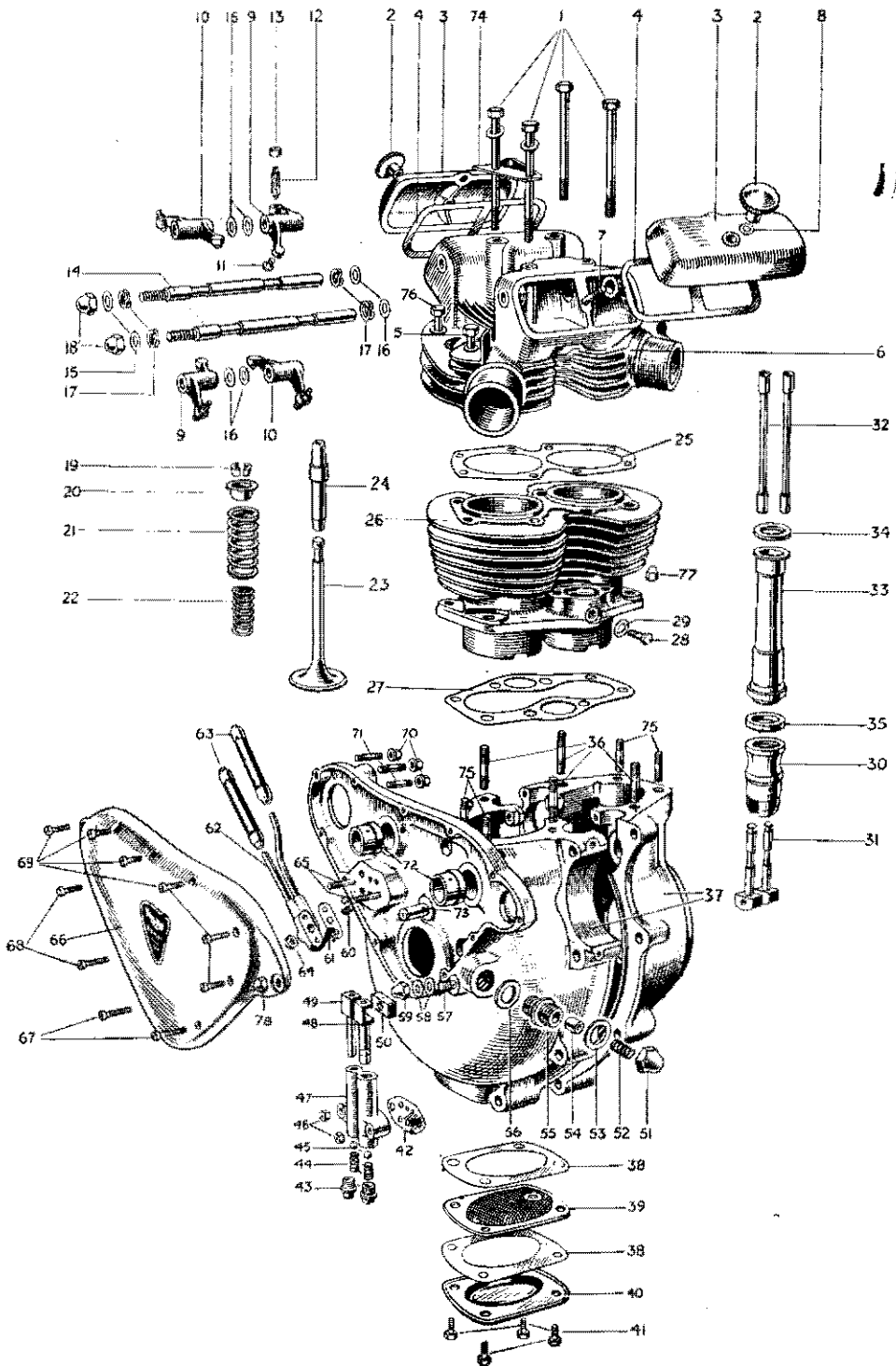

2nd CONDITION
ENGINE 3T AND T85—CRANKCASE, CYLINDER BLOCK AND CYLINDER
HEAD, ETC.

INDEX TO ILLUSTRATION ON PAGE 20

Illust. No.	Part No.	Page	Ref.	Illust. No.	Part No.	Page	Ref.
1	E.1795	12	16	40	E.486	22	40
2	E.1912	27	5	41	MT.63	22	42
3	E.1779	27	1	42	E.1537	23	34
4	E.1780	27	4	43	E.386	23	33
5	E.2631	12	18	44	E.403	23	31
6	E.2645	12	9	45	S70-7	23	32
7	E.1987	13	5	46	F.879	22	37
8	PT.104.B	27	6	47	E.1470	23	27
9	E.1755	27	9	48	E.1476	23	29
10	E.1756	27	11	49	E.1475	23	28
11	E.1483	27	13	50	E.495	23	30
12	E.1513	27	14	51	E.2304	24	6
13	E.470	27	15	52	GS.250	24	4
14	E.1813	27	19	53	GS.254	24	7
15	E.1330	27	16	54	GS.251	24	3
16	E.1575	27	17	55	GS.248	24	2
17	E.1574	27	18	56	E.1670	24	5
18	E.1435	27	21	57	E.1586	22	44
19	WE.259.A	13	22	58	E.1335	22	46
20	E.1757	13	19	59	E.1435	22	45
21	E.1778	13	17	60	E.1539	22	29
22	E.1777	13	15	61	E.1529	64	38
23	E.1751 (IN)	13	8	62	E.2457	64	37
	E.1752 (EX)	13	10	63	MF.119	64	41
24	E.1759	13	13	64	SI-51	64	39
25	E.2614	12	12	65	E.1536	22	36
26	E.2461	12	3	66	E.2252	25	1
27	E.2677	12	6	67	E.1049	25	11
28	H.200	26	27	68	E.477	25	13
29	E.2312	26	28	69	E.452	25	12
30	E.1837	26	26	70	F.1008	22	27
31	E.1478	26	24	71	E.2022	22	26
32	E.1785	26	29	72	E.1479	23	16
33	E.1838	26	31	73	E.375	26	16
34	E.1497	26	36	74	F.2380	37	10
35	E.2425	26	35	75	E.2463	22	21
36	E.2462	22	20	76	E.2632	12	19
37	E.2250/51	22	16	77	W.76	22	22
38	E.487	22	41	78	E.2228	80	23
39	E.529	22	39				

FOR IDENTIFICATION OF PART SEE PAGE 6 FOR INSTRUCTIONS

REF. No.	PART No.	DESCRIPTION	3T	5T	T100
CRANKSHAFT AND FLYWHEEL ASSY.					
1	E1460A	Crankshaft and flywheel assembly	—	1	1
2	E2200A	" " " " c/w connecting rods	1	—	—
3	E1510A	Flywheel	—	1	1
4	E1745	" " " " " " " " " " " "	1	—	—
5	E1459	Crankshaft, timing side	—	1	1
6	E1747	" " " " " " " " " " " "	1	—	—
7	E1460	" " driving side	—	1	1
8	E2200	" " " " " " " " " " " "	1	—	—
9	E1790	Tube, crankshaft	1	—	—
10	E393	Plug, crankshaft	—	1	1
11	E1562	Bolt, crankshaft to flywheel	—	6	6
12	E1760	" " " " " " " " " " " "	2	—	—
13	W103	Nut, crankshaft to flywheel bolt	—	6	6
14	E1797	" " " " " " " " " " " "	2	—	—

CRANKCASE

15	E2219.20A	Crankcase assembly, less main bearings	—	1	1
16	E2250.51	" " " " " " " " " " " "	1	—	—
17	E672	Stud, crankcase cylinder base	—	6	6
18	E1614	" " " " " " dowel	—	2	2
19	E1791	" " " " " " " " E1740 cyl. block	8	—	—
20	E2462	" " " " " " long E2461 " " "	4	—	—
21	E2463	" " " " " " short " " " "	4	—	—
22	W.76	Nut, crankcase cylinder base stud	8	4	4
23	PO172A	" " " " " " " " " " " "	—	4	4
24	E1534A	Dowel, cylinder base (hollow for stud E1614)	—	2	2
25	E1579	Dowel, crankcase halves (hollow)	1	1	1
26	E2022	Dowel, magneto fixing	3	3	3
27	F1008	Nut, " " " " " " " " " " " "	3	3	3
28	S25-3	Washer, magneto fixing stud	3	3	3
29	E1539	Stud, oil junction block	1	1	1
30	E1532	Dowel, oil junction block (hollow)	1	1	1
31	E1535	Dowel, crankcase to timing cover (hollow)	—	1	1
32	E1508	Pipe, crankcase oil return	—	1	1
33	E1770	" " " " " " " " " " " "	1	—	—
34	E1509	Clip, crankcase oil return pipe	1	1	1
35	E1645	Screw, crankcase oil return pipe clip	1	1	1
36	E1536	Stud, oil pump	2	2	2
37	F879	Nut, oil pump stud	2	2	2
38	E2312	Washer, oil pump stud	2	2	2
39	E529	Filter, crankcase oil	1	1	1
40	E486	Cover, crankcase oil filter	1	1	1
41	E487	Washer, crankcase oil filter joint	2	2	2
42	MT63	Screw, " " " " " " " " " " " "	4	4	4
43	S26-2	Washer spring, crankcase oil filter	4	4	4
44	E1586	Stud, oil gauge connection	1	—	—
45	E1435	Nut, " " " " " " stud	1	—	—
46	E1335	Washer, oil gauge connection stud	1	—	—
47	E2311	Pin, breather locating	1	1	1

CRANKCASE HALVES CANNOT BE SUPPLIED SEPARATELY

REF. No.	PART No.	DESCRIPTION	3T	5T	T100
----------	----------	-------------	----	----	------

CONNECTING RODS

1	E1489T	Rod, connecting complete	—	—	2
2	E1489	" " " " "	—	2	—
3	E1749	" " " " "	2	—	—
4	E1511	Bush, conn rod small end	—	2	2
5	E1762	" " " " "	2	—	—
6	E2448	Bolt, conn rod end cap	—	4	4
7	E1530	Nut, " " " " bolt	—	4	4
8	E1719	Washer, conn rod end cap bolt	—	4	4
9		Pin, split for E1530 nut $\frac{1}{8}'' \times \frac{3}{4}''$	—	2	2

CRANKCASE BEARINGS

10	E1592	Bearing, c/c timing side	—	1	1
11	E1769	" " " " (plain)	1	—	—
12	E1592	" " driving side	1	—	—
13	E1591	" " " " "	—	1	1
14	E2296	Disc, timing side bearing	—	1	1
15	E489	Ring, retaining t/s bearing	—	1	1
16	E1479	Bush, camshaft timing side	2	2	2
17	E1516	" " drive	1	1	1
18	E2260	" " " " (breather)	1	1	1

CRANKCASE STUDS AND BOLTS

19	E1555	Screw, crankcase top rear	1	1	1
20	S25-3	Washer, " " " screw	1	1	1
21	E925	Stud, crankcase bottom front	1	—	—
22	T456	" " " " "	—	1	1
23	S1-51	Nut, " " " stud	2	2	2
24	S25-3	Washer, " " " "	2	2	2
25	E1647	Screw, " inside boss	2	2	2

FOR ENGINE PLATE STUDS SEE PAGE 30

OIL PUMP

26	E2140	Pump, oil—complete	1	1	1
27	E1470	Body, oil pump	1	1	1
28	E1475	Plunger, oil pump feed	1	1	1
29	E1476	" " " scavenge	1	1	1
30	E495	Slider block, oil pump driving	1	1	1
31	E403	Spring, oil pump valve	2	2	2
32	S70-7	Ball " " " "	2	2	2
33	E386	Plug, " " " "	2	2	2
34	E1537	Washer, oil pump joint	1	1	1

SEE SPECIMEN ORDER IN PREFACE

REF. No.	PART No.	DESCRIPTION	3T	ST	T100
RELEASE VALVE					
1	GS253	Oil release valve complete	1	1	1
2	GS248	Body, oil release valve	1	1	1
3	GS251	Piston, " " " "	1	1	1
4	GS250	Spring, " " " "	1	1	1
5	E1670	Washer, oil release valve body	1	1	1
6	E2304	Cap, " " " " " "	1	1	1
7	GS254	Washer, " " " " " cap	1	1	1

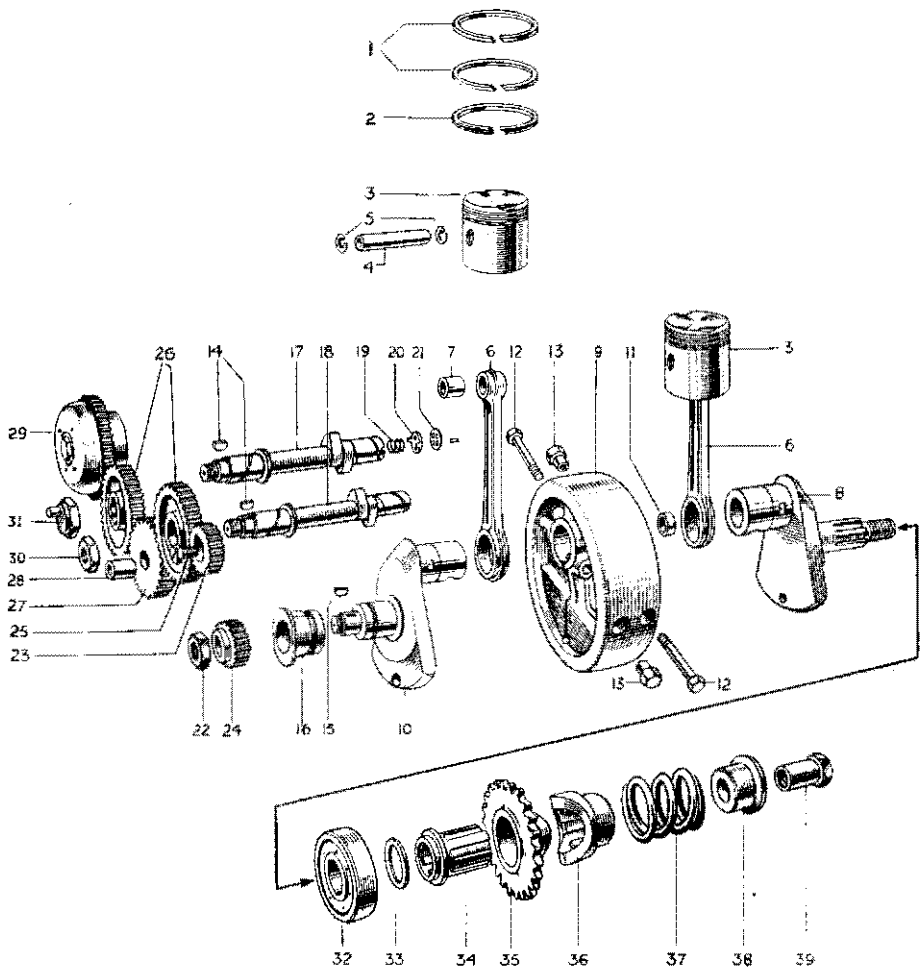

ENGINE 3T—CRANKSHAFT, CONNECTING RODS, PISTONS, TIMING GEARS, ETC.

REF. No.	PART No.	DESCRIPTION	3T	5T	T100
TIMING COVER					
1	E2252	Cover, timing gear	1	1	—
2	E2218	" " " " " " " " " " " "	—	1	1
3	E378	Bush, timing gear cover to c/s	—	1	1
4	E1586	Stud, oil gauge connection	—	1	1
5	E1435	Nut, " " " " " " " " " " " stud	—	1	1
6	E1335	Washer, oil gauge connection stud	—	2	2
7	E1595	Patent plate	—	1	—
8	E1678	" " " " " " " " " " " "	—	—	1
9	E1891	" " " " " " " " " " " "	1	—	—
10	D208-5	Screw, hammer drive	3	3	3
11	E1049	Screw, timing gear cover, long	2	3	3
12	E452	" " " " " " " " " " " short	6	—	—
13	E427	" " " " " " " " " " " medium	2	7	7

INDEX TO ILLUSTRATION ON PAGE 24

Illust. No.	Part No.	Page	Ref.	Illust. No.	Part No.	Page	Ref.
1	E.1766	17	9	20	E.2254	26	20
2	E.1819	17	17	21	G5.87	26	21
3	E.1748	13	32	22	E.398	26	4
	E.1841	17	1	23	E.2451	26	19
4	E.1750	17	22	24	E.1771	26	1
5	E.1767	17	23	25	111,700	80	21
6	E.1749	23	3	26	E.1486	26	9
7	E.1762	23	5	27	E.2202	26	13
8	E.2200	22	8	28	E.400	26	15
9	E.1745	22	4	29	47502.A	83	35
10	E.1747	22	6	30	E.1463	26	12
11	E.1790	22	9	31	E.1492	26	11
12	E.1760	22	12	32	E.1592	23	12
13	E.1797	22	14	33	E.1732	27	44
14	E.1558	26	10	34	E.1521	27	39
15	E.1580	26	3	35	E.1680.F	27	29
16	E.1769	23	11	36	E.1681	27	38
17	E.2266	26	5	37	E.659	27	40
18	E.1754	26	7	38	E.396	27	42
19	E.2256	26	22	39	E.509	27	43

SEE SPECIMEN ORDER IN PREFACE

REF. No.	PART No.	DESCRIPTION	3T	5T	T100
TIMING GEAR					
1	E1771	Pinion, timing	1	—	—
2	E1472	" " "	—	1	1
3	E1580	Key, timing pinion	1	1	1
4	E398	Nut, " "	1	1	1
5	E2266	Camshaft, inlet	1	—	—
6	E2302	" " "	—	1	1
7	E1754	" exhaust	1	—	—
8	E1485	" " "	—	1	1
9	E1486	Wheel, camshaft inlet or exhaust	2	2	2
10	E1558	Key, camshaft wheel	2	2	2
11	E1492	Nut, " " exhaust	1	1	1
12	E1463	" " " inlet	1	1	1
13	E2202	Wheel intermediate	1	—	—
14	E1471	" " "	—	1	1
15	E400	Bush, intermediate wheel	1	1	1
16	E375	Spindle, " "	1	1	1
17	E1992	Gear, magneto c/w auto advance (B.T.H.)	1	1	1
18	498152	" " " " (Lucas)	1	1	1
19	E2451	Pinion, dynamo	1	1	1
CRANKCASE BREATHER					
20	E2254	Valve, rotary	1	1	1
21	G587	Disc, valve	1	1	1
22	E2256	Spring, valve	1	1	1
23	*E2264A	Pipe, breather	1	1	1
*Not required with E2219;20A crankcase					
TAPPETS					
24	E1478	Tappet, valve	4	4	4
25	E1477	Block, valve tappet	—	2	2
26	E1837	" " "	2	—	—
27	H200	Lock screw, valve tappet block	2	2	2
28	E2312	Washer, " " "	2	2	2
PUSH ROD					
29	E1785	Rod, valve push	4	—	—
30	E1693	" " " "	—	4	4
PUSH ROD COVER TUBE					
31	E1838	Tube, push rod cover	2	—	—
32	E2273	" " " "	—	2	—
33	E2273T	" " " "	—	—	2
34	E1496	Washer, push rod seal (lower)	—	2	2
35	E242S	" " " " "	2	—	—
36	E1497	" " " " (upper)	2	2	2
OVERHEAD ROCKERS					
37	E1461	Box, rocker inlet	—	1	—
38	E1461T	" " " "	—	—	1
39	E1462	" " exhaust	—	1	—
40	E1462T	" " " "	—	—	1
41	E1650	Gasket, rocker box	—	4	4
42	E1540	Stud, " " "	—	4	4
43	F879	Nut, " " stud	—	4	4
44	E1564	Cap, " " inspection	—	4	4

FIGURE IN MODEL COLUMN DENOTES QUANTITY PER MACHINE

REF. No.	PART No.	DESCRIPTION	3T	5T	T100
1	E1779	Cap, rocker box inspection	2	—	—
2	E2423	Dowel, " " " cap	2	—	—
3	E1577	Washer, " " " " "	—	4	4
4	E1780	" " " " " " "	2	—	—
5	E1912	Nut, " " " " " "	2	—	—
6	PT104B	Washer " " " " nut (fibre)	2	—	—
7	E1545	Screw, " " " " " "	—	4	4
8	S25-13	Washer, " " screw	—	4	4
9	E1755	Rocker, valve, R.H.	2	—	—
10	E1457	" " " " " " "	—	2	2
11	E1756	" " " " L.H.	2	—	—
12	E1458	Rocker, valve, L.H.	—	2	2
13	E1483	Pin, valve rocker ball	4	4	4
14	E1513	" " " " adjusting	4	4	4
15	E470	Nut, " " " " pin	4	4	4
16	E1330	Washer, valve rocker thrust, $\frac{3}{8}$ "	2	2	2
17	E1575	" " " " " $\frac{1}{2}$ "	6	6	6
18	E1574	" " " " " thackeray	4	4	4
19	E1813	Spindle, " " " " " "	2	—	—
20	E1512	" " " " " " " "	—	2	2
21	E1435	Nut, " " " " spindle	2	2	2
22	E1335	Washer, " " " " " " "	4	4	4
23	E1781	Pipe, " " " " lubricating	1	—	—
24	E1937	" " " " " " " "	—	—	1
25	E1937A	" " " " " " " "	—	1	—
26	E1947	Tube, pipe connecting rubber	1	1	1
27	E1948	Pipe, oil gauge	1	1	1
28	XA69	Clip, pipe	5	5	5

ENGINE SPROCKET AND SHOCK ABSORBER

29	E1680F	Sprocket, engine 19T	1	—	—
30	E1680F	" " " 19T (sidecar)	—	1	1
31	E1680C	" " " 22T	—	1	1
32	E1680H	" " " 17T	—	As required	—
33	E1680G	" " " 18T	—	" "	—
34	E1680E	" " " 20T	—	" "	—
35	E1680D	" " " 21T	—	" "	—
36	E1680B	" " " 23T	—	" "	—
37	E1680A	" " " 24T	—	" "	—
38	E1681	Slider, shock absorber	1	1	1
39	E1521	Sleeve, " " " " " "	1	1	1
40	E659	Spring, " " " " " "	1	—	—
41	E395	" " " " " " " "	—	1	1
42	E396	Collar, " " " " " " "	1	1	1
43	E509	Nut, " " " " sleeve	1	1	1
44	E1732	Washer, engine sprocket distance	1	—	—

WHEN IN DOUBT SEND SAMPLE

EXHAUST SYSTEM GROUP

REF. No.	PART No.	DESCRIPTION	3T	5T	T100
EXHAUST PIPE					
1	E2236A	Pipe, exhaust, N.S.	1	—	—
2	E1520	” ” ”	—	1	1
3	E2237A	” ” O.S.	1	—	—
4	E1519	” ” ”	—	1	1
5	E2269	Clip, exhaust pipe to cylinder	2	—	—
6	E1269	” ” ” ” ” ” clip	—	2	2
7	E409	Bolt, ” ” ” ” clip	2	2	2
8	E410A	Washer, ” ” clip bolt	2	2	2
SILENCER					
9	E2646	Silencer, N.S.	1	—	—
10	E1568	” ”	—	1	1
11	E2647	” O.S.	1	—	—
12	E1567	” ”	—	1	1
13	H570	Bolt, silencer hanger	2	—	—
14	E688	” ” ”	—	2	2
15	T224	Nut, ” ” bolt	2	2	2
16	F1335	Washer, ” ” ” N.S.	1	—	—
17	E2271	Clip, silencer to exhaust pipe	2	—	—
18	TE246	” ” ” ” ” ” clip	—	2	2
19	TE164E	Bolt, ” ” ” ” clip	2	2	2
20	TE164C	”D” nut, ” ” ” ” bolt... ..	2	2	2
21	TE164D	”D” washer ” ” ” ” ” ”	2	2	2

DO NOT FORGET TO SIGN YOUR ORDER

GEARBOX GROUP

REF. No.	PART No.	DESCRIPTION	3T	5T	T100
GEARBOX CASING					
1	T264B	Casing with bushes, gearbox	1	1	1
2	E698	Stud, gearbox casing outer cover	2	2	2
3	S1-51	Nut, " " " " stud	2	2	2
4	S25-3	Washer, " " " " " " " "	2	2	2
5	T411	Cover, with bushes, gearbox outer	1	1	1
6	T452	Screw, outer cover to case	1	1	1
7	E573	" " " " " " " "	1	1	1
8	E427	" " " " inner cover	3	3	3
9	T410	Cover, with bushes gearbox inner	1	1	1
10	T323A	Stud, gearbox inner cover to outer cover	1	1	1
11	S1-51	Nut, inner cover to outer cover stud	1	1	1
12	S25-3	Washer, " " " " " " " "	1	1	1
13	E329	Screw, gearbox inner cover to case	1	1	1
14	E427	Screw, inner cover to case	2	2	2
15	T45	Stop, kickstarter quadrant	1	1	1
16	T400	Cap, gearbox filler	1	1	1
17	NT376	Washer, gearbox filler cap	1	1	1
18	S46-15	Plug, gearbox drain and inner cover level	2	2	2
19	PT104B	Washer, drain and level plug	2	2	2
GEARBOX FITTINGS					
20	T717	Plate, gearbox mounting clamp	2	2	2
21	T456	Stud, gearbox clamp tie	2	2	2
22	S1-51	Nut, " " " stud	3	3	3
23	T461	Nut, " " " " " " " "	1	1	1
24	S26-3	Washer, " " " tie stud spring	2	2	2
25	F1681	Bolt, " " " pin	1	1	1
26	S4-13	Nut, " " " " bolt	1	1	1
27	S25-8	Washer, " " " " " " " "	1	1	1
28	T430	Bolt, gearbox pivot	—	1	1
29	F2391	" " " " " " " "	1	—	—
30	F1126	Nut, " " " " bolt	1	—	—
31	S26-1	Washer, " " " " " " " "	1	1	1
32	T275	Adjuster assembly, primary chain	1	1	1
SHAFTS AND GEARS					
33	T441	Mainshaft (15T)	1	1	1
34	S66-1	Woodruff key, No. 6	1	1	1
35	T421	Nut, clutch to mainshaft	1	1	1
36	T420	Plain washer, clutch to mainshaft	1	1	1
37	T524	Lock washer, " " " " nut	1	1	1
38	T433	Layshaft	1	1	1
39	T432	Tube, layshaft distance	1	1	1
30	T726	Gear, mainshaft high (25T)	1	1	1
41	T492	Tube, mainshaft high gear distance	1	1	1

ALL GOODS SENT TO WORKS MUST BE CARRIAGE PAID

REF. No.	PART No.	DESCRIPTION	3T	5T	T100
1	T446	Bush, gearbox mainshaft high gear	2	2	2
2	T443	Gear, mainshaft 3rd (23T)	1	1	1
3	T727	Gear, mainshaft 2nd (19T)	1	1	1
4	T434	Gear, layshaft high (19T)	1	1	1
5	T438	Bush, layshaft high gear	2	2	2
6	T435	Gear, layshaft 3rd (21T)	1	1	1
7	T436	Gear, layshaft 2nd (25T)	1	1	1
8	T437	Gear, layshaft low (29T)	1	1	1
9	T431	Bush, layshaft low gear	1	1	1

GEARBOX SHELL BEARINGS

10	T448	Bearing, high gear	1	1	1
11	T445	Cover, high gear bearing dust	1	1	1
12	E489	Ring, " " " retaining	1	1	1
13	S35-7	Bearing, mainshaft	1	1	1
14	T280	Ring, bearing retaining	1	1	1
15	T290	Bush, layshaft	2	2	2
16	T18	Disc, layshaft bush	1	1	1
17	T341	Bush, gear selector cam plate	1	1	1
18	T412	Bush, footchange spindle (inner)	1	1	1
19	T57	" " " (outer)	1	1	1
20	T362	Bush, kickstarter (inner)	1	1	1
21	T23	" " (outer)	1	1	1

GEAR CONTROL (SELECTOR MECHANISM)

22	T397	Quadrant, gear operating	1	1	1
23	T399	Spindle, gear operating quadrant	1	1	1
24		Split pin, 1½" × 5/64	1	1	1
25	T500	Camplate, gear control	1	1	1
26	NT261	Roller, gear control cam plate	2	2	2
27	T501	Plunger, " " " "	1	1	1
28	T372	Bush, " " " " plunger	1	1	1
29	T373	Spring, " " " " "	1	1	1
30	T260	Fork, gear selector mainshaft	1	1	1
31	T261	" " " layshaft	1	1	1
32	T291	Rod, " " fork	1	1	1

GEAR CONTROL (ENCLOSED FOOTCHANGE)

33	T407	Plate, footchange guide	1	1	1
34	T454	Stud, " " plate	4	4	4
35	F879	Nut, " " stud	4	4	4
36	E2312	Washer, " " " " (shakeproof)	4	4	4
37	T408/9	Plunger assembly, gear quadrant	1	1	1
38	T406	Plunger, gear quadrant	2	2	2
39	T405	Spring, " " plunger	2	2	2
40	T398	Pedal, footchange	1	1	1
41	T450	Set screw, footchange pedal	1	1	1
42	T449	Rubber	1	1	1
43	T404	Spring, footchange pedal return	2	2	2
44	T395	Finger, gear indicator	1	1	1

TREASURY NOTES MUST BE REGISTERED

GEARBOX (See also Page 33)

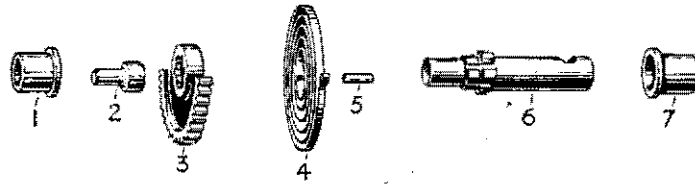

436

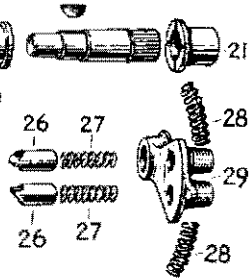
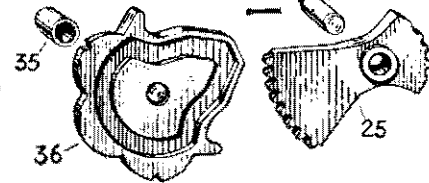
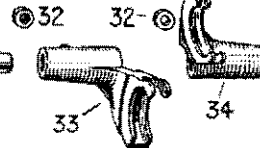
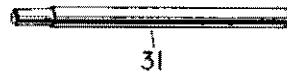
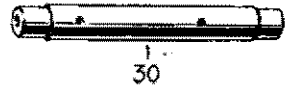
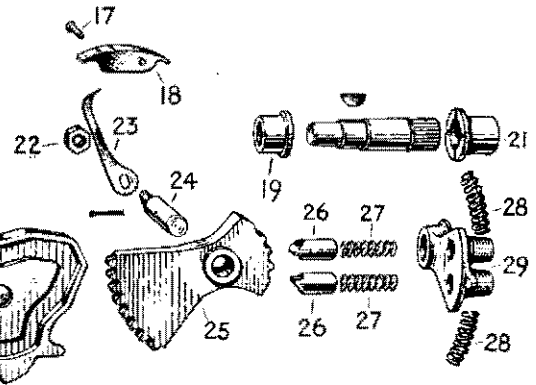
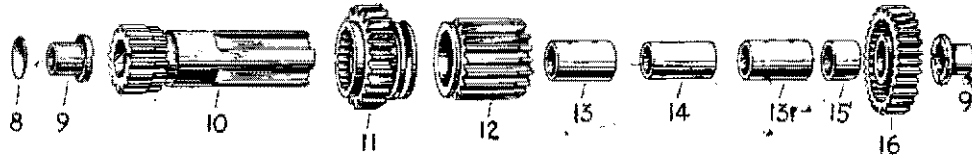

GEARS AND CLUTCH (See also page 32)

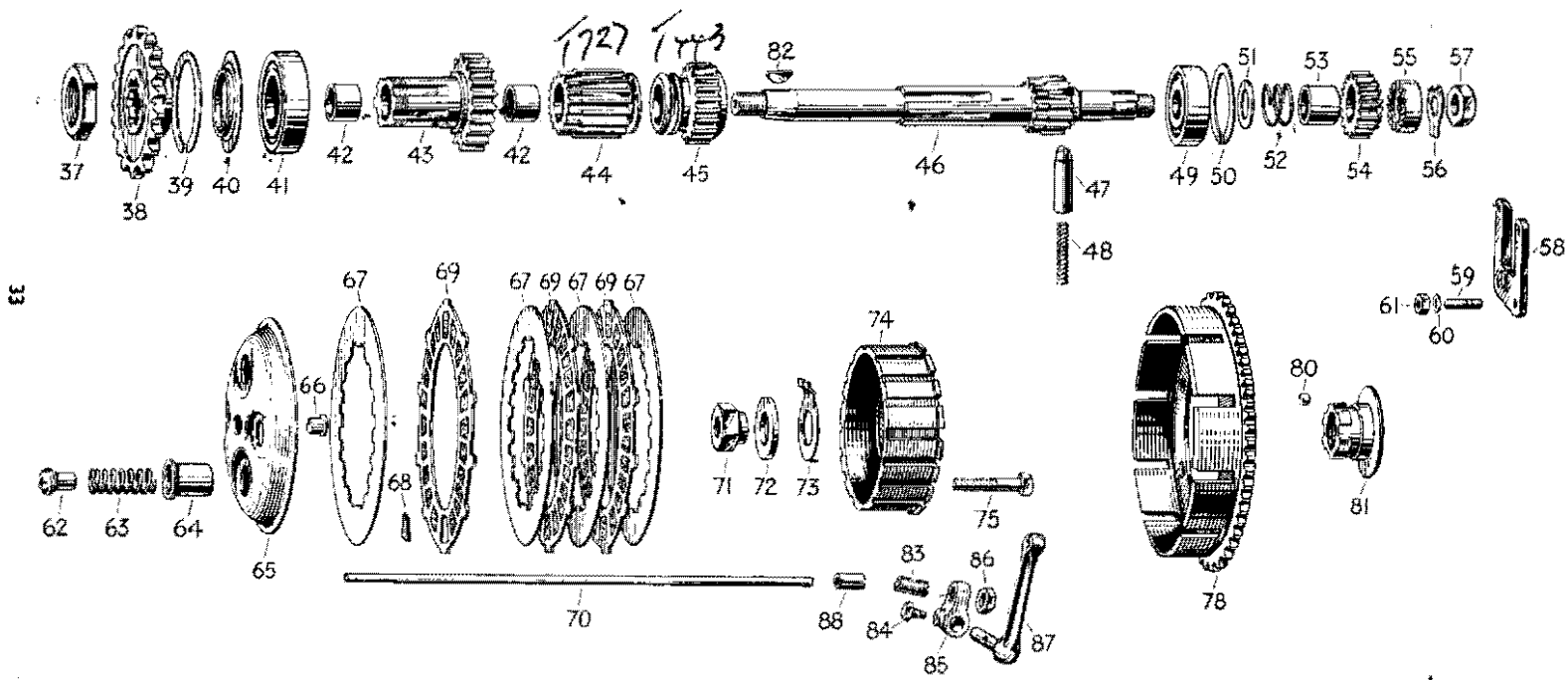

INDEX TO ILLUSTRATIONS ON PAGES 32 AND 33

Illust. No.	Part No.	Page	Ref.	Illust. No.	Part No.	Page	Ref.
1	T.362	31	20	46	T.441	29	33
2	T.45	29	15	47	T.501	31	27
3	T.25.A	35	10	48	T.373	31	29
4	T.31	35	8	49	S35-7	31	13
5	T.47	35	9	50	T.280	31	14
6	T.24.A	35	11	51	T.505	35	17
7	T.23	31	21	52/3	T.488/28	35	14
8	T.18	31	16	54	T.730	35	12
9	T.290	31	15	55	T.731	35	13
10	T.434	31	4	56	T.732	35	16
11	T.436	31	7	57	NT.297	35	15
12	T.435	31	6	58	T.407	31	33
13	T.438	31	5	59	T.454	31	34
14	T.432	29	39	60	E.2312	31	36
15	T.431	31	9	61	F.879	31	35
16	T.437	31	8	62	T427	35	31
17	D.208-17	35	4	63	T.429	35	28
18	T.396	35	3	64	T.425	35	32
19	T.412	31	18	65	T.419	35	33
21	T.57	31	19	66	T.422	35	34
22	T.224	35	1	67	T.415	35	27
23	T.395	31	44	68	NT.288	35	26
24	T.399	31	23	69	T.414	35	25
25	T.397	31	22	70	T.455	35	43
26	T.406	31	38		T.455.A	35	44
27	T.405	31	39	71	T.421	29	35
28	T.404	31	43	72	T.420	29	36
29	T.408/9	31	37	73	T.524	29	37
30	T.433	29	38	74	T.417	35	23
31	T.291	31	32		T.417.A	35	24
32	NT.261	31	26	75	T.423	35	30
33	T.261	31	31		T.424	35	29
34	T.260	31	30	78	T.416/428	35	20
35	T.341	31	17		T.416A/428	35	21
36	T.500	31	25	80	T.394	35	22
37	T.440	35	19	81	T.418	35	35
38	T.471.A	35	18	82	S66-1	29	34
39	E.489	31	12	83	T.413	35	41
40	T.445	31	11	84	T.401	35	39
41	T.448	31	10	85	T.402	35	38
42	T.446	31	1	86	T.453	35	42
43	T.726	29	40	87	T.487	35	36
44	T.727	31	3	88	PT.108.B	35	45
45	T.443	31	2				

FOR IDENTIFICATION OF PARTS SEE PAGE 6 FOR INSTRUCTIONS

REF. No.	PART No.	DESCRIPTION	3T	5T	T100
1	T224	Nut, gear indicator	1	1	1
2	S25-3	Washer, gear indicator	1	1	1
3	T396	Quadrant, gear indicator	1	1	1
4	D208-17	Pin, gear indicator quadrant fixing	2	2	2
KICKSTARTER					
5	T451	Crank, kickstarter	1	1	1
6	F1814	Rubber, " crank	1	1	1
7	S52-1	Cotter pin, complete with nut and washer	1	1	1
8	T31	Spring, k/s return	1	1	1
9	T47	Peg, " " spring anchor	1	1	1
10	T25A	Quadrant, kickstarter	1	1	1
11	T24A	Shaft, kickstarter axle	1	1	1
12	T730	Pinion, "	1	1	1
13	T731	Ratchet, "	1	1	1
14	T488/28	Sleeve and spring, pinion	1	1	1
15	NT297	Nut, kickstarter ratchet	1	1	1
16	T732	Washer, " " lock	1	1	1
17	T505	Washer, " "	1	1	1
GEARBOX SPROCKET					
18	T471A	Sprocket, gear box 18T	1	1	1
19	T440	Nut, gearbox sprocket locking	1	1	1
GEARBOX CLUTCH					
20	T416/428	Housing, with sprocket, clutch	—	1	1
21	T416A/428	" " " "	1	—	—
22	T394	Rollers	20	20	20
23	T417	Centre, clutch	—	1	1
24	T417A	" " " "	1	—	—
25	T414	Plate, clutch driving corked	3	4	4
26	NT288	Insert, clutch cork	72	96	96
27	T415	Plate, clutch driven	4	5	5
28	T429	Spring, clutch	4	4	4
29	T424	Pin, clutch spring	4	—	—
30	T423	" " " "	—	4	4
31	T427	Nut, " " pin	4	4	4
32	T425	Cup, clutch spring	4	4	4
33	T419	Plate assembly, clutch pressure	1	1	1
34	T422	Button, clutch pressure plate	1	1	1
35	T418	Hub, clutch	1	1	1
CLUTCH CONTROL					
36	T487	Lever, clutch operating	1	1	1
37	T495	Cap, " " lever, rubber	1	1	1
38	T402	Arm, " " " "	1	1	1
39	T401	Peg, " " " "	1	1	1
40	E2312	Washer, " " " peg (shakeproof)	1	1	1
41	T413	Pin, clutch lever adjusting with ball	1	1	1
42	T453	Nut, " " " pin locking	1	1	1
43	T455	Rod, " " operating	—	1	1
44	T455A	" " " "	1	—	—
45	PT108B	Bush, mainshaft clutch rod	1	1	1

CLUTCH PLATES CAN BE PROMPTLY RECORDED

WIDE RATIO GEAR GROUP

REF. No.	PART No.	DESCRIPTION	3T	5T	T100
1	T465	High gear, mainshaft			
2	T466	High gear, layshaft			
3	T467	2nd gear, mainshaft			
4	T468	2nd gear, layshaft			

CLOSE RATIO GEAR GROUP

5	T515C	Mainshaft			
6	T513C	Gear, mainshaft high			
7	T509C	Gear, mainshaft 2nd			
8	T511C	Gear, mainshaft 3rd			
9	T510C	Gear, layshaft low			
10	T512C	Gear, layshaft high			
11	T514C	Gear, layshaft 2nd			
12	T508C	Gear, layshaft 3rd			

SEE PAGE 84 FOR GEAR RATIOS

FRAME GROUP

REF. No.	PART No.	DESCRIPTION	3T	5T	T100
FRONT PORTION					
1	F2385	Frame, front portion	1	—	—
2	F2400	" " " " " " " "	—	1	1
3	E1023	Stud, seat lug to back stays	1	—	—
4	F1561	" " " " " " " "	—	1	1
5	PO172A	Nut, " " " " " stud	2	2	2
6	S26-1	Washer, " " " " " "	2	2	2
7	F994	Stud, frame to chain stay seat tube	1	1	1
8	S1-30	Nut, " " " " " stud	2	2	2
9	SCZ45	Washer, " " " " " " "	2	2	2
10	F2380	Bracket, engine to frame torque	1	—	—
11	E1597	Stay, " " " " " "	—	2	2
12	F2381	Clip, " " " " " bracket	1	—	—
13	E1598	" " " " " stay	—	1	1
14	DS55	Bolt, " " " " " bracket clip	1	—	—
15	F1031	" " " " " " " "	—	1	1
16	S1-51	Nut, " " " " " " "	1	—	—
17	PO172A	" " " " " " " "	—	1	1
18	S25-3	Washer, " " " " " " "	—	1	1
19	S26-3	" " " " " " " "	1	—	—
20	S1-52	Nut, cylinder head bolt torque stay fixing	—	2	2
21	S26-1	Washer, " " " " " " "	—	2	2
22	F1841	Support, petrol tank front	—	1	1
23	F1451	Bolt, tank front support	—	1	1
24	S1-52	Nut, " " " " bolt	—	1	1
25	F1671	Support, petrol tank rear	—	1	1
26	F1213	Bolt, tank rear support	—	2	2
27	S26-3	Washer, tank rear support bolt	—	2	2
28	NW100	Lubricator, steering column	1	1	1
<i>SEE FRONT FORK GROUP FOR HEAD LUG STEERING RACES</i>					
REAR PORTION					
29	F2385A	Frame, rear portion	1	—	—
30	F2751*	" " " " " " " "	—	1	1
31	F1616A	" " " " " " " "	—	1	1
32	F969	Screw, rear chain adjuster	2	2	2
33	F1008	Locknut, " " " " screw	2	—	—
34	F1824	" " " " " " " "	—	2	2

*Used on machines after frame number TF17790 in conjunction with mudguard F2756.8.

FRAME NUMBER IS ON FRONT TOP OF HEAD LUG

FRAME AND COMPONENTS 5T AND T100

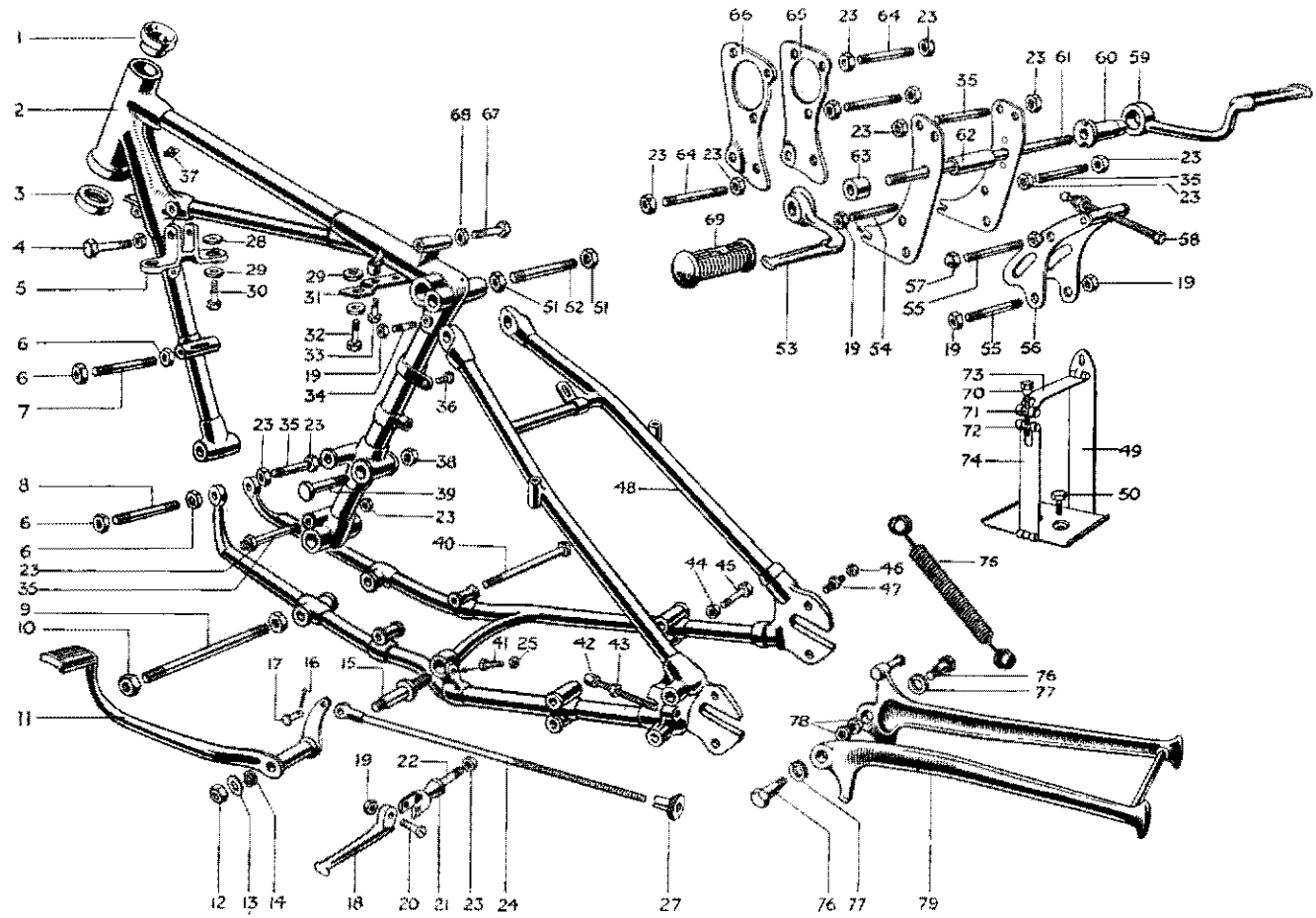

38

INDEX TO ILLUSTRATION ON PAGE 38

Illust. No.	Part No.	Page	Ref.	Illust. No.	Part No.	Page	Ref.	Illust. No.	Part No.	Page	Ref.
1	H.437	45	5	28	F.1813	64	14	53	F.987	68	14
2	F.2400	37	2	29	F.967	64	13	54	F.839	42	28
3	H.111	45	6	30	F.1808	64	11	55	T.456	29	21
4	F.1451	37	23	31	F.1671	37	25	56	T.717	29	20
5	F.1841	37	22	32	F.966	64	10	57	T.461	29	23
6	DS.47	42	13/19	33	F.1213	37	26	58	T.275	29	32
7	F.2414	42	11	34	F.1682	64	28	59	F.1731	68	13
8	F.1680	42	17	35	S1-51	64	29	60	F.1736	68	16
9	F.994	37	7	36	F.929	64	23	61	F.991	68	17
10	S1-30	37	8	37	NW.100	37	28	62	F.862	68	22
11	F.1153	67	31	38	S4-13	29	26	63	T.87	60	17
12	S1-51	68	2	39	F.1681	29	25	64	F.1711	42	23
13	S25-2	68	3	40	T.430	29	28	65	E.2223	42	3
14	S26-16	68	4	41	F.1149	67	33	66	E.2222	42	2
15	F.867	67	35	42	F.969	37	32	67/8	NA.64.J	69	6
16	1/16" pin	68	10	43	F.1824	37	34	69	NF.704	68	15
17	WF.32	68	9	44	T.224	28	15	70	E.536	42	38
18	F.1694	68	24	45	E.688	28	14	71	E.534	42	36
19	S1-51	68	27	46	F.947	56	34	72	E.535	42	37
20	F.2271	68	26	47	F.946	56	33	73	F.1667	42	39
21	F.2268	68	29	48	F.1616.A	37	31	74	F.1668	42	40
22	F.1696	68	30		F.2751	37	30	75	F.975.A	45	36
23	PO.172.A	68	31	49	F.1670	42	34	76	F.977	45	37
24	F.1015.A	68	6	50	F.1715	42	44	77	F.976	45	39
	F.1015.B	68	7	51	PO.172.A	37	5	78	W.630	45	38
27	NS.372	68	12	52	F.1561	37	4	79	F.1834	45	35

*See instruction page 37

FOR IDENTIFICATION OF PARTS SEE PAGE 6 FOR INSTRUCTIONS

FRAME AND COMPONENTS 3T

40

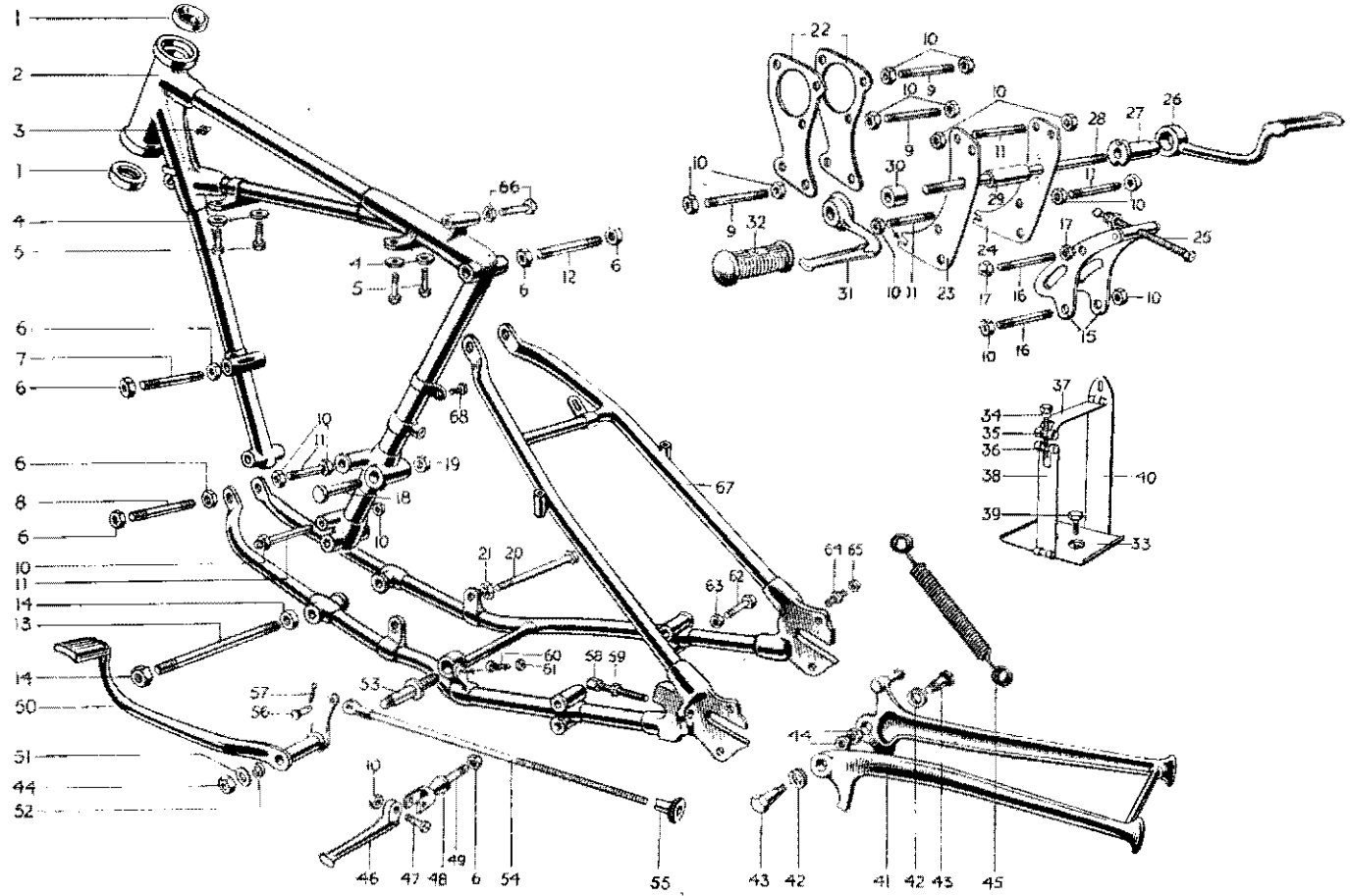

INDEX TO ILLUSTRATION ON PAGE 40

Illust. No.	Part No.	Page	Ref.	Illust. No.	Part No.	Page	Ref.	Illust. No.	Part No.	Page	Ref.
1	XS.10	45	4	24	F.2396	42	4	47	F.2271	68	26
2	F.2385	37	1	25	T.275	29	32	48	E.2268	68	29
3	NW.100	37	28	26	F.1731	68	13	49	F.1696	68	30
4	F.967	64	13	27	F.1736	68	16	50	F.1153	67	31
5	F.966	64	10	28	F.1092	68	18	51	S25-2	68	3
6	PO.172.A	42	14	29	F.1081	68	21	52	S26-16	68	4
7	E.1023	42	12	30	T.200	60	18	53	F.867	67	35
8	F.1711	42	18	31	F.987	68	14	54	F.1015	68	5
9	E.925	42	24	32	NF.704	68	15		F.1015.C	68	8
10	S1-51	42	26	33	F.1670	42	34	55	NS.372	68	12
11	E.654	42	29	34	E.536	42	38	56	WF.32	68	9
12	E.1023	42	12	35	E.534	42	36	57	1/16" pin	68	10
13	F.994	37	7	36	E.535	42	37	58	F.969	37	32
14	S1-30	37	8	37	F.1667	42	39	59	F.1008	37	33
15	T.717	29	20	38	F.1668	42	40	60	F.1149	67	33
16	T.456	29	21	39	F.1715	42	44	61	F.879	67	34
17	T.461	29	23	40	E.1665.6	42	35	62	H.570	28	13
18	F.1681	29	25	41	F.1834	45	35	63	T.224	28	15
19	S4-13	29	26	42	F.976	45	39	64	F.946	56	33
20	F.2319	29	29	43	F.977	45	37	65	F.947	56	34
21	F.1126	29	30	44	W.630	45	38	66	NA.64.J	69	6
22	F.2235	42	1	45	F.975.A	45	36	67	F.2385.A	37	29
23	F.2392	42	6	46	F.1694	68	24	68	F.1213	64	24

FOR IDENTIFICATION OF PARTS SEE PAGE 6 FOR INSTRUCTIONS

CRANKCASE AND FRAME STUDS, BOLTS AND WASHERS

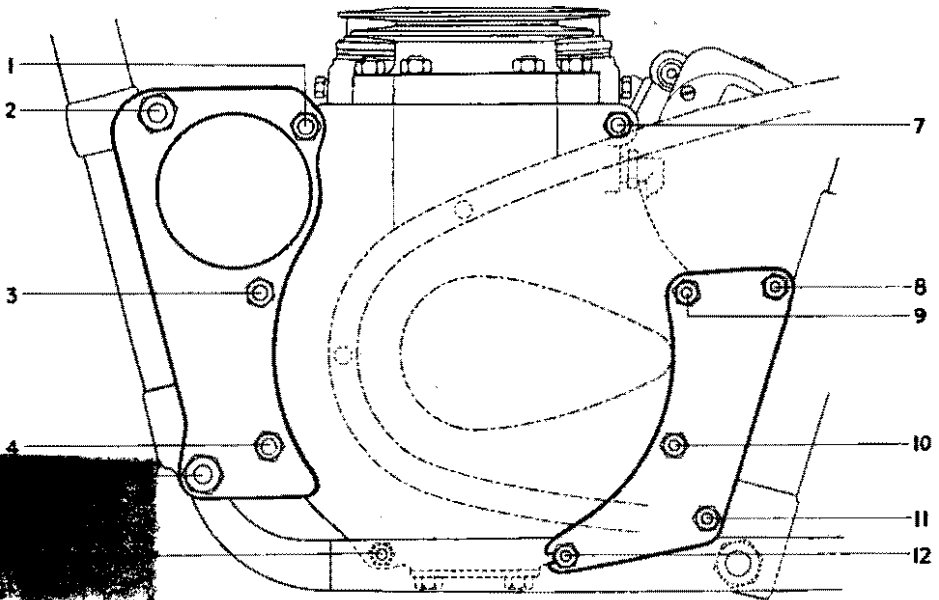

INDEX

350 c.c.

1, 3, 4	E.925	Stud.	5. F.1711	Stud.	8, 9, 10	E.654	Stud.
& 6	51-51	Nut.	PO.172.A	Nut.	11 & 12	51-51	Nut.
	S25-3	Washer.	S26-1	Washer.		S26-3	Washer.
2.	E.1023	Stud.	7. E.1555	Bolt.			
	PO.172.A	Nut.	S25-3	Washer.			
	S26-1	Washer.					

500 c.c.

1, 3, 4	F.1711	Stud.	5. F.1680	Stud.	7.	F.1555	Bolt.
	PO.172.A	Nut.	DS.47	Nut.		S25-3	Washer.
	S26-1	Washer.	PCW.73.A	Washer.			
2.	F.2414	Stud.	6. T.456	Stud.	8, 9, 10	F.839	Stud.
	DS.47	Nut.	SI-SI	Nut.	11 & 12	PO.172.A	Nut.
	PCW.73.A	Washer	S25-3	Washer		S26-1	Washer.

ALWAYS QUOTE PART NUMBER

FRONT FORK GROUP

REF. No.	PART No.	DESCRIPTION	3T	5T	T100
FRONT FORK ASSEMBLY					
1	H501	Fork assembly, crown and stem and head top lug clip	1	—	—
2	H502	" " " " " " " " " "	—	1	1
3	H501A	Member, fork complete, N.S.	1	—	—
4	H502A	" " " " " " " " " "	—	1	1
5	H501B	" " " " O.S.	1	—	—
6	H502B	" " " " " " " " " "	—	1	1
7	H380	Lug, fork head top c/w handlebar caps	1	1	1
8	F1760	Bolt, head top lug pinch	1	1	1
9	H379	Nut " " " " bolt	1	1	1
10	H506	Cap, handlebar to head top lug	2	2	2
11	H436	Bolt, handlebar cap	4	4	4
12	H402	Crown and stem, fork	1	1	1
13	H404	Nut, crown and stem sleeve	1	—	—
14	H405	" " " " " " " " " "	—	1	1
15	H570	Bolt, " " " " to stanchion pinch	2	2	2
16	H518	Nut, " " " " " " " bolt	2	2	2
17	S25-3	Washer, " " " " " " " "	2	2	2
18	H421	Cover, tube top with headlamp bracket, N.S.	1	1	1
19	H422	" " " " " " " O.S.	1	1	1
20	H420	Washer, cover tube felt	2	2	2
21	H414	Cover tube bottom, with wheel spindle lug, N.S.	1	1	1
22	H415	" " " " " " " O.S.	1	1	1
23	H519	Plug, cover tube bottom drain	2	2	2
24	H430	Washer, " " " " " plug	2	2	2
25	F1760	Bolt, N.S. " " " " wheel lug pinch	1	1	1
26	H379	Nut, N.S. cover tube bottom wheel lug bolt	1	1	1
27	H390	Sleeve, " " " " dust excluder	2	2	2
28	H391	Washer, " " " " " sleeve felt	2	2	2
29	H445	Washer, inner retaining for H391	2	2	2
30	H431	Washer, outer " " " "	2	2	2
31	H441	Bearing, bottom cover tube	2	2	2
32	H382	Stanchion	2	2	2
33	H432	Nut, stanchion upper sleeve cap	2	2	2
34	H443	Bearing, stanchion lower	2	2	2
35	H444	Nut, stanchion hydraulic stop	2	2	2
36	H385	Spring, main (identification mark white)	2	—	—
37	H384	" " (" " " red)	—	2	2
38	H505	" " (side-car) (identification mark blue)	—	2	2
39	H521	Pressure tube assembly	1	1	1
40	H399	Rod, oil restrictor	2	2	2
41	H452	Restrictor, oil	2	2	2
42	H453	Cup, oil restrictor rod	2	2	2
43	H454	Pin, " " " " cup	2	2	2
44	F879	Nut, " " " " "	2	2	2
45	H394	Tube, pressure	2	2	2
46	H395	Body, pressure tube valve	2	2	2
47	H397	Sleeve, pressure tube support	2	2	2

PRICES DO NOT INCLUDE POSTAGE OR CARRIAGE

REF. No.	PART No.	DESCRIPTION	3T	5T	T100
1	H500	Pin, valve body	2	2	2
2	H398	Bolt, pressure valve body to lug	2	2	2
3	E1335	Washer, bolt	2	2	2

STEERING CUPS, CONES AND BALLS

4	XS10	Cup, frame lug, top	1	—	—
5	H437	" " " "	—	1	1
6	H111	" " " " bottom	—	1	1
7	XS10	" " " "	1	—	—
8	H438	Cone, head lug, top	—	1	1
9	H433	" " " "	1	—	—
10	H439	Cone, crown and stem, bottom	—	1	1
11	XS8	" " " " " "	1	—	—
12	S70-4	Ball, top race $\frac{3}{8}$ "	22	22	22
13	S70-3	" " bottom race $\frac{1}{2}$ "	—	20	20
14	S70-4	" " " " $\frac{3}{16}$ "	22	—	—
15	H406	Cover, top cone dust	1	—	—
16	H407	" " " "	—	1	1

STEERING DAMPER

17	H536	Knob, with rod	1	1	1
18	H565	Washer, rod	1	1	1
19	H408	Sleeve, rod adjusting	1	1	1
20	H409	Pin, securing sleeve	1	1	1
21	H413	Plate, damper anchor	—	1	1
22	H434	" " " "	1	—	—
23	F1718	Bolt, plate	1	1	1
24	S1-51	Nut, bolt	1	1	1
25	S25-3	Washer,	1	1	1
26	H435	Disc, friction	1	1	1
27	H95	Plate, friction disc spring	1	1	1

STAND GROUP

FRONT STAND

28	H412	Stand assembly, front	1	1	1
29	DS55	Bolt, front stand to guard	1	1	1
30	S1-51	Nut,	1	1	1
31	NS362	Nut, spigot	1	1	1
32	H424	Screw, pivot	2	2	2
33	S25-3	Washer, plain stand to guard pivot	2	2	2
34	H425	" " spring	2	2	2

REAR STAND

35	F1834	Rear stand assembly	1	1	1
36	F975A	Spring, rear stand	1	1	1
37	F977	Bolt, pivot	2	2	2
38	W630	Nut, bolt	2	2	2
39	F976	Washer,	2	2	2

SEE PAGES 7-II FOR CARTON PACKS

TRIUMPH
TELESCOPIC
FRONT FORKS

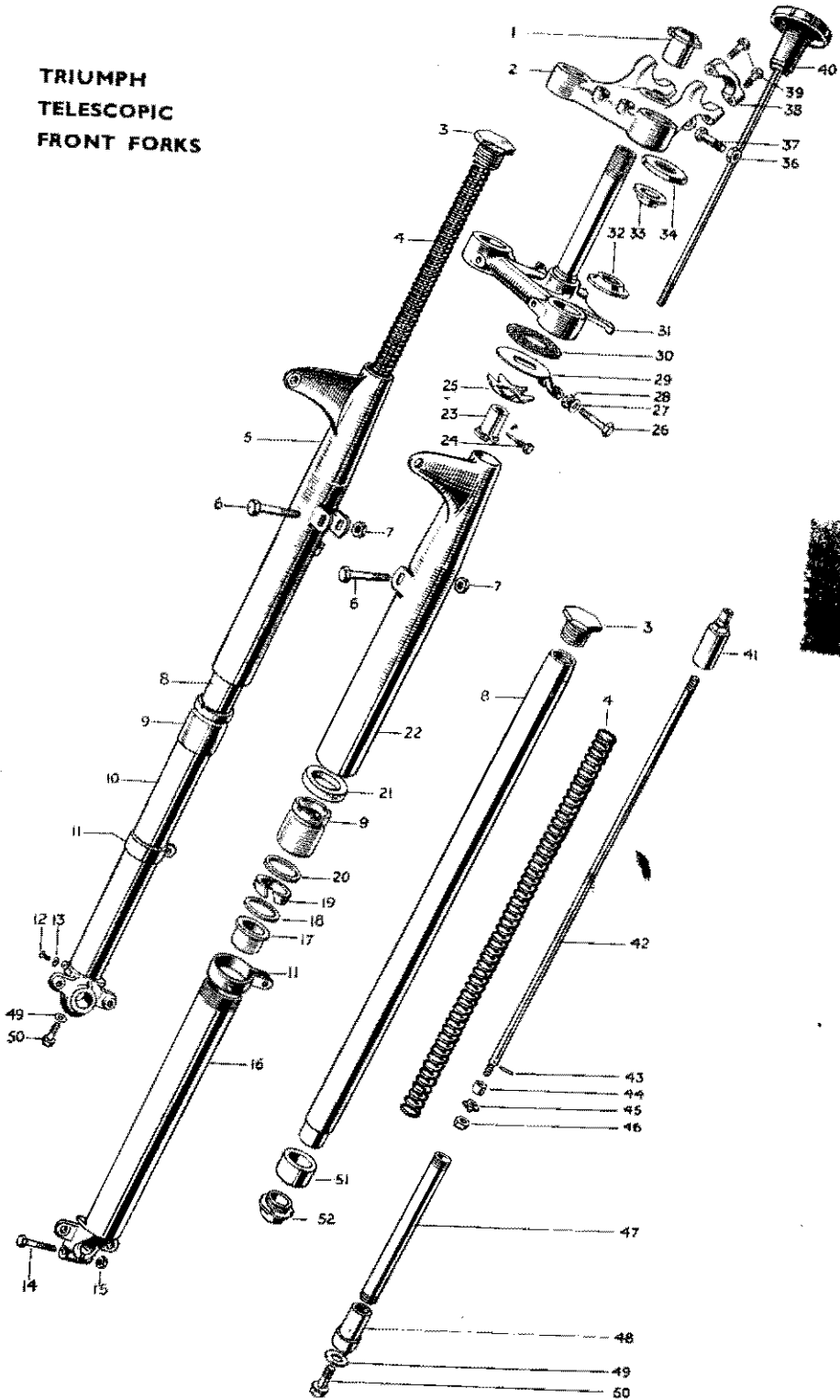

INDEX TO ILLUSTRATION ON PAGE 46

Illust. No.	Part No.	Page	Ref.	Illust. No.	Part No.	Page	Ref.
1	H.405	44	14	27	S25-3	45	25
	H.404	44	13	28	S1-51	45	24
2	H.380	44	7	29	H.413	45	21
3	H.432	44	33	30	H.435	45	26
4	H.384	44	37	31	H.402	44	12
	H.505	44	38	32	H.439	45	10
	H.385	44	36		X.S.8	45	11
5	H.422	44	19	33	H.438	45	8
6	H.570	44	15		H.433	45	9
7	H.518	44	16	34	H.407	45	16
8	H.382	44	32		H.406	45	15
9	H.390	44	27	36	H.379	44	9
10	H.415	44	22	37	F.1760	44	8
	H.438	56	3	38	H.506	44	10
	19	44	23	39	H.436	44	11
	30	44	24	40	H.536	45	17
	60	44	25	41	H.397	44	47
	79	44	26	42	H.399	44	40
	14	44	21	43	H.454	44	43
17	H.441	44	31	44	H.453	44	42
18	H.431	44	30	45	H.452	44	41
19	H.391	44	28	46	F.879	44	44
20	H.445	44	29	47	H.394	44	45
21	H.420	44	20	48	H.395	44	46
22	H.421	44	18	49	E.1335	45	3
23	H.408	45	19	50	H.398	45	2
24	H.409	45	20	51	H.443	44	34
25	H.95	45	27	52	H.444	44	35
26	F.1718	45	23				

FOR IDENTIFICATION OF PARTS SEE PAGE 6 FOR INSTRUCTIONS

WHEELS

NOTE.—Spokes with specially angled heads ensures very sturdy wheel construction. To maintain this condition, state clearly when ordering sundry spokes:—

- (a) Side of wheel, i.e., brake side or reverse; N/S or O/S.
- (b) Whether head of spoke is toward or away from wheel centre.

FRONT WHEEL GROUP

REF. No.	PART No.	DESCRIPTION	3T	5T	T100
1	W571	Wheel, front, complete	1	1	1
2	W572	Wheel, front less bearing and brake assembly ...	1	1	1
3	W351	Rim, front wheel	1	1	1
4	W662	Spoke, short, 6 $\frac{13}{16}$ " × 10G × 83°, O.S. ...	10	10	10
5	W663	" " 6 $\frac{13}{16}$ " × 10G × 94°, O.S. ...	10	10	10
6	W660	" long, 8 $\frac{13}{16}$ " × 10G × 88°, N.S. ...	10	10	10
7	W661	" " 8 $\frac{13}{16}$ " × 10G × 90°, N.S. ...	10	10	10
8	S79-2	Nipple, spoke	40	40	40
9	W573	Hub, shell assembly	1	1	1
10	W576	Drum, brake assembly	1	1	1
11	W62	Bolt, brake drum	8	8	8
12	51-51	Nut, brake drum bolt	8	8	8
13	W63	Lockplate, brake drum nut	4	4	4
14	W578	Spindle, front wheel hub	1	1	1
15	W761	Sleeve and collar, front wheel spindle ...	1	1	1
16	W544	Nut, " " " " " " ...	1	1	1
17	W545	Washer, " " " " " " ...	1	1	1
18	W653	Bearing, front wheel ball	2	2	2
19	W581	Distance piece, ball bearing	1	1	1
20	W582	Ring, ball bearing retaining	1	1	1
21	W583	Cap, ball bearing dust	1	1	1

INDEX TO ILLUSTRATION ON PAGE 49

Illust. No.	Part No.	Page	Ref.	Illust. No.	Part No.	Page	Ref.
1	W.578	48	14	17	W.588	50	2
2	W.583	48	21	18	S25-2	50	4
3	W.653	48	18	19	PO.172.A	50	3
4	W.581	48	19	20	W.592	50	13
5	W.761	48	15	21	W.589	50	10
6	H.569	56	11	22	S25-6	50	12
7	W.545	48	17	23	S1-52	50	11
8	W.544	48	16	24	H.427	56	1
9	W.582	48	20	25	D5.55	45	29
10	51-51	48	12	26	DS.57	56	12
11	W.63	48	13	27	F.879	56	13
12	W.573	48	9	28	F.2698	59	23
13	W.93	50	5	29	S26-2	59	25
14	W.135	50	8	30	H.566	56	10
15	W.386.A	50	9	31	H.251	59	26
16	W.585	50	1				

THE PARAGRAPH ON SPOKE HEAD ANGLES IS IMPORTANT

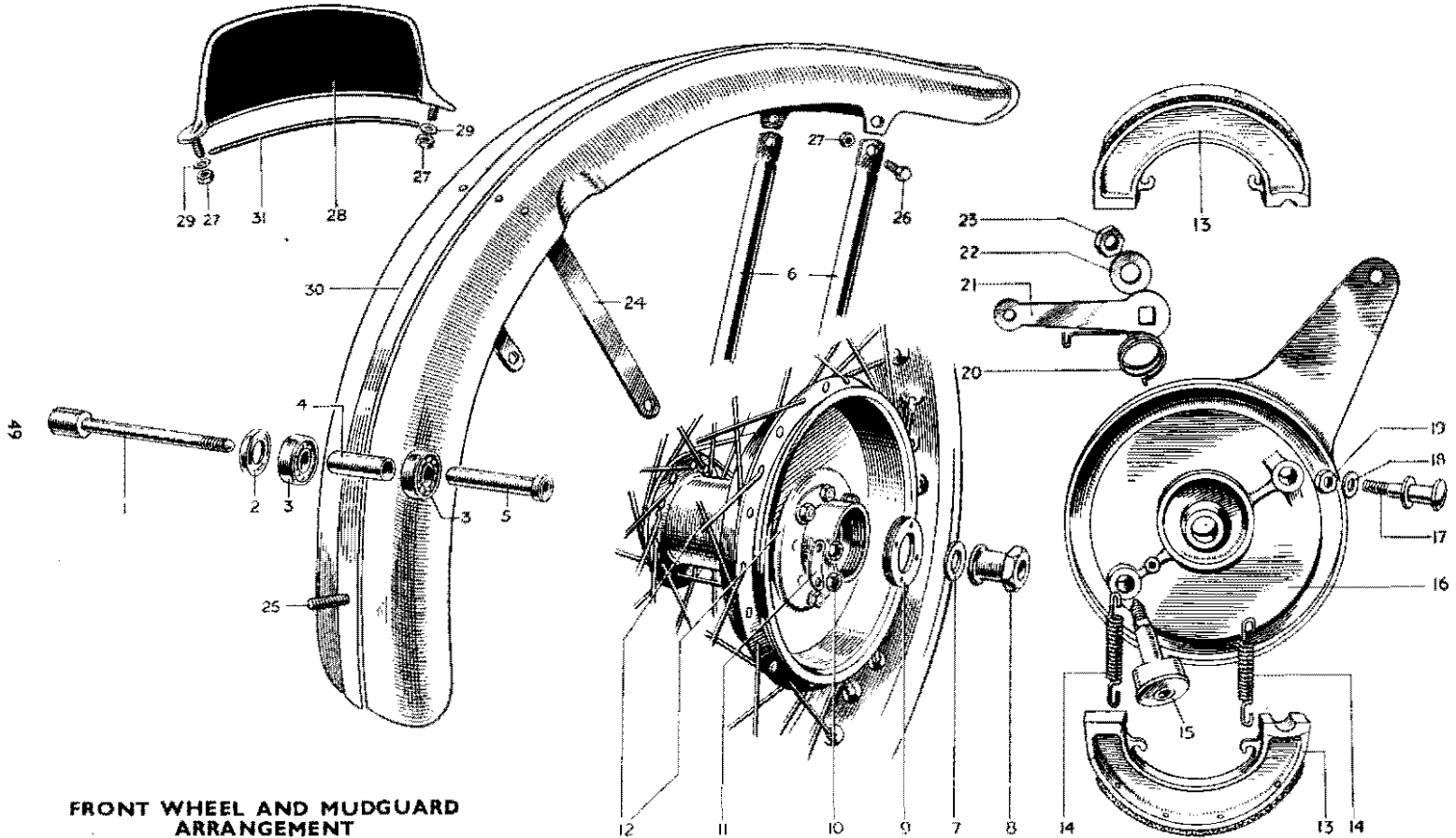

**FRONT WHEEL AND MUDGUARD
ARRANGEMENT**

REF. No.	PART No.	DESCRIPTION	3T	5T	T100
FRONT WHEEL BRAKE					
1	W585	Plate, front brake anchor	1	1	1
2	W588	Pin, " " shoe fulcrum	1	1	1
3	PO172A	Nut, " " " " pin	1	1	1
4	S25-2	Washer, " " " " " "	1	1	1
5	W93	Shoe, " " with lining	2	2	2
6	NW243	Lining, " " shoe	2	2	2
7	W129	Rivets, shoe lining	16	16	16
8	W135	Spring, brake shoe return	2	2	2
9	W386A	Cam assembly, brake	1	1	1
10	W589	Lever, front brake cam	1	1	1
11	S1-S2	Nut, " " " lever	1	1	1
12	S25-6	Washer, " " " nut	1	1	1
13	W592	Spring, " " " return	1	1	1
14	WF32	Pin, " " lever pivot	1	1	1
15		Split pin, pivot pin, $\frac{1}{16}$ " \times $\frac{1}{2}$ "	1	1	1

REAR WHEEL GROUP

16	W595F	Wheel, rear, complete	1	1	1
17	W595E	Wheel, rear, less bearing and brake assembly	1	1	1
18	W79A	Rim, rear wheel	1	1	1
19	NW125X	Spoke, $8\frac{1}{4}$ " \times 9G \times 100°, N.S. and O.S.	20	20	20
20	NW125	Spoke, $8\frac{1}{4}$ " \times 9G \times 76°, N.S. and O.S.	20	20	20
21	TW5	Nipple, spoke	40	40	40
22	W652	Hub, shell assembly	1	1	1
23	W311	Drum, rear brake	1	1	1
24	W62	Bolt, rear hub to brake drum	8	8	8
25	S1-S1	Nut, hub to brake drum bolt	8	8	8
26	W63	Lockplate, nut to brake drum bolt	8	8	8
27	W61	Spindle, rear wheel hub	1	1	1
28	T54Z	Nut, " " " " lock	2	2	2
29	W7A	Bearing, rear wheel ball	2	2	2
30	NW225	Ring, ball bearing backing	2	2	2
31	W12†	Cap, " " dust	2	2	2
32	W6	Collar, taking thrust to chain adjuster	2	2	2
33	W597†	Nut, rear bearing adjusting	1	1	1
34	W4†	" " " " lock	2	2	2
35	W56	Sprocket, rear chain wheel 46T	1	1	1
36	W64	Bolt, " " " sprocket	8	8	8
37	E231Z	Washer, " " " " shakeproof	8	8	8
38	D106	Bolt, tyre security	1	1	1

†See illustration page 51

BRAKE SHOES PROMPTLY RELINED

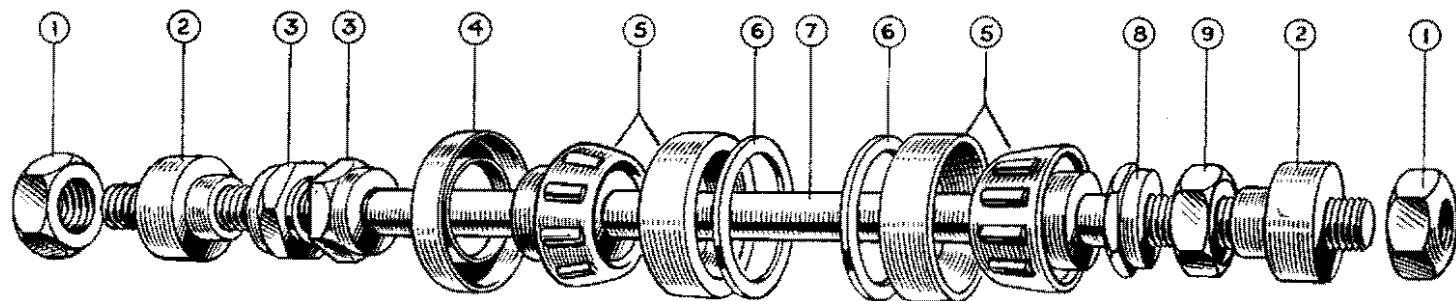

INDEX

Illust. No.	Part No.	Page	Ref.	Illust. No.	Part No.	Page	Ref.
1	TS.42	50	28	6	NW.225	50	30
2	W.6	50	32	7	W.61	50	27
3	W.5	52	3	8	W.597	50	33
4	W.12	50	31	9	W.4	50	34
5	W.7.A	50	29				

REAR WHEEL (RIGID) AXLE ASSEMBLY

This illustration shows the axle assembly arrangement when the speedometer gearbox drive is fitted between numbers 8 and 9. When the drive is taken off the gearbox chain sprocket, number 8 is deleted and another number 9 is added. The dust cover number 4 should also be added between the bearing and nut on the offside.

REF. No. PART No. DESCRIPTION 3T 5T T100

REAR WHEEL BRAKE

REF. No.	PART No.	DESCRIPTION	3T	5T	T100
1	W765*	Plate, rear brake anchor c/w brake shoes	1	1	1
2	W762*	Plate, rear brake anchor	1	1	1
3	W5	Locknut, rear brake anchor plate	2	2	2
4	W764*	Thrower, rear brake drum	1	1	1
5	W93	Shoe assembly, rear with lining	2	2	2
6	NW243	Lining, rear brake shoe	2	2	2
7	W129	Rivet, brake shoe lining	16	16	16
8	W135	Spring, " " return	2	2	2
9	NW234	Cam assembly, rear brake	1	1	1
10	W74A	Lever, rear brake cam	1	1	1
11	S1-52	Nut, " " " lever	1	1	1
12	W123	Spring, " " " " return	1	1	1

*When ordering brake anchor plates for 1947 machines include Part No. W764 to complete conversion.

REAR SPRING WHEEL GROUP

13	W646	Wheel, complete	—	1	1
14	W646A	" " "	1	—	—
15	W645	" less internals	—	1	1
16	W645A	" " "	1	—	—
17	W643	Rim	1	1	1
18	W644	Spoke	40	40	40
19	S79-2	Nipple	40	40	40
20	W600	Hub, shell assembly	1	1	1
21	W605 859	Drum, sprocket and brake	1	1	1
22	W641	Bolt, brake drum	8	8	8
23	F879	Nut, brake drum bolt	8	8	8
24	W642	Lockplate, brake drum bolt	4	4	4
25	W611	Race, outer	2	2	2
26	W610	Race, inner	2	2	2
27	W609	Ball, race caged assembly	2	2	2
28	W601	Plate, hub shell bearing end	1	1	1
29	W744	Shim, end plate	9	9	9
30	W640	Bolt, end plate to hub shell	10	10	10
31	E2312	Washer, end plate to hub shell bolt	10	10	10
32	F879	Nut, end plate to hub shell bolt	10	10	10

STATE FRAME NUMBER FOR SPRING WHEEL SPARES

REF. No.	PART No.	DESCRIPTION	3T	5T	T100
1	W602/3	Box, plunger guide	1	1	1
2	W637	Pad, front slipper (convex)	2	2	2
3	W636	Pad, rear slipper (concave)	2	2	2
4	W638	Screw, slipper pads	8	8	8
5	E.1562	Bolt, plunger guide box	2	2	2
6	T450	Bolt, clamp, plunger guide box	4	4	4
7	E2312	Washer, plunger guide box bolt	6	6	6
8	SI-40	Nut, plunger guide box bolt	6	6	6
9	W791	Axle and guide	1	1	1
10	W616	Block, slipper	2	2	2
11	NW100	Nipple, grease	1	1	1
12	W766	Sleeve, block to axle guide distance	1	1	1
13	W837	Spring, inner main	1	1	1
14	W836	Spring, outer main	1	1	1
15	W838	Spring rebound	1	1	1
16	W658	Buffer, plunger	2	2	2
17	W664	Locator plate, spring	2	2	2
18	W639	Lever, axle shaft anchorage	1	1	1
19	W634	Circlip, axle shaft, split	2	2	2
20	W798	Collar, axle shaft distance O.S.	1	1	1
21	W633	Collar, axle shaft	2	2	2
22	W635	Nut, axle shaft	2	2	2
23	W649	Ring, dust excluder fixing	2	2	2
24	W794	Plate, dust excluder	2	2	2
25	W799	Spring, " "	2	2	2
26	W797	Sleeve, dust excluder centre	2	2	2
27	W648†	Gaiter, dust excluder (rubber)	2	2	2
28	W767†	Sleeve, gaiter centre	2	2	2
29	W632†	Collar, axle shaft distance O.S.	1	1	1

†Early spring wheels had a rubber dust excluder fitted. To fit the metal type the wheel must be modified.

REAR SPRING WHEEL BRAKE

30	W620	Plate, brake anchor	—	1	1
31	W854	" " " "	1	—	—
32	W617	Shoe c/w lining, trailing brake	1	1	1
33	W618	Shoe c/w lining, leading brake	1	1	1
34	W631	Lining, brake	2	2	2
35	W129	Rivets, brake lining	16	16	16
36	W135	Spring, brake shoe return	2	2	2
37	NW234	Cam, brake assembly	1	1	1
38	W74A	Lever, brake cam	1	1	1
39	SI-52	Nut, brake cam lever	1	1	1

STATE FRAME NUMBER FOR SPRING WHEEL SPARES

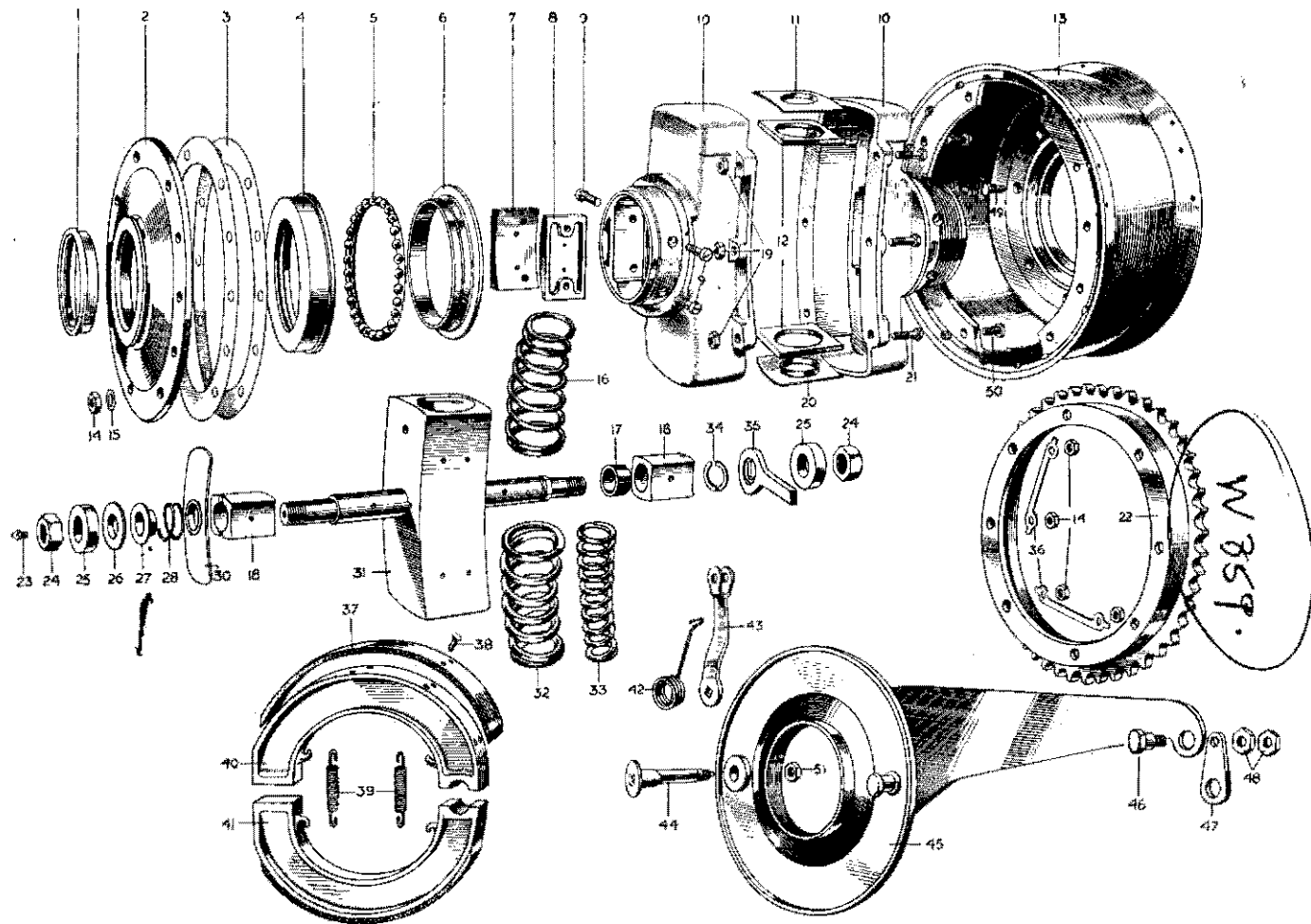

TRIUMPH SPRING WHEEL

REF. No.	PART No.	DESCRIPTION	3T	5T	T100
1	W123	Spring, brake cam return	1	1	1
2	W626	Link, brake anchorage	—	1	1
3	W855	" " "	1	—	—
4	W784	Bolt, brake anchorage link	1	1	1
5	W630	Locknut, brake anchorage bolt	2	2	2
6	W743	Nut, brake pedal spindle	1	1	1
7	$\frac{3}{16}$ " x 1"	Split pin, brake pedal spindle nut	1	1	1
8	F1015B	Rod, brake operating	—	1	1
9	F1015C	Rod, brake operating	1	—	—
10	D106	Bolt, tyre security	1	1	1

INDEX TO ILLUSTRATION PAGE 54

Illust. No.	Part No.	Page	Ref.	Illust. No.	Part No.	Page	Ref.
1	W.649	53	23	27	W.797	53	26
2	W.601	52	28	28	W.799	53	25
3	W.744	52	29	30	W.794	53	24
4	W.611	52	25	31	W.791-W895	53	9
5	W.609	52	27	32	W.836	53	14
6	W.610	52	26	33	W.837	53	13
7	W.636	53	3	34	W.634	53	19
8	W.637	53	2	35	W.639	53	18
9	W.638	53	4	36	W.642	52	24
10	W.602.3	53	1	37	W.631	53	34
11	W.664	53	17	38	W.129	53	35
12	W.658	53	16	39	W.135	53	36
13	W.600	52	20	40	W.618	53	33
14	F.879	52	32	41	W.617	53	32
15	E.2312	52	31	42	W.123	55	1
16	W.838	53	15	43	W.74.A	53	38
17	W.766	53	12	44	NW.234	53	37
18	W.616	53	10	45	W.620	53	30
19	S1-40	53	8		W.854	53	31
20	W.664	53	17	46	W.784	55	4
21	T.450	53	6	47	W.626	55	2
22	W.605	52	21		W.855	55	3
23	NW.100	53	11	48	W.630	55	5
24	W.635	53	22	49	W.641	52	22
25	W.633	53	21	50	W.640	52	30
26	W.798	53	20	51	S1-52	53	39

FOR IDENTIFICATION OF PARTS SEE PAGE 6 FOR INSTRUCTIONS

MUDGUARD GROUP

REF. No.	PART No.	DESCRIPTION	3T	5T	T100
FRONT MUDGUARD (1st CONDITION)					
1	H427	Bridge, mudguard support	1	1	1
2	H411	Stay, mudguard, front	1	1	1
3	H428	Clip, .. support bridge	2	2	2
4	H426	Bolt, clip, N.S.	1	1	1
5	H451	" " .. O.S.	1	1	1
6	PO172A	Nut, " .. bolt	2	2	2
7	S26-1	Washer, " .. " ..	2	2	2
8	F929	Bolt, .. stay to fork end	2	2	2
9	S26-3	Washer, " .. " .. bolt	2	2	2

1st Condition mudguard has stays rivetted on.

When ordering mudguard complete order as 2nd condition.

FRONT MUDGUARD (2nd CONDITION)

10	H566	Mudguard assembly, less front stays	1	1	1
11	H569	Stay, mudguard, front	2	2	2
12	DS57	Bolt, stay	2	2	2
13	F879	Nut, " .. " ..	2	2	2
14	E1612	Washer, " .. " ..	2	2	2

2nd Condition mudguard has stays bolted on.

(Other parts common to 1st condition).

REAR MUDGUARD (1st CONDITION)

15	F1722	Mudguard assembly, rear	1	—	—
16	F1724	" " .. " ..	—	1	1
17	F1723A	Tailguard, rear mudguard with stays	1	—	—
18	F1725A	" " .. " .. " ..	—	1	1
19	DS57	Bolt, tailguard, fixing	2	2	2
20	PF204	Clip, mudguard to frame	2	2	2
21	F444	Plate backing, to clip	2	2	2
22	S23-42	Screw, fixing plate to clip	4	4	4
23	S25-1	Washer, plate to clip screw	4	4	4
24	F1087	Stay, tailguard	1	—	—
25	F939	" " .. " ..	—	1	1
26	F1369	Bolt, tailguard to stay	2	2	2
27	F879	Nut, " .. bolt	2	2	2
28	S26-2	Washer, " .. " ..	2	2	2
29	F1088	Stay, mudguard front	1	—	—
30	F944	" " .. " ..	—	1	1
31	F1088A	" middle	1	—	—
32	F944A	" " .. " ..	—	1	1
33	F946	Stud, mudguard stay to frame junction	2	2	2
34	F947	Nut, for junction stud	2	2	2
35	S25-65	Washer, " .. " ..	2	2	2
36	NF733	Handle, lifting	2	2	2
37	F929	Bolt, lifting handle	4	4	4

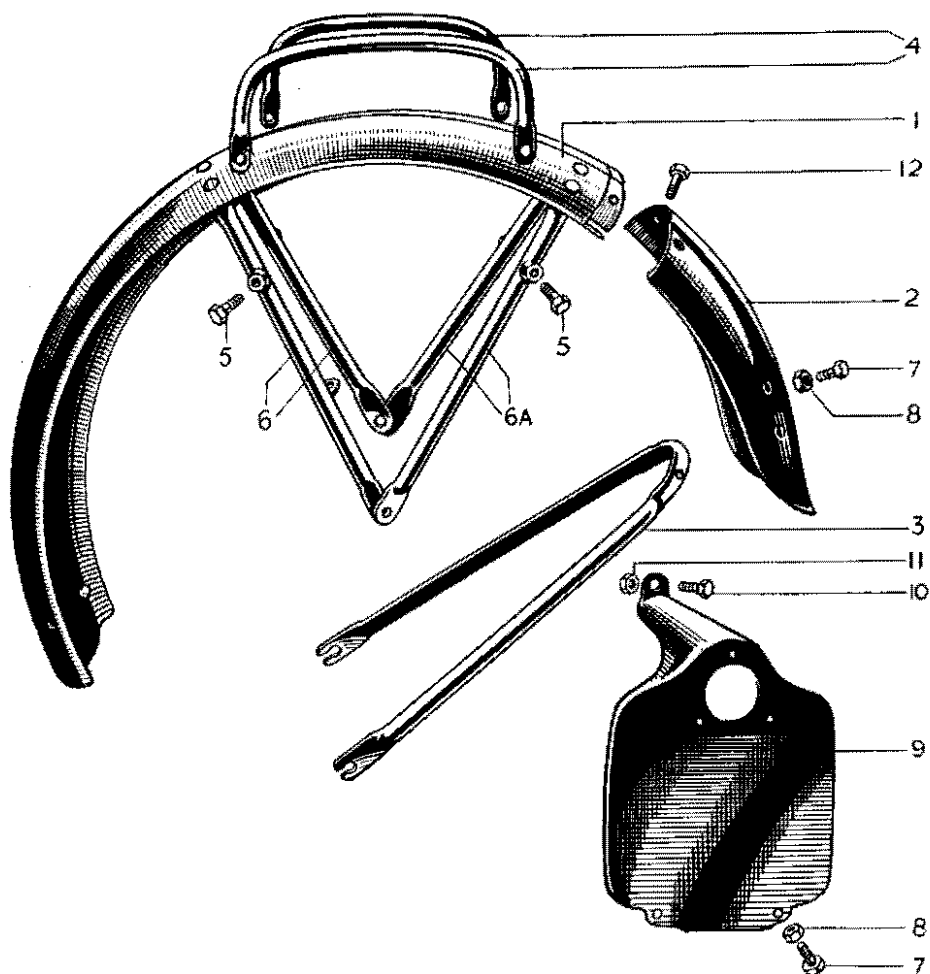

REAR MUDGUARD AND NUMBER PLATE
1st CONDITION

INDEX

Illust. No.	Part No.	Page	Ref.	Illust. No.	Part No.	Page	Ref.
1	F.1722	56	15		F.944	56	30
	F.1724	56	16	6.A	F.1088.A	56	31
	F.1723.A	56	17		F.944.A	56	32
2	F.1725.A	56	18	7	F.1369	56	26
	F.1087	56	24	8	F.879	56	27
3	F.939	56	25	9	F.1822	59	27
4	NF.733	56	36	10	F.929	59	29
5	F.929	56	37	11	S1-S1	59	30
6	F.1088	56	29	12	DS.57	56	19

FOR IDENTIFICATION OF PARTS SEE PAGE 6 FOR INSTRUCTIONS

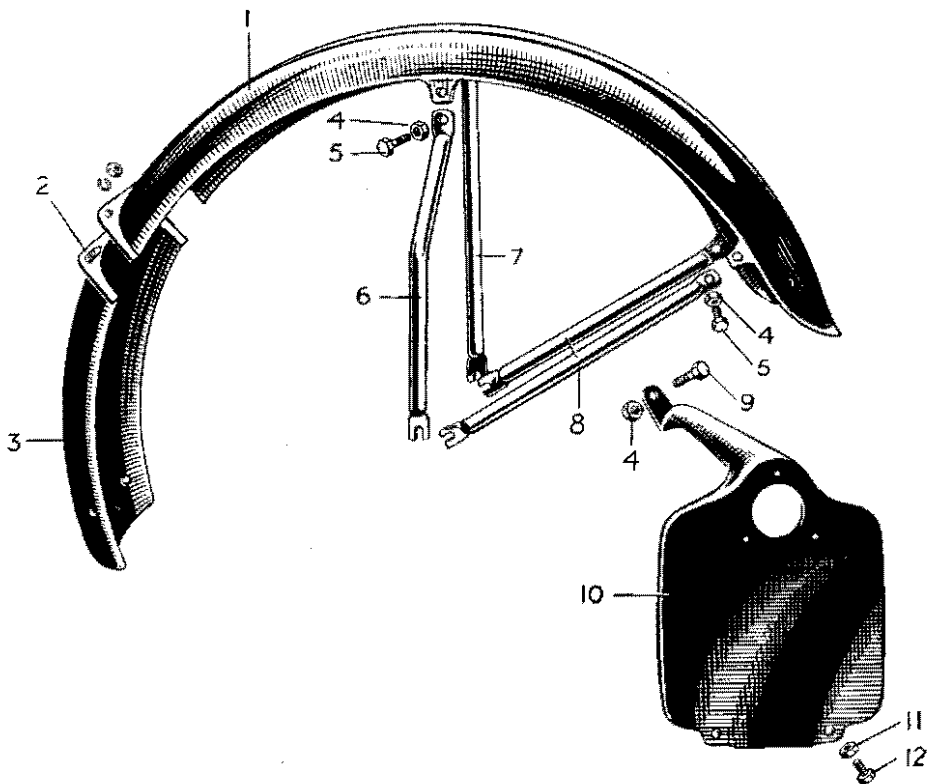

REAR MUDGUARD AND NUMBER PLATE

2nd CONDITION (500 c.c. only)

INDEX

Illust. No.	Part No.	Page	Ref.	Illust. No.	Part No.	Page	Ref.
1	F.2758	59	2	7	F.2763	59	4
2	F.2908	59	13	8	F.2764	59	5
3	F.2756	59	1	9	F.929	59	29
4	SI-51	59	8	10	F.2728	59	28
5	F.2335	59	6	11	F.879	59	33
6	F.2761	59	3	12	F.1369	59	32

FOR IDENTIFICATION OF PARTS SEE PAGE 6 FOR INSTRUCTIONS

REF. No.	PART No.	DESCRIPTION	3T	5T	T100
REAR MUDGUARD (2nd Condition 500 c.c. only)					
1	F2756	Mudguard, front section	—	1	1
2	F2758	" rear "	—	1	1
3	F2761	Stay, centre N.S.	—	1	1
4	F2763	" " O.S.	—	1	1
5	F2764	" rear	—	2	2
6	F2335	Bolt, stay to mudguard	—	4	4
7	E2287	Washer, stay to mudguard bolt	—	4	4
8	S1-51	Nut, " " " "	—	4	4
9	PF204	Clip, mudguard to frame	—	1	1
10	F444	Plate backing, to clip	—	1	1
11	S25-1	Washer, backing plate	—	2	2
12	S23-42	Bolt, " " " "	—	2	2
13	F2908	Stud, mudguard front to rear section	—	2	2
14	E1720	Nut, rear frame to mudguard stay	—	2	2
15	S26-2	Washer, mudguard front to rear section	—	2	2
16	E579	Bolt, rear frame to mudguard stay	—	2	2

NUMBER PLATE GROUP

FRONT NUMBER PLATE (1st Condition)

17	F1914	Plate only, front number	1	1	1
18	F2599	Beading, number plate (chrome)	1	1	1
19	F1933	Stud, number plate beading	2	2	2
20	F879	Nut, " " " stud	2	2	2
21	S26-2	Washer, " " " "	2	2	2
22	H251	Beading, number plate base (rubber)	1	1	1

When ordering number plate complete use 2nd condition.

FRONT NUMBER PLATE (2nd Condition)

23	F2698	Plate assembly, front number (casting)	1	1	1
24	F879	Nut, number plate stud	2	2	2
25	S26-2	Washer, " " " "	2	2	2
26	H251	Beading, " " " base	1	1	1

REAR NUMBER PLATE

27	F1822	Plate, rear number	1	1	1
28	F2728*	" " " "	—	1	1
29	F929	Bolt, number plate top fixing	1	1	1
30	S1-51	Nut, " " " " bolt	1	1	1
31	S26-3	Washer, " " " " " "	1	1	1
32	F1369	Bolt, " " btm. " "	2	2	2
33	F879	Nut, " " " " bolt	2	2	2
34	S26-2	Washer, " " " " " "	2	2	2
35	D68A	Transfer, " " (blue and white)	—	—	1
36	D68	" " " (gold and white)	1	1	—

*See illustration page 58.

TREASURY NOTES MUST BE REGISTERED

PRIMARY CHAINCASE GROUP

REF. No.	PART No.	DESCRIPTION	3T	5T	T100
1	T478A	Cover, chaincase outer	1	—	—
2	T480A	" " " " " " " " " " " "	—	1	1
3	NT367	Plug, " " oil filler	1	1	1
4	NT376	Washer, " " " " plug	1	1	1
5	PCE102F	Plug, " " drain	1	1	1
6	WE170	Washer, chaincase drain plug	1	1	1
7	NT316	Dowel, " " (footrest)	2	2	2
8	T725	Cover, " " inner	1	—	—
9	T483	" " " " " " " " " " " "	—	1	1
10	T484	Plate, " " oil retainer	1	1	1
11	T91	" " " " " " spring	1	1	1
12	T177A	Rivets, " " " " " " plate	2	2	2
13	T496	Adjuster, rear chain oiler	1	1	1
14	T497	Spring, " " " " adjuster	1	1	1
15	T504	Washer, chaincase joint	—	1	1
16	T503	" " " " " " " " " " " "	1	—	—
17	T87	Distance piece, chain cover to frame	—	1	1
18	T200	" " " " " " " " " " " "	1	—	—
19	E427	Screw, chaincase cover (short)	9	9	9
20	E329	" " " " " (long)	3	3	3

CHAINGUARD GROUP

21	T148A	Chainguard, rear upper	1	—	—
22	T148B	" " " " " " " " " " " "	—	1	1
23	T766*	" " " " " " " " " " " "	—	1	1
24	D557	Bolt, chainguard fixing, rear upper	1	1	1
25	S23-37	" " " " " " front upper	1	1	1
26	S25-1	Washer, " " bolt, front and rear	2	2	2
27	F1730	Chainguard, rear lower	—	1	1
28	F1369	Bolt, chainguard fixing lower front	1	1	1
29	F879	Nut, " " " " " " " " " " " "	1	1	1
30	S26-2	Washer, " " " " " " " " " " " "	1	1	1
31	F1760	Bolt, " " " " " " rear	1	1	1
32	S1-52	Nut, " " " " " " " " bolt	1	1	1

(F1760 bolt and S1-52 nut used when pillion footrests are not fitted)

*Used in conjunction with rear mudguard part number F2756/8.

CHAIN GROUP

33	T376	Chain, primary, 74 links	1	—	—
34	D120	" " " solo, 78 links	—	1	1
35	D121	" " " sidecar, 77 links	—	1	1
36	D69	" " rear 90 links	1	—	—
37	D116	" " " " " " " " " " " "	—	1	1
38	I10-046/49	Kit, primary chain spare parts	1	1	1
39	I10-056/59	Kit, rear " " " " " " " " " " " "	1	1	1

*See page 58.

FRONT AND REAR CHAINCASES

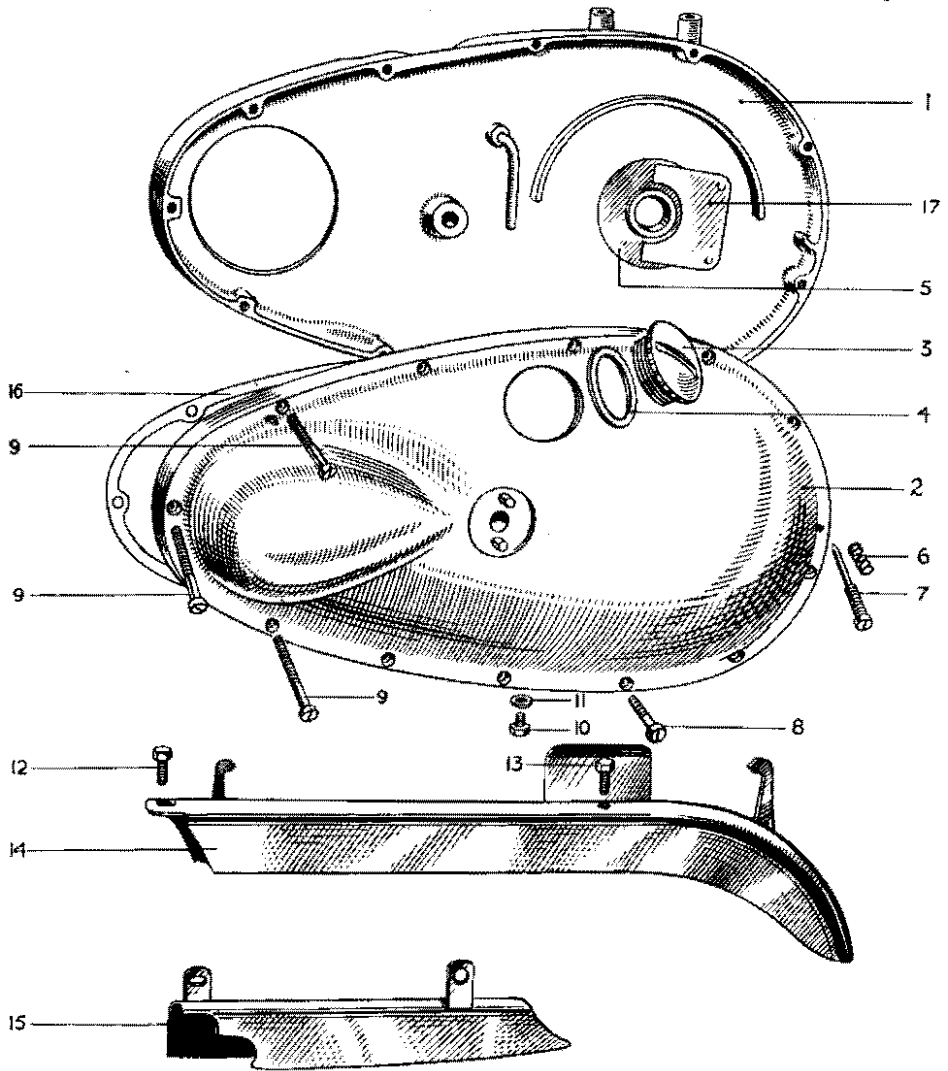

INDEX

Illust. No.	Part No.	Page	Ref.	Illust. No.	Part No.	Page	Ref.
1	T.725	60	8	10	PCE102.F	60	5
	T.483	60	9	11	WE.170	60	6
2	T.478.A	60	1	12	523-37	60	25
	T.480.A	60	2	13	DS.57	60	24
3	NT.367	60	3	14	T.148.B	60	22
4	NT.376	60	4		T.766	60	23
5	T.484	60	10	15	F.1730	60	27
6	T.497	60	14	16	T.503	60	16
7	T.496	60	13		T.504	60	15
8	E.427	60	19	17	T.91	60	11
9	E.329	60	20				

FRONT AND REAR CHAIN CASES

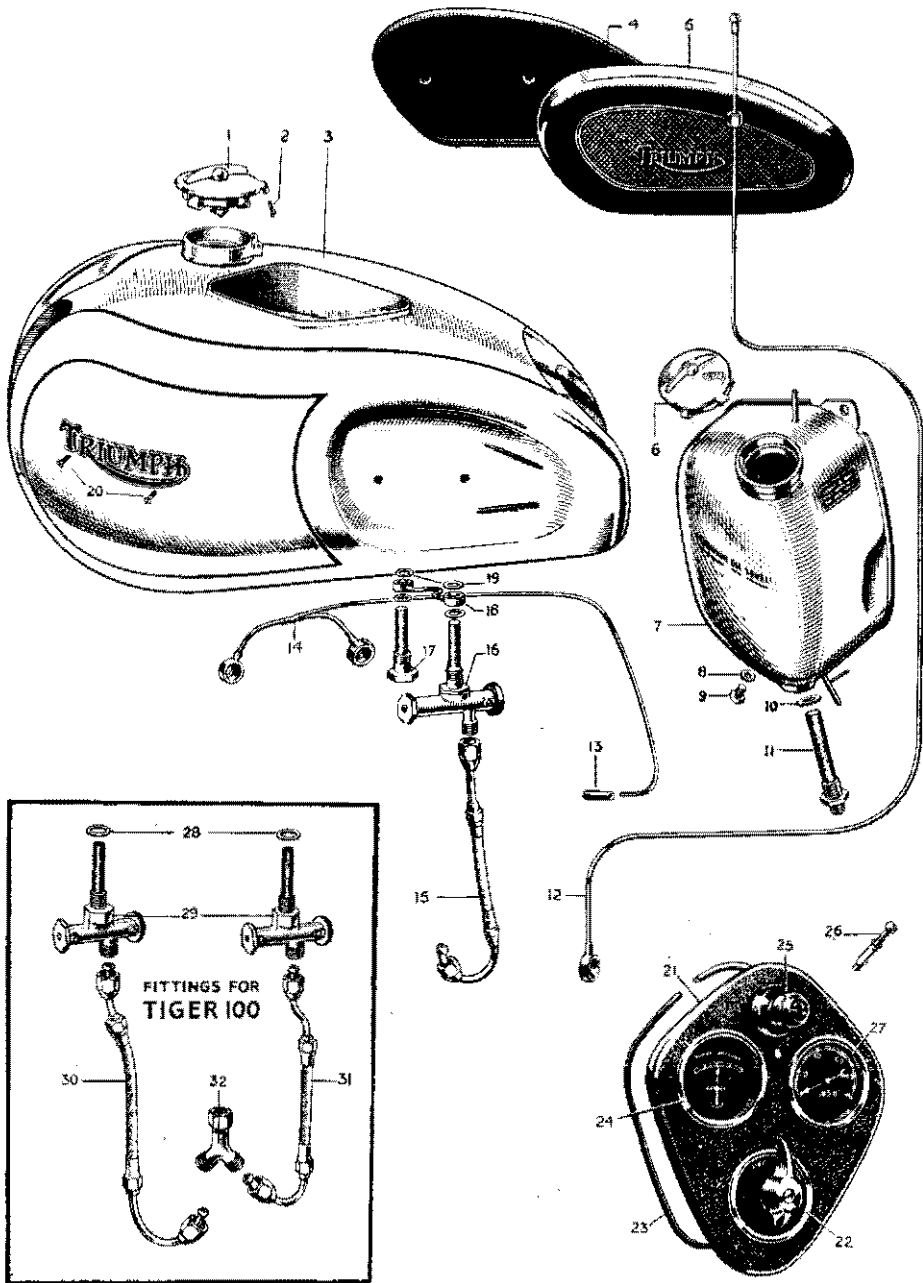

PETROL AND OIL TANKS WITH FITTINGS

TANK GROUP

REF. No.	PART No.	DESCRIPTION	3T	5T	T100
PETROL TANK					
<i>NOTE:—It is important when ordering tank to state model of machine and finish.</i>					
1	F1930	Tank, petrol	—	—	1
2	F1930R	" "	—	1	—
3	F1845	" "	1	—	—
4	F1034	Cap assembly, petrol tank filler	1	1	1
5		Split pin, filler cap, 1" x 3/8"	1	1	1
6	F1823	Name plate, petrol tank	—	—	2
7	F1823B	" " " "	—	2	—
8	F1823C	" " " "	2	—	—
9	F1915	Screw, name plate	4	4	4
10	F1717	Tap, petrol	1	—	2
11	F2124	" "	—	1	—
12	F1511	Washer for petrol tap	1	1	2
13	F1721	"U" pipe, petrol tap	1	—	—
14	F2175	Pipe, petrol feed	1	—	—
15	F2123	" " " "	—	1	—
16	F2527	" " " N.S.	—	—	1
17	F2528	" " " O.5.	—	—	1
18	F2529	"Y" adaptor assembly, at carburettor	—	—	1
19	F2120	Pipe, connecting assembly	—	1	—
20	F2593	Adaptor for connecting pipe	—	1	—
21	GS367	Washer, connecting pipe	—	3	—

INDEX TO ILLUSTRATION ON PAGE 62

Illust. No.	Part No.	Page	Ref.	Illust. No.	Part No.	Page	Ref.
1	F.1034	63	4	15	F.2123	63	15
2	3.32" pin	63	5		F.2175	63	14
3	F.1930	63	1	16	F.2124	63	11
	F.1930.R	63	2		F.1717	63	10
	F.1845	63	3	17	F.2593	63	20
4	F.2552	64	3	18	F.2120	63	19
	F.1605	64	1	19	F.1511	63	12
5	F.2551	64	4	20	F.1915	63	9
	F.1606	64	2	21	F.2091	81	34
6	F.1034	64	18	22	351,552	81	37
7	F.1909.A	64	16	23	F.2445	81	36
	F.1645.A	64	15	24	360,00A	81	40
8	PT.104.B	64	21	25	062,219.A	81	39
9	F.1792	64	20	26	F.2577	81	35
10	F.1713	64	31	27	F.2472	81	41
11	F.1838	64	30	28	F.1511	63	12
12	F.1948	27	27	29	F.1717	63	10
13	E.1947	27	26	30	F.2527	63	16
14	E.1937	27	24	31	F.2528	63	17
	E.1937.A	27	25	32	F.2529	63	18
	E.1781	27	23				

FOR IDENTIFICATION OF PARTS SEE PAGE 6 FOR INSTRUCTIONS

REF. No.	PART No.	DESCRIPTION	3T	5T	T100
1	F1605	Pad, knee grip, O.S.	1	—	—
2	F1606	" " " N.S.	1	—	—
3	F2552	" " " O.S.	—	1	1
4	F2551	" " " N.S.	—	1	1
5	F1607A	Plate, knee grip pad, O.S.	1	—	—
6	F1607	" " " N.S.	1	—	—
7	T361	Screw, " " " plate	4	—	—
8	F1953	" " " " " "	—	4	4
9	S25-1	Washer, " " " " screw	—	4	4
10	F966	Bolt, petrol tank fixing	4	2	2
11	F1808	" " " " front	—	2	2
12	S25-27	Washer, " " " bolt	4	4	4
13	F967	Pad, " " rubber	8	6	6
14	F1813	" " " " "	—	2	2

OIL TANK

15	F1645A	Tank, oil, complete, with screwed filler	1	1	—
16	F1909A	" " " " hinged filler	—	—	1
17	E370A	Cap, oil tank filler	1	1	—
18	F1034	" " " " c/w washer	—	—	1
19	E1331	Washer, oil tank filler cap	1	1	—
20	F1792	Plug, " " drain	1	1	1
21	PT104B	Washer, " " " plug	1	1	1
22	F1758	Tube, " " " (rubber)	1	1	1
23	F929	Bolt, oil tank to bridge clip	1	1	1
24	F1213	" " " " seat tube clip	1	—	1
25	F2596	" " " " " " "	—	1	—
26	F1335	Distance washer, oil tank to seat tube bolt	1	—	—
27	F2597	" " " " " " "	—	1	—
28	F1682	Stud, oil tank to seat tube	1	1	1
29	S1-51	Nut, " " " " " stud	1	1	1
30	F1838	Filter, oil tank	1	1	1
31	F1713	Washer, oil tank filter	1	1	1
32	F1919	Pipe, feed assembly, top half	—	1	1
33	F1839	" " " " " " "	1	—	—
34	S63-F	Union nut, feed pipe assembly	1	1	1
35	E1958	Oil pipes and block oil tank to engine	—	—	1
36	E1526	" " " " " " " "	—	1	—
37	E2457	" " " " " " " "	1	—	—
38	E1529	Washer, oil pipe block joint	1	1	1
39	S1-51	Nut, oil pipe block	1	1	1
40	S25-3	Washer, oil pipe block stud	1	1	1
41	MF119	Connection, oil tank to oil pipe	2	2	2

ALWAYS GIVE COLOUR WHEN ORDERING A TANK

HANDLEBAR GROUP

REF. No.	PART No.	DESCRIPTION	3T	5T	T100
HANDLEBAR					
1	H241	Handlebar, complete with controls and twist grip ...	1	1	1
2	H225	Handlebar bend only	1	1	1
3	H230	Grip, dummy rubber, L.H.	1	1	1
THROTTLE CONTROL					
4	H240	Twist grip assembly	1	1	1
5	H230	Grip, twist rubber	1	1	1
6	H228	Head, twist grip	1	1	1
7	H237	Grub screw, twist grip	1	1	1
8	H231/29	Sleeve, twist grip	1	1	1
9	H233	Plate, twist grip retaining	2	2	2
10	H232	Circlip, twist grip plate	1	1	1
11	H235	Plunger, twist grip	1	1	1
12	H236	Spring, twist grip plunger	1	1	1
13	H234	Thimble, twist grip cable	1	1	1
FRONT BRAKE CONTROL					
14	18/547	Lever, control assembly	1	1	1
15	18/535	Lever only	1	1	1
16	18/174	Bracket, lever	1	1	1
17	12/044	Clamp, bracket lever	1	1	1
18	11/014	Screw, lever clamp	2	2	2
19	18/087	Pin, lever fulcrum	1	1	1
20	18/053	Nut, ,, ,, pin	1	1	1
21	70/016	Washer ,, ,, ,,	1	1	1
CLUTCH CONTROL					
22	18/546	Lever, control assembly	1	1	1
23	18/528	Lever only	1	1	1
24	18/174	Bracket, lever	1	1	1
25	12/044	Clamp, bracket lever	1	1	1
26	11/014	Screw, lever clamp	2	2	2
27	18/087	Pin, lever fulcrum	1	1	1
28	18/053	Nut, ,, ,, pin	1	1	1
29	70/016	Washer ,, ,, ,,	1	1	1

FIGURE IN MODEL COLUMN DENOTES QUANTITY PER MACHINE

HANDLEBARS AND CONTROLS

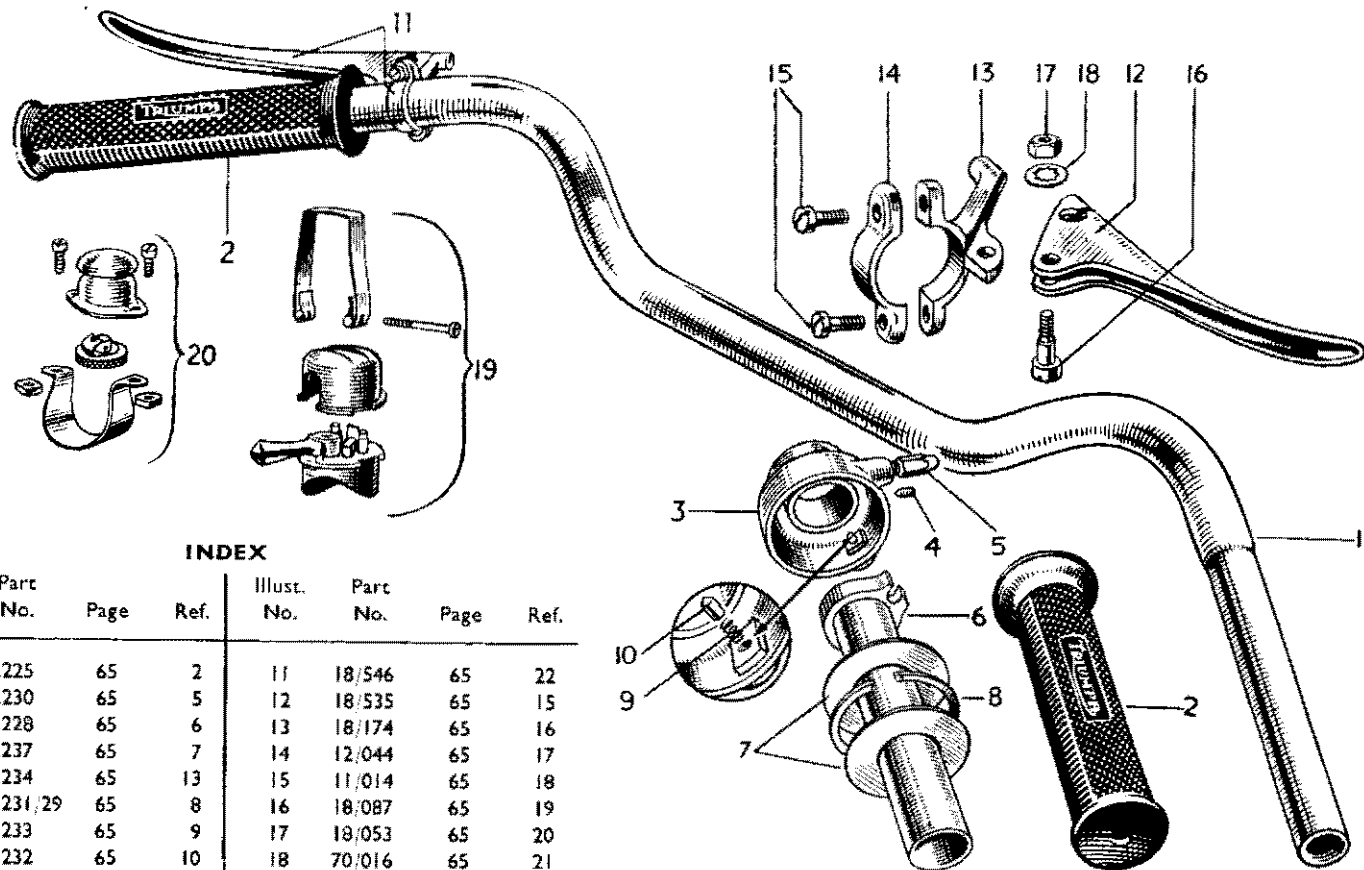

99

INDEX

Illust. No.	Part No.	Page	Ref.	Illust. No.	Part No.	Page	Ref.
1	H.225	65	2	11	18/546	65	22
2	H.230	65	5	12	18/535	65	15
3	H.228	65	6	13	18/174	65	16
4	H.237	65	7	14	12/044	65	17
5	H.234	65	13	15	11/014	65	18
6	H.231/29	65	8	16	18/087	65	19
7	H.233	65	9	17	18/053	65	20
8	H.232	65	10	18	70/016	65	21
9	H.236	65	12	19	380.057	83	1
10	H.235	65	11	20	762.080	83	5

CONTROL CABLE GROUP

REF. No.	PART No.	DESCRIPTION	3T	5T	T100
CLUTCH CABLE					
1	D203/X	Cable assembly, clutch	1	1	1
2	D203/W	Wire only, clutch	1	1	1
3	D203C	Cable only, clutch	1	1	1
4	D103	Ferrule, clutch casing	2	2	2
5	D81	Nipple, clutch wire (handlebar end)	1	1	1
6	DS73	Nipple (gearbox end)	1	1	1
7	DS74	Adjuster, clutch cable	1	1	1
8	W76	Locknut, clutch cable adjuster	1	1	1
FRONT BRAKE CABLE					
9	D204:X	Cable assembly, brake	1	1	1
10	D204W	Wire only, brake	1	1	1
11	D204C	Casing only, brake	1	1	1
12	D103	Ferrule, brake casing	2	2	2
13	D81	Nipple, brake wire (handlebar end)	1	1	1
14	H446	Tube, brake wire	1	1	1
15	W593	Fork end, brake wire	1	1	1
16	H447	Cable end, brake	1	1	1
17	W328	Adjuster, cable	1	1	1
18	W591	Abutment, cable adjuster	1	1	1
19	W329	Thumb nut, cable adjuster	1	1	1
THROTTLE CABLE					
20	D89:X	Cable assembly, throttle	—	1	1
21	D78:X	" " "	1	—	—
22	D89W	Wire only, throttle	—	1	1
23	D78W	" " "	1	—	—
24	D89C	Casing only, throttle	—	1	1
25	D78C	" " "	1	—	—
26	D101	Ferrule, throttle casing	2	3	3
27	D83	Nipple, throttle (handlebar end)	1	1	1
28	NS191	Nipple, throttle	1	1	1
29	D104	Cable, adjuster assembly	—	1	1
30	XA69	Clip for cables	8	8	8

REAR BRAKE CONTROL GROUP

31	F1153	Pedal, rear brake	1	1	1
32	F995	Rubber, brake pedal	1	1	1
33	F1149	Screw, " " stop	1	1	1
34	F879	Nut, " " " screw	1	1	1
35	F867	Spindle, " "	1	1	1
36	DS48	Nut, " " spindle to frame	1	1	1

SEE SPECIMEN ORDER IN PREFACE

REF. No.	PART No.	DESCRIPTION	3T	5T	T100
1	F1729A	Cover, saddle	—	1	1
2	F1897A	" "	1	—	—
3	F847	Stud, saddle spring to frame	2	2	2
4	W76	Nut, " stud	8	8	8
5	S25-2	Washer, " "	6	6	6
6	NA64J	Saddle nose nut and bolt	1	1	1

PROP STAND GROUP

7	F2611	Prop stand complete	1	—	—
8	F2612	" " " "	—	1	1
9	F2604	Lug, pivot	1	—	—
10	F2606	" " " "	—	1	1
11	F2607	Pin, swivel	1	1	1
12	F2608	Peg, spring anchorage	1	1	1
13	F2603	Bolt, lug clamp	2	1	1
14	F2605	" " " "	—	1	1
15	F2609	Leg, prop stand	1	1	1
16	F2610	Spring, leg tension	1	1	1

SIDECAR ATTACHMENTS GROUP

17	F2587	Lug, bottom front connection	—	1	1
18	F2602	" " " " (export R.H.)	—	1	1
19	F1746	Nut, " " " sleeve	—	2	2
20	F2600	Bolt, " " " "	—	1	1
21	F1747	Nut, " " " bolt	—	1	1
22	F2601	Lug, rear connection	—	1	1
23	F1743	Stud, " " " "	—	2	2
24	S1-5	Nut, " " stud	—	2	2
25	KF365	Washer, " " " "	—	2	2

REAR CARRIER GROUP

For F1722 and F1724 mudguards					
26	NX220	Carrier, rear	1	1	1
27	F929	Bolt, fixing	4	4	4
For F2756/8 mudguard					
28	F2278	Carrier, rear	—	1	1
29	F2856	Bridge, carrier	—	2	2
30	F2857	Plate, " backing	—	2	2
31	D557	Bolt, " " " "	—	8	8
32	E1612	Washer, " " " "	—	8	8
33	F879	Nut, " " " "	—	8	8

PILLION SEAT GROUP

34	NF761	Seat, pillion, complete	1	1	1
35	S23-42	Bolt, pillion seat fixing	4	4	4
36	S4-9	Nut, " " bolt	4	4	4
37	S25-1	Washer, " " " "	4	4	4

TOOL BOX GROUP

REF. No.	PART No.	DESCRIPTION	3T	5T	T100
1	FI692	Tool box, complete	1	1	1
2	FI735	Ring, sealing	1	1	1
3	FI850	Screw, fastener complete	1	1	1
4	WF352	Circlip, fastener screw	1	1	1
5	FI700	Clip, toolbox to frame	2	1	1
6	FI699	" " " frame	—	1	1
7	DS57	Bolt, " " " clip	2	2	2
8	F879	Nut, " " " " bolt... ..	2	2	2
9	526-2	Washer " " " " "	2	2	2

TOOL KIT GROUP

10	DA71	Tool roll complete	—	1	1
11	D209	" " " " "	1	—	—
12	DA72	Spanner, .920" × 1.010", open	1	1	1
13	KA50	" .375" × .338", " " " " "	1	1	1
14	NA55	" .600" × .525", " " " " "	1	1	1
15	DA16	" .820" × .712", " " " " "	1	1	1
16	NA66	" .600" × .448", closed	1	1	1
17	PA57	" .919" × 1.011", " " " " "	1	1	1
18	PA60	" box, complete	1	1	1
19	D215	" 1/4" Whit. hex., closed	1	—	—
20	DAS	" rocker adjusting screw	1	1	1
21	NA65	" .448" hex. × .218" sq.	—	1	1
22	PA56	" combination	1	1	1
23	DA21	Bar, tommy	1	1	1
24	DA87	Spanner, sparking plug	1	1	1
25	DA70	Key, clutch adjusting	1	1	1
26	DAS01	Extractor, clutch centre	1	1	1
27	NA12	Gun, grease	1	1	1
28	NA14A	Lever, tyre	1	1	1
29	PA55	Screwdriver	1	1	1
30	167	Extractor, chain rivet <i>(not included in tool kit)</i>	1	1	1
31	WAS8	Roll, tool	1	1	1
32	D49	Inflator, tyre	1	1	1

SEE SPECIMEN IN PREFACE

SPEEDOMETER GROUP

REF. No.	PART No.	DESCRIPTION	3T	5T	T100
1	CP71	Speedometer 120 m.p.h. trip, cpte.	—	1	1
2	CP72	" " " " " (with rev. ind.)	—	1	1
3	CP73	" 80 m.p.h. trip, cpte.	1	—	—
4	CP80	" " " " " (with rev. ind.)	1	—	—
5	CP75	" 140 kilo " " "	1	—	—
6	CP76	" 180 " " " "	—	1	1
7	S433/3/L	" 120 m.p.h. trip, head only	—	1	1
8	S464/3/L	" " " " " " (with rev. indicator)	—	1	1
9	S433/1/L	" 80 m.p.h. trip, head only	1	—	—
10	S464/1/L	" " " " " " (with rev. indicator)	1	—	—
11	S433/5/L	" 140 kilo trip, head only	1	—	—
12	S433/7/L	" 180 kilo " " "	—	1	1
13	DS40	Bracket, speedometer mounting	1	1	1
14	DS57	Screw, speedometer mounting bracket	2	2	2
15	S26-2	Washer, speedometer mounting bracket	2	2	2
16	P53279/1	Bulb holder complete, speedometer	1	1	1
17	P52305	Bulb, speedometer	1	1	1

SPEEDOMETER DRIVE FROM REAR WHEEL

18	D175	Gearbox, speedometer rear wheel	1	1	1
19	D176	Cable, speedometer drive (54" long)	—	1	1
20	D176A	" " " (52" long)	1	—	—

SPEEDOMETER DRIVE FROM GEARBOX

21	T810	Gearbox, speedometer drive	1	1	1
22	T752	Pinion	1	1	1
23	T753	Gear wheel	1	1	1
24	T756	Screw	2	2	2
25	D176B	Cable, speedometer (49" long)	1	1	1

Fitted to 3T from frame No. TL9153

Fitted to 5T and T100 from frame No. TF19577

SPARKING PLUG

26	F80	Plug, sparking (K.L.G.)	—	—	2
27	H14	Plug, sparking (Lodge)	—	2	—
28	L10S	Plug, sparking (Champion)	2	—	—
29	D10S	Cover, sparking plug	2	2	2

CARBURETTOR GROUP

REF. No.	PART No.	DESCRIPTION	3T	5T	T100
1	D205	Carburettor complete	1	—	—
2	D207	" " " " " " " " " " "	—	1	—
3	D212	" " " " " " " " " "	—	—	1
4	275/014R	Chamber, mixing	1	—	—
5	276/410R	" " " " " " " " " "	—	1	—
6	276/411R	" " " " " " " " " "	—	—	1
7	4/031	Cap, mixing chamber	1	—	—
8	6/031	" " " " " " " " " "	—	1	1
9	4/062	Nut, mixing chamber union	1	—	—
10	6/062	" " " " " " " " " "	—	1	1
11	4/235	Spring, mixing chamber cap	1	—	—
12	6/248	" " " " " " " " " "	—	1	—
13	4/276	" " " " " " " " " "	—	—	1
14	4/241	Screw, mixing chamber cap spring	1	1	1
15	5/503	Air valve, assembly	1	—	—
16	6/417	" " " " " " " " " "	—	1	1
17	30/064	Clip, air slide	1	1	1
18	5/074/5/4	Valve throttle	1	—	—
19	6/074/6/3	" " " " " " " " " "	—	1	1
20	4/263	Spring, throttle valve	1	1	1
21	4/063	Screw, throttle valve adjusting	1	1	1
22	16/010	Nut, throttle valve adjusting screw	1	1	1
23	13/129	Screw, air adjusting	1	1	1
24	4/148	Spring, air adjusting screw	1	1	1
25	4/042	Jet, main No. 120	1	—	—
26	4/042	" " " " 140	—	1	—
27	4/042	" " " " 160	—	—	1
28	205/058R	Block, jet	1	—	—
29	206/057R	" " " " " " " " " "	—	1	—
30	206/058R	" " " " " " " " " "	—	—	1
31	4/040	Washer, jet block	1	—	—
32	6/040	" " " " " " " " " "	—	1	1
33	4/061	Jet, for needle (.107)	1	1	1
34	5/065	Needle for jet (No. 5)	1	—	—
35	6/065	" " " " (No. 6)	—	1	1
36	4/230	Clip, jet needle	1	1	1
37	4/043	Bolt, holding	1	1	1
38	4/053	Washer, holding bolt	2	2	2
39	204/038R	Tube, air intake	1	—	—
40	206/038R	" " " " " " " " " "	—	1	1
41	4/035	Adjuster, throttle cable	1	—	—
42	1A	Chamber, float (complete)	1	—	—
43	1AT	" " (" ") " " " " " "	—	1	1

ENGINE NUMBER IS IMPRESSED ON DRIVING SIDE OF CRANKCASE

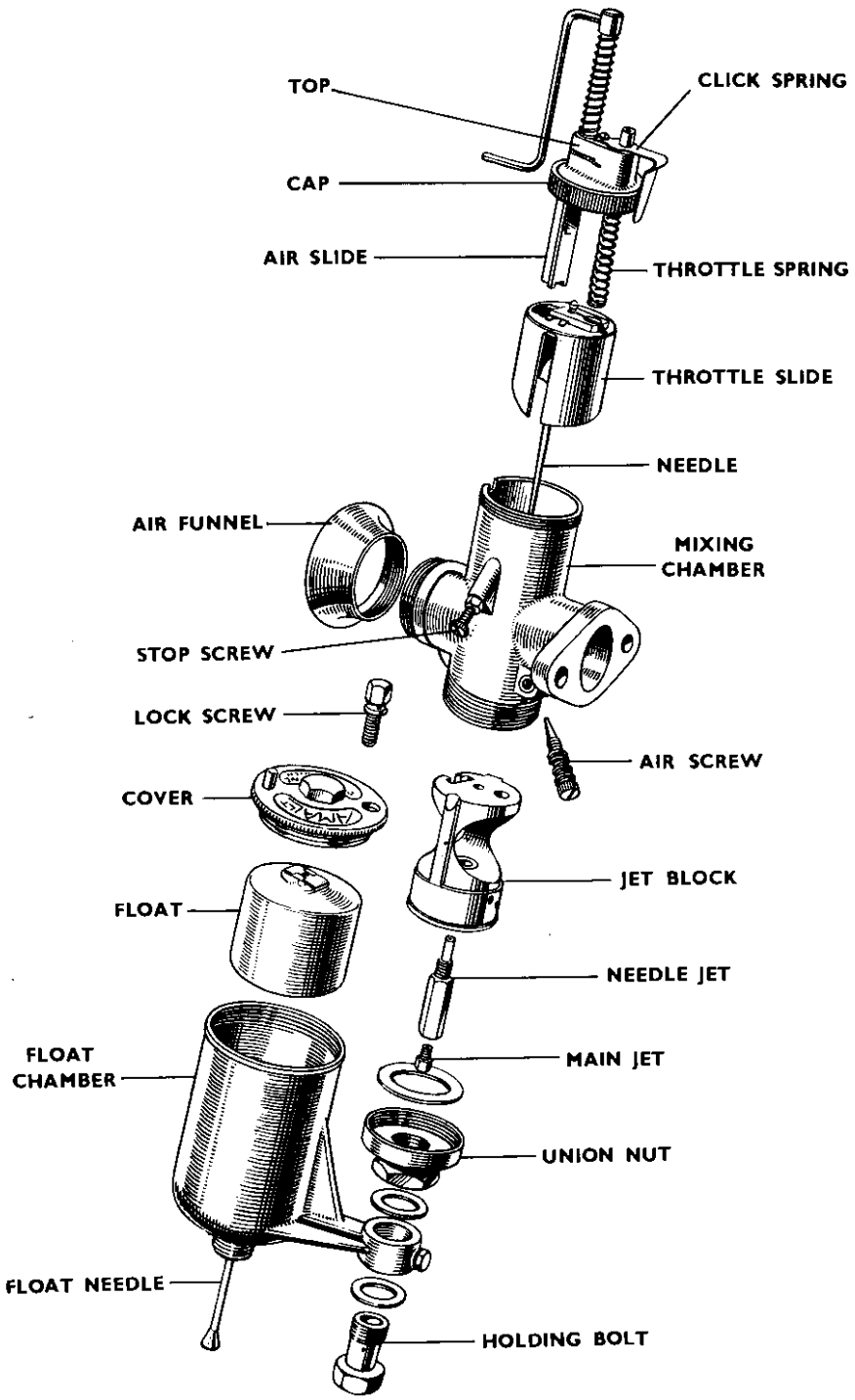

AMAL CARBURETTOR PARTS

REF. No.	PART No.	DESCRIPTION	3T	5T	T100
1	64.156	Body, float chamber	1	—	—
2	64.192	" " "	—	1	1
3	14.208	Cover, " "	1	1	1
4	14.021	Lock-screw, float cover	1	1	1
5	14.015	Float	1	1	1
6	14.024	Needle, valve	1	1	1
7	14.209	Tickler	1	1	1
8	14.210	Stop, tickler	1	1	1
9	14.032	Spring, "	1	1	1
10	4.060	Cotter, "	1	1	1
11	13.153	Screw, platform plug	1	1	1
12	14.039	Washer, platform plug screw	1	1	1
13	14.178	Locknut, seating	1	1	1
14	14.175	Washer, seating locknut	1	1	1
15	14.042	Nut, petrol union	1	1	1
16	14.026	Nipple, petrol union	1	1	1
17	6.132	Ferrule, mixing chamber top	—	1	1
18	NA48	Washer, carburettor flange	1	—	—
19	NA43	" " "	—	1	—
20	NA43A	" " "	—	—	1

MAGNETO (B.T.H.) GROUP

21	D152	Magneto, less auto advance	1	1	1
22	CZ87157-G2	Housing, magneto main	1	1	1
23	SKC741-G1	Ball race	2	2	2
24	SKC6123-1	Insulation washer, ball race	2	2	2
25	CR22186-1	Washer, bearing adjusting	1	1	1
26	CR22315-1	Washer, oil retaining	1	1	1
27	CR23042-1	Magnet	1	1	1
28	SKC6245-1	Screw, magnet locating	2	2	2
29	SKC24291-1	Cover, magnet	1	1	1
30	3BA $\frac{1}{16}$ " Rd. Hd.	Screw, magnet cover fixing	2	2	2
31	SKC9952-8	Washer, magnet cover fixing	2	2	2
32	CR23290-1	Screw, safety gap	1	1	1
33	SKC67991-1	Tab, safety gap screw locking	1	1	1
34	SKC87159-G1	Holder, collector brush	2	2	2
35	SKC6306-G2	Collector brush and spring	2	2	2
36	CR87404-1	Washer, collector holder sealing	2	2	2
37	CR87160-1	Nut, collector holder ring	2	2	2
38	CZ60707-G19	Cable, H.T.	2	2	2
39	SKC6397-1	Screw, H.T. cable securing	2	2	2
40	E2415	Clip, H.T. cable	1	1	1
41	CR87403-1	Ferrule, collector holder rubber	2	2	2
42	CY50495-G1	Armature c/w condenser and end plate	1	1	1
43	SKC6115-1	Screw, armature end plate to core	4	4	4
44	SKC6111-1	Dowel, armature end plate locating	1	1	1

DO NOT FORGET TO SIGN YOUR ORDER

REF. No.	PART No.	DESCRIPTION	3T	5T	T100
1	SKC6114-1	Screw, armature end plate securing	4	4	4
2	SKC6112-1	Dowel, armature end plate locating	1	1	1
3	CY52078-G3	Condenser, assembly	1	1	1
4	SKC6636-1	Insulation, condenser (large)	2	2	2
5	SKC6637-1	Insulation, condenser (small)	2	2	2
6	4BAX $\frac{1}{8}$ "ch.hd.	Screw, condenser securing	2	2	2
7	SKC9952-6	Washer, condenser screws	2	2	2
8	CR20776-1	Bush, condenser insulating	1	1	1
9	SKC6612-G1	Slip ring	1	1	1
10	SKC6122-1	Washer, slip ring, plain	1	1	1
11	SKC6180-1	Washer, slip ring, spring	1	1	1
12	CR20774-1	Ring, reinforcing	1	1	1
13	CX1883-G24	Contact breaker L.H. complete	1	1	1
14	SKC74955-G2	Base and check spring assembly, contact breaker ...	1	1	1
15	CZ63472-G2	Lever contact and springs	1	1	1
16	SKC6215-1	Spring, contact breaker run forcing	2	2	2
17	SKC6208-1	Screw, contact breaker spring	2	2	2
18	CR29708-1	Wick, contact breaker lever	1	1	1
19	SKC29303-G1	Contact, adjustable screw	1	1	1
20	SKC6216-1	Nut, adjustable screw contact	1	1	1
21	SKC9952-8	Washer, adjustable screw contact	1	1	1
22	SKC6235-1	Block, contact screw locating	1	1	1
23	SKC6213-1	Strip, insulating block	1	1	1
24	SKC6209-1	Screw, block securing	1	1	1
25	SKC6210-1	Bush, screw insulating	1	1	1
26	SKC6212-1	Bush, block centre	1	1	1
27	SKC6219-G1	Brush and spring contact breaker earthing ...	1	1	1
28	SKC6214-1	Spring, contact breaker main	1	1	1
29	CR29487-1	Screw, contact breaker securing	1	1	1
30	CZ61580-1	Cover complete, contact breaker	1	1	1
31	SKC28537	Cover only, contact breaker	1	1	1
32	CR89533-1	Bush, contact breaker, cover insulating	1	1	1
33	CR29456-1	Strip, contact breaker, cover insulating	1	1	1
34	CR29455-1	Strip, contact breaker cover contact	1	1	1
35	CR29459-1	Terminal, contact breaker cover contact	1	1	1
36	4BA Strd.	Washer, contact breaker terminal, plain	3	3	3
37	SKC9952-6	Washer, contact breaker terminal, spring	2	2	2
38	CR26513	Nut, contact breaker terminal, lock	1	1	1
39	CR89927-1	Nut, contact breaker terminal, knurled	1	1	1
40	SKC88939-6	Washer, contact breaker terminal knurled nut ...	1	1	1
41	CR28540-1	Washer, contact breaker cover sealing	1	1	1
42	CR28571-1	Screw, contact breaker cover securing	3	3	3
43	SKC9952-6	Washer, contact breaker cover screw	3	3	3
44	SKC33650	Cam, ring	1	1	1
45	SKC6344-1	Wick, cam lubricating	1	1	1
46	SKC28544-G3	Housing, cam ring	1	1	1
47	2BAX $\frac{1}{2}$ "inst.hd.	Screw, cam ring housing	4	4	4
48	SKC88939-20	Washer, cam ring housing lock	4	4	4
49	CR26381-1	Screw, timing stop	1	1	1

ALWAYS QUOTE PART NUMBER

B.T.H. MAGNETO HOUSING AND AUTO ADVANCE

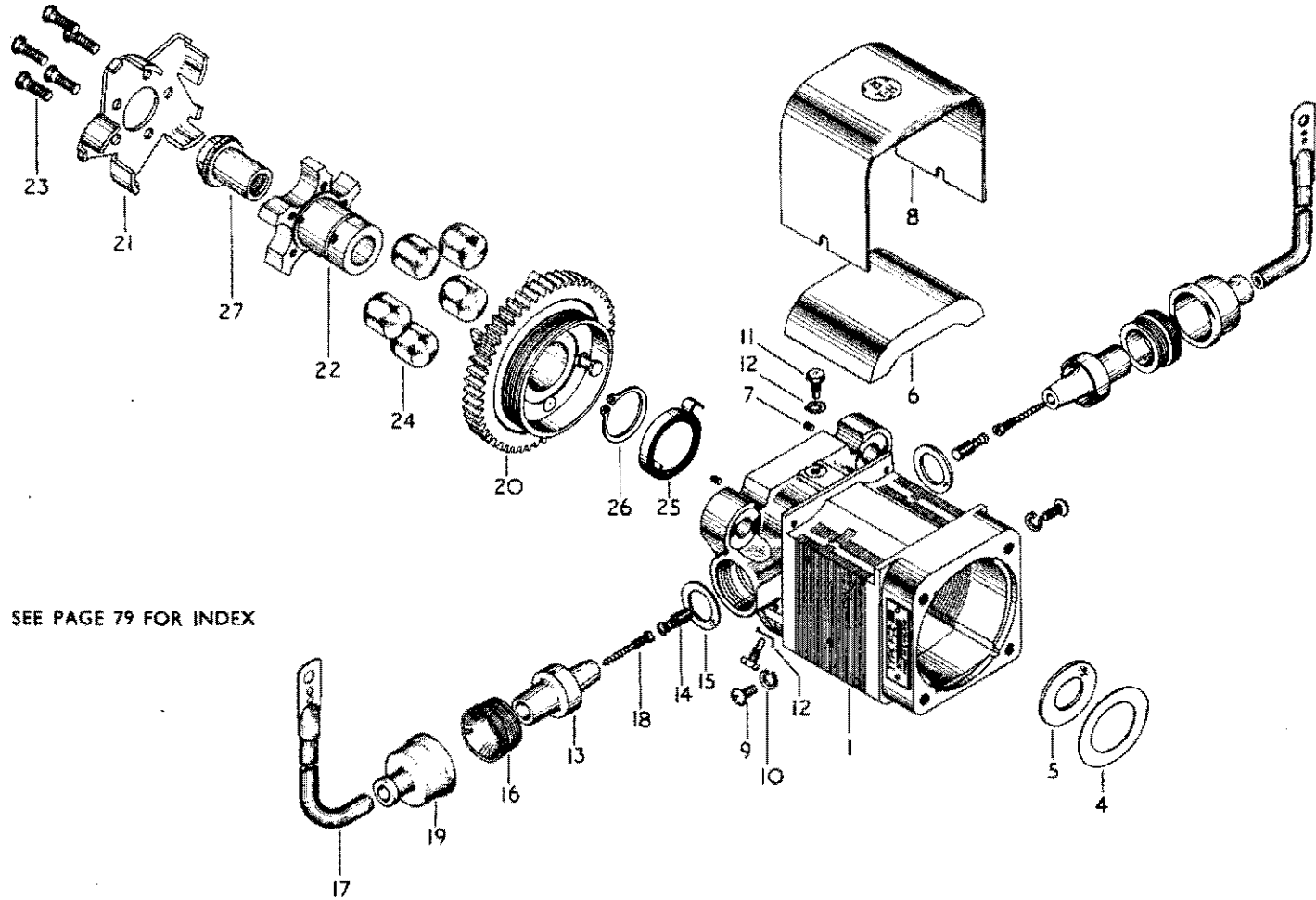

76

SEE PAGE 79 FOR INDEX

B.T.H. MAGNETO ARMATURE AND CONDENSER

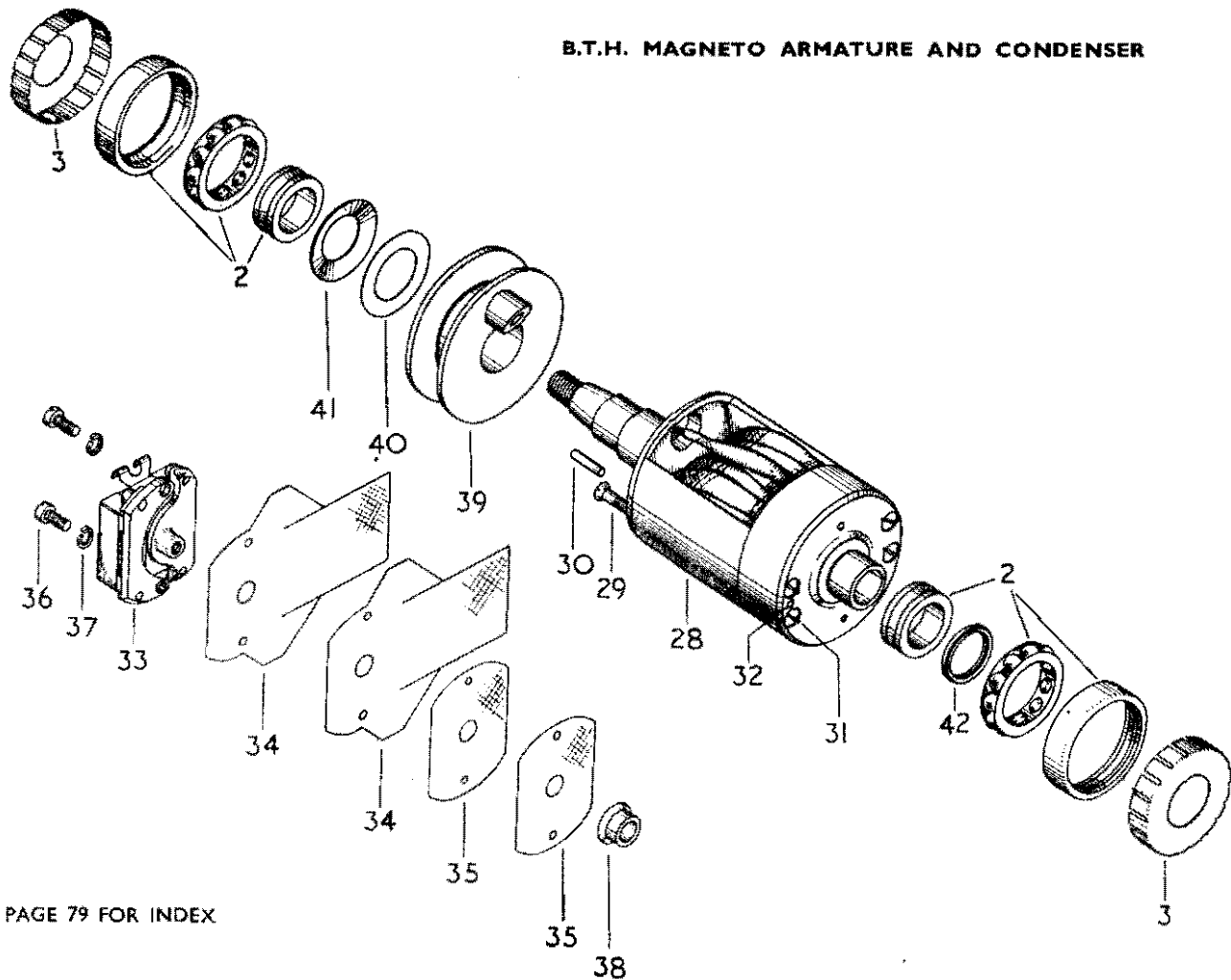

71

SEE PAGE 79 FOR INDEX

B.T.H. MAGNETO CONTACT BREAKER AND HOUSING

SEE PAGE 79 FOR INDEX

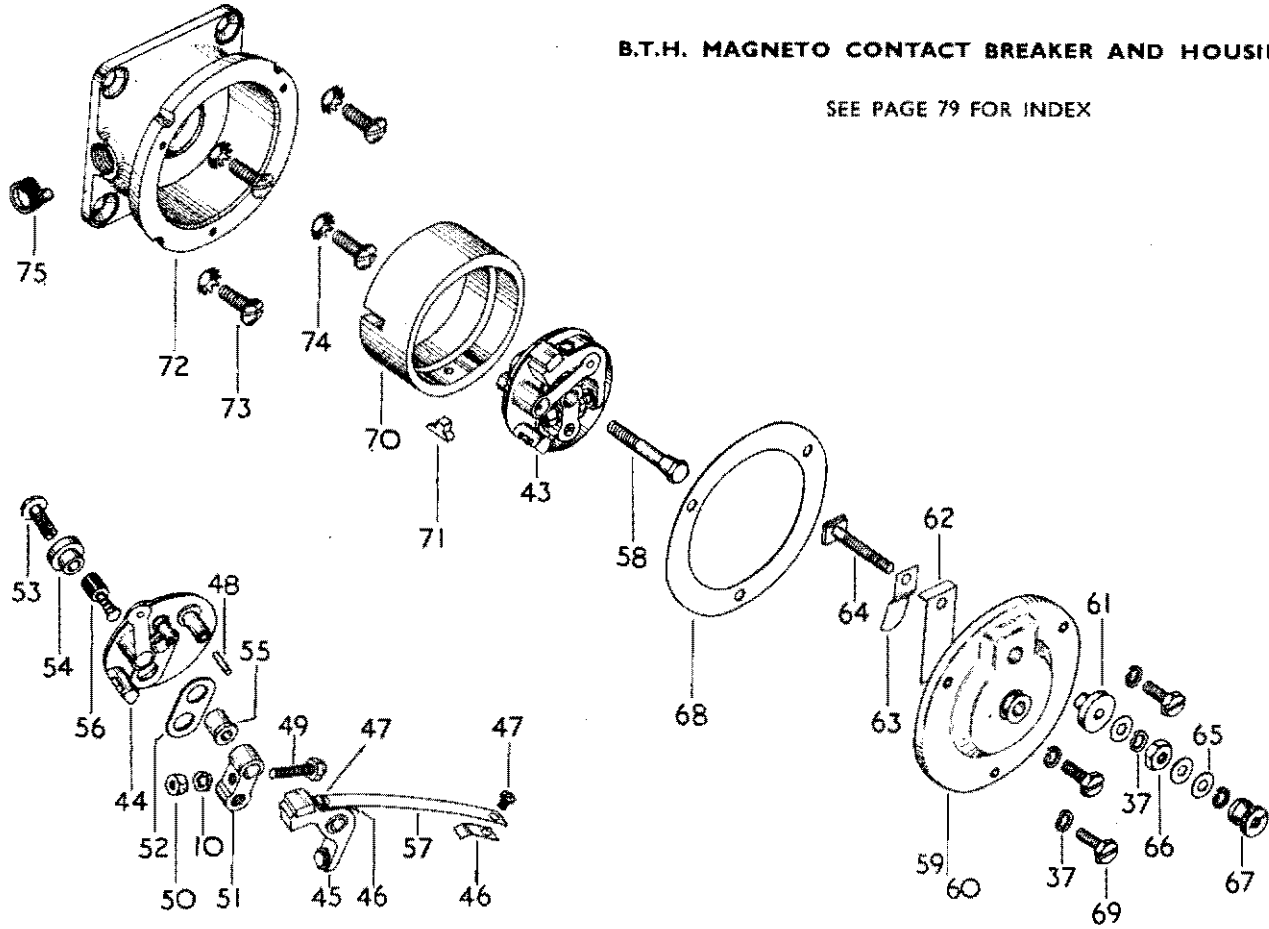

REF. No.	PART No.	DESCRIPTION	3T	ST	T100
1	SKC35711-G2	Gear, auto advance	1	1	1
2	SKC33845-1	Plate, auto advance driving	1	1	1
3	SKC33847-1	Hub, auto advance	1	1	1
4	CR35704-1	Screw, plate to hub securing	5	5	5
5	CR35706-1	Roller, auto advance	5	5	5
6	CR35707-1	Spring, auto advance main	1	1	1
7	CR35709-1	Circlip, auto advance main spring	1	1	1
8	CR35705-1	Nut, auto advance securing	1	1	1

INDEX TO ILLUSTRATIONS ON PAGES 76 TO 78

Illust. No.	Part No.	Page	Ref.	Illust. No.	Part No.	Page	Ref.
1	CZ87157-G2	74	22	38	CR20776-1	75	8
2	SKC.741-G1	74	23	39	5KC6612-G1	75	9
3	SKC6123-1	74	24	40	SKC6122-1	75	10
4	CR22186-1	74	25	41	5KC6180-1	75	11
5	CR22315-1	74	26	42	CR20774-1	75	12
6	CR23042-1	74	27	43	CX1883-G24	75	13
7	SKC6245-1	74	28	44	5KC74955-G2	75	14
8	SKC24291-1	74	29	45	CZ63472-G2	75	15
9	3BA x 5/16" RD. HD.	74	30	46	SKC6215-1	75	16
10	SKC9952-8	74	31	47	SKC6208-1	75	17
11	CR23290-1	74	32	48	CR29708-1	75	18
12	SKC6799-1	74	33	49	5KC29303-G1	75	19
13	SKC87159-G1	74	34	50	5KC6216-1	75	20
14	5KC6303-G2	74	35	51	5KC6235-1	75	22
15	CR87404-1	74	36	52	5KC6213-1	75	23
16	CR87160-1	74	37	53	5KC6209-1	75	24
17	CZ60707-G19	74	38	54	SKC6210-1	75	25
18	SKC6397-1	74	39	55	SKC6212-1	75	26
19	CR87403-1	74	41	56	SKC6219-G1	75	27
20	SKC35711-G2	79	1	57	5KC6214-1	75	28
21	SKC33845-1	79	2	58	CR29487-1	75	29
22	SKC33847-1	79	3	59	CZ61580-1	75	30
23	CR35704-1	79	4	60	SKC28537	75	31
24	CR35706-1	79	5	61	CR89533-1	75	32
25	CR35707-1	79	6	62	CR29456-1	75	33
26	CR35709-1	79	7	63	CR29455-1	75	34
27	CR35705-1	79	8	64	CR29459-1	75	35
28	CY50495-G1	74	42	65	4BA Std.	75	36
29	5KC6115-1	74	43	66	CR26513	75	38
30	SKC6111-1	74	44	67	CR89927-1	75	39
31	SKC6114-1	75	1	68	CR28540-1	75	41
32	SKC6112-1	75	2	69	CR28571-1	75	42
33	CYS2078-G3	75	3	70	5KC33650	75	44
34	5KC6636-1	75	4	71	SKC6344-1	75	45
35	SKC6637-1	75	5	72	SKC28544-G3	75	46
36	4BA x 5/16" CH. HD.	75	6	73	2BA x 1/2" inst.HD.	75	47
37	SKC9952-6	75	7	74	SKC88939-20	75	48
				75	CR26381-1	75	49

FOR IDENTIFICATION OF PARTS SEE PAGE 6 FOR INSTRUCTIONS

LUCAS ELECTRICAL EQUIPMENT GROUP

REF. No.	PART No.	DESCRIPTION	3T	5T	T100
DYNAMO (TYPE E3H RD ANTI-CLOCK)					
1	200,03A	Dynamo, complete	1	1	1
2	200,572	Armature assembly	1	1	1
3	200,270	Commutator end c/w bush	1	1	1
4	200,231	Bush, commutator end	1	1	1
5	200,354	Cover, commutator end	1	1	1
6	200,607	Bracket assembly, driving end	1	1	1
7	189,307	Ball-race, driving end	1	1	1
8	200,641	Seal, end plate with oil	1	1	1
9	200,609	Band, cover assembly	1	1	1
10	188,818	Nipple, cable fixing	2	2	2
11	200,598	Plate, clamp	1	1	1
12	115,850	Screw, clamp plate fixing	1	1	1
13	200,227	Bolt, through fixing	2	2	2
14	165,078	Nut, " " bolt	2	2	2
15	188,330	Washer, " " "	2	2	2
16	188320	Washer, shakeproof	2	2	2
17	200,290	Brush set	1	1	1
18	200,079	Spring set, bush	1	1	1
19	189,386	Key, Woodruff	1	1	1
20	E2451	Pinion, dynamo	1	1	1
21	111,700	Screw, " pinion	1	1	1
22	188,378	Washer, " " screw	1	1	1
23	E2228	Nut (dome), dynamo to gearcase	1	1	1
24	E2414	Stud, dynamo fixing	1	1	1
25	E2226	Washer, " to crankcase joint	1	1	1
26	E2230	Strap, " fixing	1	1	1
27	460055	Swivel, " strap	2	2	2
28	112450	Screw, " " "	2	2	2
CUT-OUT AND REGULATOR UNIT					
29	33053A	Regulator, complete	1	1	1
30	390,380	Cover, cut-out	1	1	1
31	390,461	Clip, cover spring	1	1	1
32	390,386	Strap, regulator fixing	1	1	1
HEAD LAMP (D42CPR) (1st CONDITION)					
33	515,470	Shell headlamp	1	1	1
34	112,201	Screw, fixing headlamp	2	2	2
35	137,141	Washer, screw fixing	2	2	2
36	516,218	Rim only	1	1	1
37	516,199	Glass, fluted	1	1	1
38	516,047	Clasp, rim assembly	1	1	1
39	516,145	Reflector, c/w joint head, and fixing wires	1	1	1

For Headlamp complete order as 2nd Condition please, Headlamp Spares are not interchangeable.

ALWAYS QUOTE PART NUMBER

REF. No.	PART No.	DESCRIPTION	3T	5T	T100
1	516,190	Wires, reflector fixing	4	4	4
2	508736	Joint bead, reflector	1	1	1
3	515,191	Back shell assembly c/w main and pilot bulb holders ...	1	1	1
4	516197	Fixing wire, back shell	1	1	1
5	S04,801	Holder, main bulb	1	1	1
6	551,807	Clip and screw, main bulb holder	1	1	1
7	200	Bulb, pilot	1	1	1
8	70	Bulb, main	1	1	1
HEAD LAMP (M42CPR) (2nd CONDITION)					
9	055461	Headlamp	1	1	1
10	516278	Shell, headlamp	1	1	1
11	112301	Screw, lamp fixing	2	2	2
12	137141	Washer, lamp fixing	2	2	2
13	509487	Rim only	1	1	1
14	550875	Glass	1	1	1
15	553089	Reflector assembly	1	1	1
16	553065	Bead, rubber joint	1	1	1
17	500291	Wire, glass fixing	4	4	4
18	509936	Catch assembly, rim	1	1	1
19	504801	Holder assembly, main bulb	1	1	1
20	551807	Clip and screw, bulb holder	1	1	1
21	552258	Screw, bulb holder clip	1	1	1
22	500181	Interior, pilot bulb	1	1	1
23	188156	Nipple, cable fixing	1	1	1
TAIL LAMP					
24	530,09A	Tail lamp MT110	1	1	1
25	526,111	Base assembly, less bulb	1	1	1
26	526,112	Body assembly, with glass	1	1	1
27	200	Bulb	1	1	1
28	571,395	Connector	1	1	1
29	106,460	Screw, tail lamp	1	1	1
30	165,334	Nut, tail lamp screw	1	1	1
CABLE HARNESS					
31	982,221	Cable harness assembly	1	1	1
32	990,521 dynamo to regulator	1	1	1
33	858,022 regulator, horn and cut-out button ...	1	1	1
INSTRUMENT PANEL					
34	F2091	Panel, instrument, MC8390, I	1	1	1
35	F2577	Screw, instrument panel fixing	1	1	1
36	F2445	Beading, instrument panel rubber	1	1	1
37	351,552	Switch, lighting	1	1	1
38	351,567	Lever, switch, with screw	1	1	1
39	062,219A	Lamp, instrument panel inspection	1	1	1
40	360,00A	Ammeter	1	1	1
41	F2472	Oil gauge	1	1	1
42	200	Bulb panel lamp	1	1	1

SEE SPECIMEN ORDER IN PREFACE

HEADLAMP—2nd CONDITION

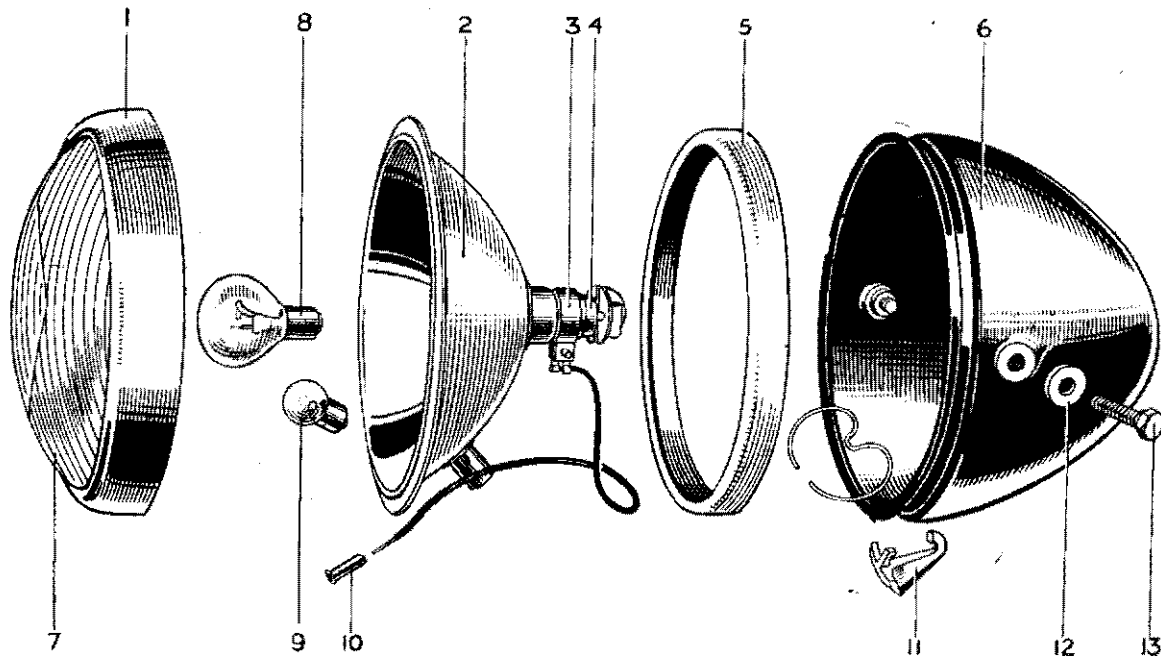

INDEX

Illust. No.	Part No.	Page	Ref.	Illust. No.	Part No.	Page	Ref.
1	509,487	81	13	8	70	81	8
2	553,089	81	15	9	200	81	7
3	551,807	81	20	10	188,156	81	23
4	504,801	81	19	11	509,936	81	18
5	553,065	81	16	12	137,141	81	12
6	516,278	81	10	13	112,301	81	11
7	550,875	81	14				

REF. No.	PART No.	DESCRIPTION	3T	5T	T100
DIMMER SWITCH					
1	380,057	Switch, dimmer	1	1	1
BATTERY					
2	PUW7E/4	Battery, 6 volt (dry)	1	1	1
3	S2263/4	Plug vent, c w washer	3	3	3
HORN					
4	701,404	Horn, Altette, HF1235	1	1	1
5	762,080	Push, horn button, 4A CP	1	1	1
6	W76	Nut, horn fixing	1	1	1
7	S26-1	Washer, horn fixing	1	1	1
CUT-OUT BUTTON					
8	762,080	Push, cut-out button, 4A CP	1	1	1
MAGNETO (LUCAS TYPE K2F-RO)					
9	42111B	Magneto c/w auto advance	1	1	1
10	458333	Armature assembly	1	1	1
11	455361	Slip ring	1	1	1
12	189291	Bearing (C.B.E. and D.E.)	2	2	2
13	458339	Condenser assembly	1	1	1
14	458619	Cover, contact breaker	1	1	1
15	470534	Contact breaker assembly	1	1	1
16	122160	Screw, contact breaker fixing	1	1	1
17	470609	Contact breaker set	1	1	1
18	470688	Spring set	1	1	1
19	470537	Brush and spring, C.B. earth	1	1	1
20	458613	Spring pillar, C.B. cover securing	1	1	1
21	100020	Screw, C.B. end plate fixing	1	1	1
22	185037	Washer, " " " "	1	1	1
23	458355	" " " " shim	1	1	1
24	458356	" " " "	1	1	1
25	458389	Cam assembly	1	1	1
26	458633	End plate assembly	1	1	1
27	465129	Cup, bearing, insulating	2	2	2
28	455191	Brush, spring and holder (magneto earth)	1	1	1
29	455190	Brush and spring	1	1	1
30	458370	Spring pin, pick up fixing	2	2	2
31	458375	Seal, rubber oil	1	1	1
32	458644	Pick up with brush and spring (LH)	1	1	1
33	458643	" " " " " " (RH)	1	1	1
34	451260	Brush and spring, pick up	2	2	2
35	47502A	Auto advance unit	1	1	1
36	498157	Spring, auto advance	2	2	2
37	415116	Spanner and point gauge	1	1	1
38	E2415	Clip, H.T. lead	1	1	1

WHEN IN DOUBT SEND SAMPLE

GASKET SETS

Including all necessary Gaskets for decarbonising and front fork drain and pressure valve screw washers. Cylinder head and primary chaincase Gaskets are supplied separately.

GS350T/46	Gasket Set for 3T (1946/7)
GS350T/48	" " " 3T (1948)
GS5T/46	" " " 5T
GST100/46	" " " T100

GEAR RATIOS

Engine Sprocket	STANDARD RATIO				WIDE RATIO			
	Top	3rd	2nd	1st	Top	3rd	2nd	1st
17	6.46	7.75	11.35	16.40	6.46	9.36	14.83	19.82
18	6.10	7.33	10.50	15.50	6.10	8.84	14.00	18.70
19	5.80	6.95	10.0	14.70	5.80	8.40	13.30	17.80
20	5.50	6.60	9.5	14.0	5.50	7.96	12.62	16.88
21	5.24	6.28	9.05	13.3	5.24	7.60	12.02	16.08
22	5.00	6.0	8.65	12.7	5.00	7.25	11.48	15.34
23	4.78	5.75	8.26	12.1	4.78	6.93	11.00	14.70
24	4.57	5.49	8.03	11.6	4.57	6.63	10.49	14.03
25	4.40	5.28	7.73	11.0	4.40	6.38	10.12	13.51

CLOSE RATIO

Engine Sprocket	Top	3rd	2nd	1st
17	6.46	7.08	9.32	11.20
18	6.10	6.68	8.78	10.58
19	5.80	6.35	8.35	10.08
20	5.50	6.025	7.92	9.54
21	5.24	5.74	7.55	9.08
22	5.00	5.48	7.20	8.67
23	4.78	5.24	6.88	8.26
24	4.57	5.01	6.58	7.93
25	4.40	4.82	6.34	7.63

PARTS REQUIRED TO CONVERT

FROM STANDARD TO WIDE RATIO	FROM WIDE TO STANDARD RATIO
T465 ... Mainshaft High Gear	T726 ... Mainshaft High Gear
T467 ... " 2nd "	T727 ... " 2nd "
T466 ... Layshaft High "	T434 ... Layshaft High "
T468 ... " 2nd "	T436 ... " 2nd "

FOR CLOSE RATIO GEARS SEE PAGES 7 AND 36

COPY OF GUARANTEE GIVEN TO TRIUMPH DEALERS

WE give the following guarantee with our motor cycles, motor cycle combinations and sidecars including all accessories and component parts other than tyres, saddles, chains and lighting and electrical equipment, and other than accessories and component parts supplied to the order of the Purchaser and differing from those comprised in the standard specifications supplied with our motor cycles, motor cycle combinations and sidecars, but including accessories and parts supplied by way of exchange as hereinafter provided. This guarantee is given in place of any implied conditions or warranties or any liabilities whatsoever statutory or otherwise; no guarantee except that hereinafter contained and no conditions or warranty whatsoever statutory or otherwise is given or is to be implied, nor are we to be under any liability whatsoever except under the guarantee hereinafter contained. Any statement, description, condition or representation contained in any catalogue, advertisement, leaflet or other publication shall not be construed as enlarging, varying or overriding anything herein contained. In the case of machines (a) which have been used for "hiring out" purposes or (b) any motor cycle and/or sidecar used for any dirt tracks, cinder track or grass track racing or competitions (or any competition of any kind within an enclosure for which a charge is made for admission to take part in or view the competition) or (c) machines from which the trade mark, name or manufacturing number has been altered or removed or (d) any machines in which parts have been used not supplied by or approved by the motor cycle manufacturer, or (e) any machine from which the silencing system as fitted by the manufacturer has been partially or wholly removed or interfered with, no guarantee, condition or warranty of any kind statutory or otherwise is given or is to be implied nor are we to be under any liability whatsoever in respect of any such machine.

We guarantee, subject to the conditions mentioned below, that all precautions which are usual and reasonable have been taken by us to secure excellence of materials and workmanship, but this guarantee is to extend and be in force for six months only from date of purchase, or date of exchange in case of any accessory or part supplied by way of exchange as hereinafter provided, and damages for which we make ourselves responsible under this guarantee are limited to the free repair of or supply of a new part or accessory in exchange for the part of the motor cycle, motor cycle combination or side car or accessory which may have proved defective. We undertake, subject to the conditions mentioned below, to make good in manner aforesaid any part or accessory covered by this guarantee which has proved defective within the said period of six months. We do not undertake to replace or refix, or bear the cost of replacing or refixing any such new part or accessory in the motor cycle, motor cycle combination or sidecar. As motor cycles, motor cycle combinations and sidecars are easily liable to derangement by neglect or misuse, this guarantee does not apply to defects caused by wear and tear, misuse or neglect.

The term "misuse" shall include amongst others the following acts :—

1. The attaching of a sidecar to a motor cycle in such a manner as to cause damage or calculated to render the latter unsafe when ridden.
2. The use of a motor cycle or of a motor cycle and sidecar combined, when carrying more persons or a greater weight than that for which the machine was designed by the manufacturers.
3. The attaching of a sidecar to a motor cycle by any form of attachment not provided, supplied, or approved by the manufacturers, or to a motor-cycle which is not designed for such use.

We do not guarantee tyres, saddles, chains or lighting and electrical equipment, or any accessories or component parts supplied to the order of the Purchaser differing from those comprised in the standard specifications supplied with our motor cycles, motor cycle combinations or sidecars. As regards all such tyres, saddles, chains, lighting and electrical equipment, accessories and component parts, no guarantee, condition or warranty of any kind statutory or otherwise is given or is to be implied, and we are to be under no liability whatsoever in respect thereof.

CONDITIONS OF GUARANTEE

If a defective part or accessory should be found in our motor cycles, motor cycle combinations or sidecars, or in any part or accessory supplied by way of exchange as before provided, it must be sent to us CARRIAGE PAID, and accompanied by an intimation from the owner that he desires to have it repaired or exchanged free of charge under our guarantee and he must also furnish us at the same time with the frame number of the machine, the date of purchase or the date when the alleged defective part or accessory was exchanged as the case may be.

Failing compliance with the above, such articles will lie here at THE RISK OF THE OWNER, and this guarantee and any implied guarantee, warranty or condition shall not be enforceable.

REPAIRS

Any motor cycle, motor cycle combination or sidecar sent to us to be plated, enamelled or repaired will be repaired upon the following conditions, i.e., we guarantee that all precautions which are usual and reasonable have been taken by us to secure excellence of materials and workmanship, such guarantee to extend and be in force for three months only from the time such work shall have been executed, and this guarantee is in lieu and in exclusion of all conditions and warranties statutory or otherwise and all liabilities whatsoever and the damages recoverable are limited to the cost of any further work which may be necessary to amend and make good the work found to be defective.

NOTICE

We do not appoint agents for the sale on our behalf of our motor cycles or other goods, but we assign to motor cycle Dealers areas in which we supply to such Dealers exclusively for re-sale in such areas. No such Dealer is authorised to transact any business, give any warranty, make any representation or incur any liability on our behalf.

TRIUMPH ENGINEERING CO. LTD.

Meriden Works, Allesley
COVENTRY, ENGLAND

NOTES
